

PLANS AND DOCUMENTS  
referred to in the PDA APPROVAL

07 JUN 2016

MEDQ

## remora road hamilton

landscape report [D] 2016-04-21





Prepared for:  
**Shahyer group**  
Prepared by:  
RPS Australia East  
Suite 18, Level 2 Central Brunswick,  
455 Brunswick Street,  
Fortitude Valley QLD 4006, Australia  
Telephone: +61 7 3124 9300 Facsimile: +61 7 3124 9399  
[www.rpsgroup.com.au](http://www.rpsgroup.com.au)  
ABN 81 591 046 588

**RPS**

© RPS 2015

The information contained in this document produced by RPS is solely for the use of **Shahyer group** Limited for the purpose for which it has been prepared and RPS undertakes no duty to or accepts any responsibility to any third party who may rely upon this document.

All rights reserved. No section or element of this document may be removed from this document, reproduced, electronically stored or transmitted in any form without the written permission of RPS.



# 0.0<sub>contents</sub>

## site understanding

1.0 context

## design visioning

2.0 vision statement

2.1 landscape drivers

2.2 landscape character

## design proposal

3.1 site plan

3.2 ground plan

3.3 sections and elevations

3.4 planting

3.5 materials



# 1.0

## site understanding | context

Flowering Poinciana trees line the streets against a backdrop of charming old homes and provide an idyllic setting for sophistication and fun. Racecourse Rd is the spine of the area, and is home to fine restaurants, chic cafes and boutiques. On race days, it is a promenade for the fashion-conscious and traditional racegoers. Towards the river, Portside Wharf Cruise Terminal sits among trendy riverside apartments, and boasts modern, world-class restaurants serving gourmet delights, designer fashion, weekend markets and an art-house cinema. "visit brisbane"

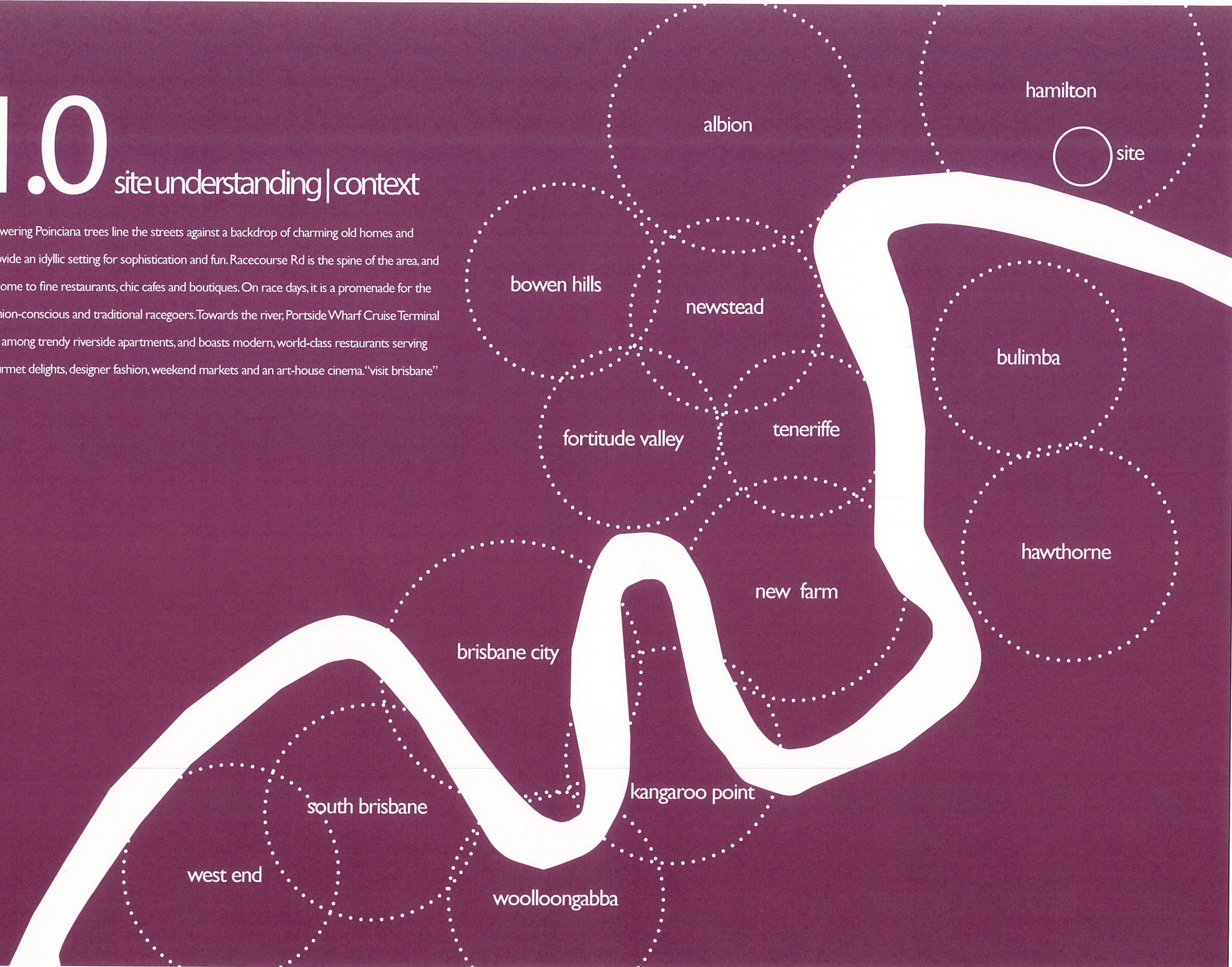



# 1.1

## site understanding | local context

The Remora Road development sits within the North Shore Hamilton Sub Precinct 3a. The site has close proximity to recreational areas such as Remora Park and the Brisbane River while also having a close connection to food and dining such as Portside and Eat Street Markets.

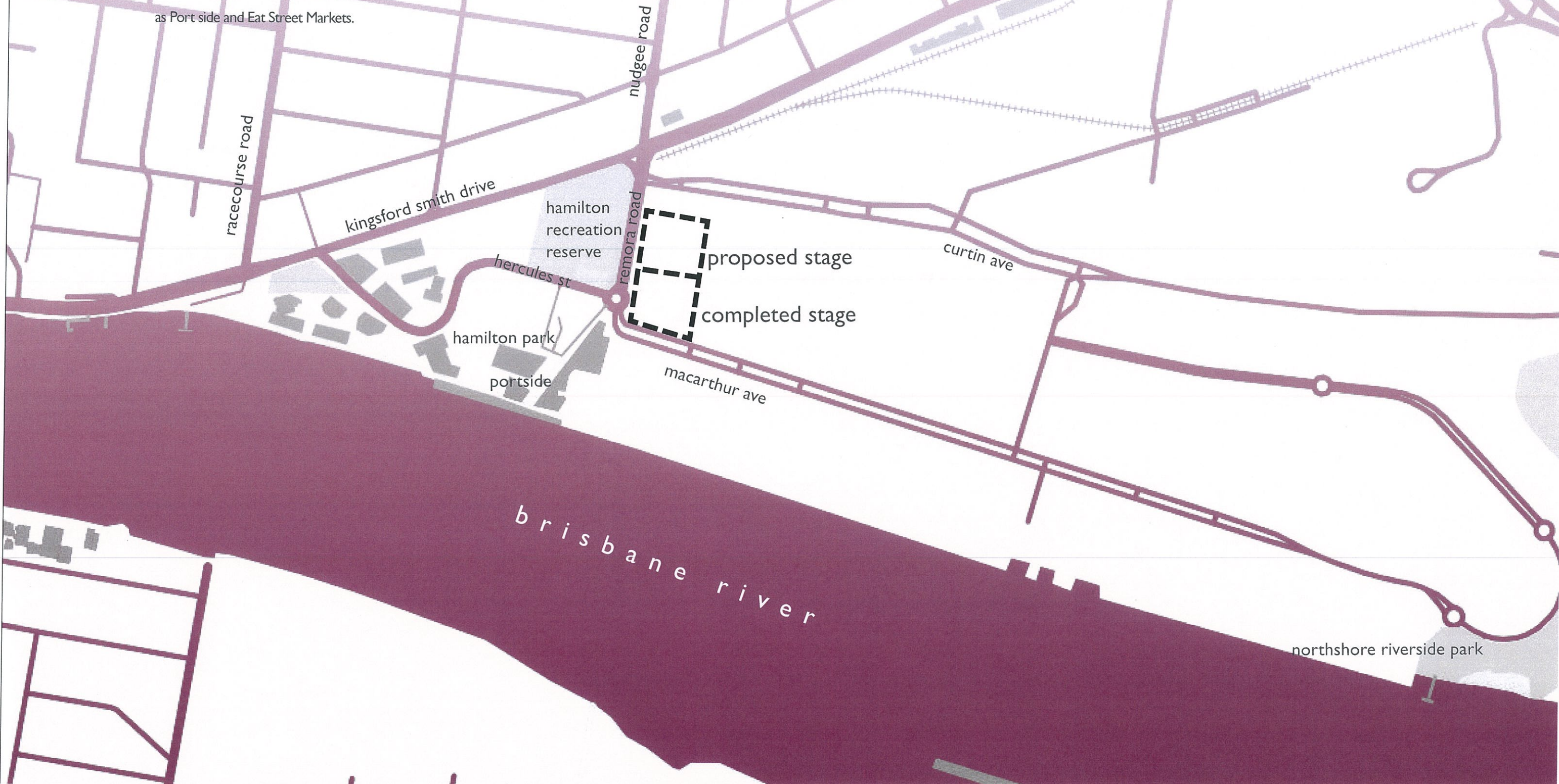





# 2.0

design visioning vision statement

Remora Stage 2 delivers a retreat from the harsh surrounding urban environment, a refuge that invites a slower pace of life to inner city living. The urban oasis will foster a finer grain social interaction to contrast the busy, fast paced interactions of daily city life.

A central shared courtyard space with verdant and soft backdrop emphasise a residential living sanctuary within the hard surroundings of city buildings and busy streets which lack green open space.



# 2.1 design visioning | drivers

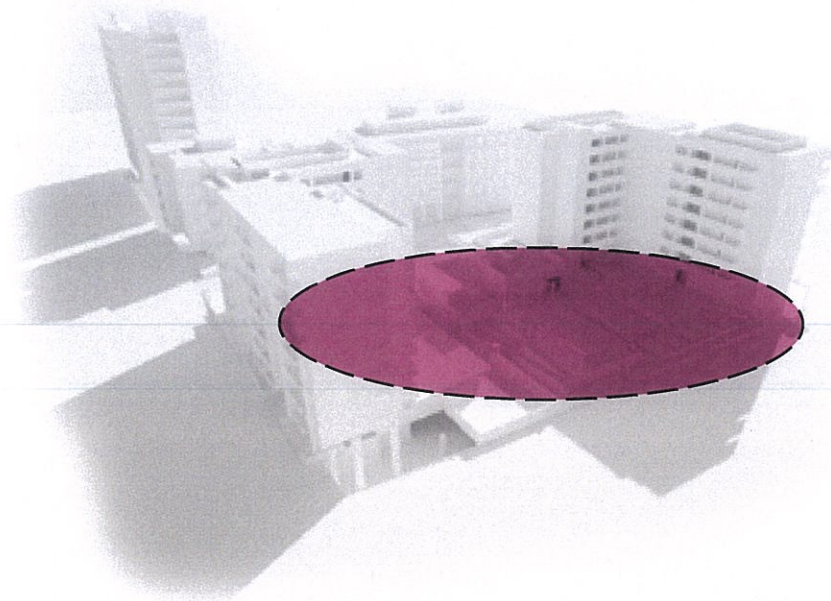

verdant retreat

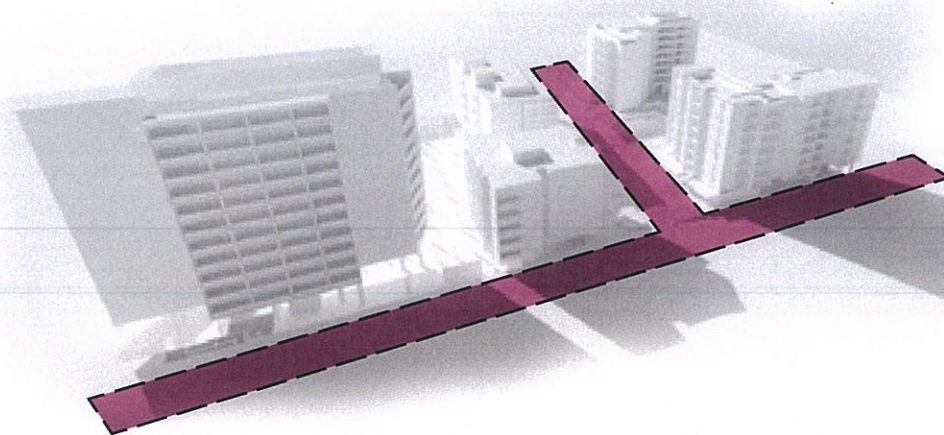

lush streetscape

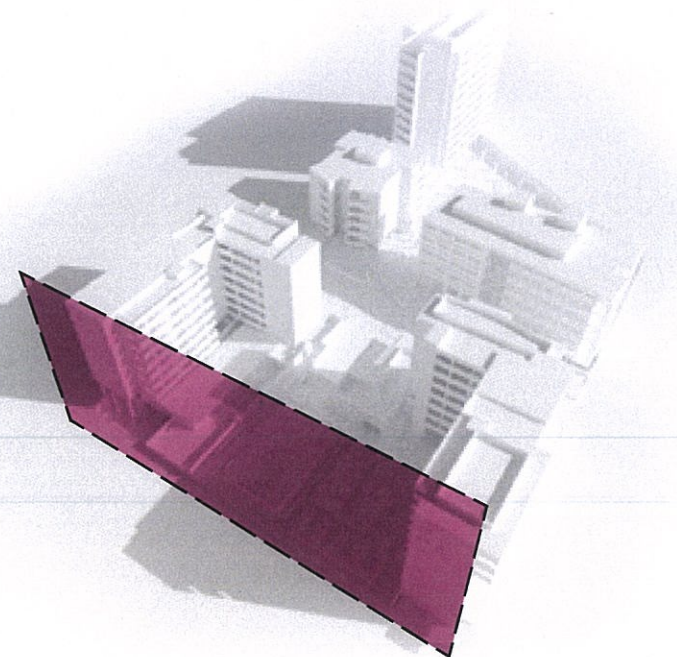

tropical interface



# 3.0 design proposal | site plan 1:500 @ a3





# 3.1

design proposal | networks 1:500 @ a3

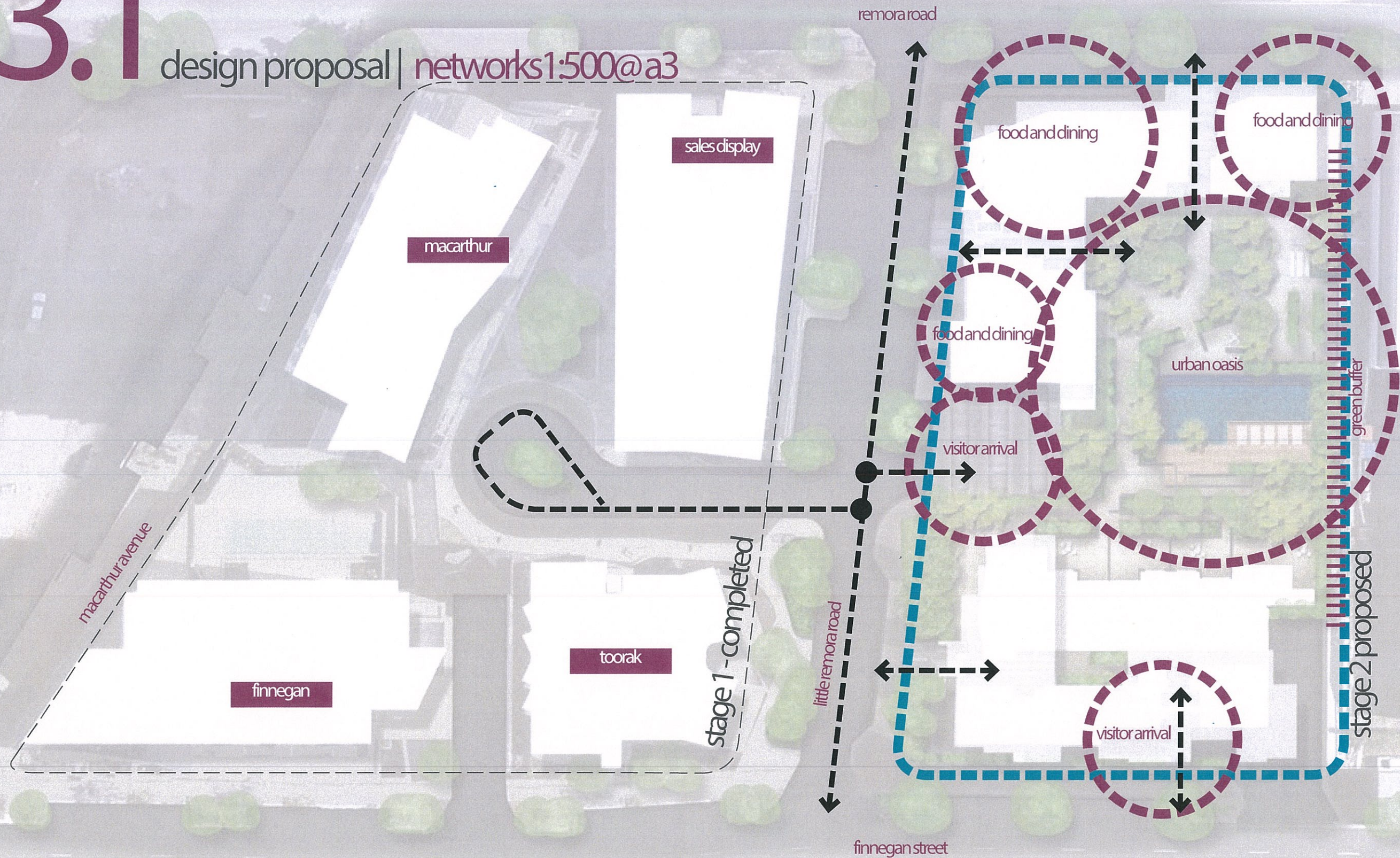



# 32

design proposal detail plan 1:200 @ a3

1. 20m infinity lap pool
2. podium planting - 600mm high
3. central arbour
4. kitchen and dining
5. seating and lounge rooms
6. streetscape dining
7. existing trees to be retained
8. streetscape to be retained as existing
9. community garden planters

- P1 insitu concrete 'pewter'
- P2 insitu concrete 'liquorice'
- P3 granite 'mulga' vehicular
- P4 granite paver to lobby
- P5 unit pavers to commons
- P6 timber decking

little remora road





- ① 20m infinity lap pool
  - ② podium planting - 600mm high
  - ③ central arbour
  - ④ seating and lounge rooms
  - ⑤ BBQ and dining
  - ⑥ pool deck
  - ⑦ existing trees to be retained
  - ⑧ streetscape to be retained as existing
  - ⑨ kitchen garden and community plots
  - ⑩ central green
- P1 insitu concrete 'pewter'
  - P2 insitu concrete 'liquorice'
  - P3 granite 'mulga' vehicular
  - P4 granite paver to lobby
  - P5 unit pavers to commons
  - P6 timber decking

little remora road





# 3.3 design proposal | sections and elevations 1:200@a3

## section 1





## section 2

- 1. 20m infinity lap pool
- 2. podium planting - 600mm high
- 3. kitchen and dining
- 4. seating and lounge rooms
- 5. private terrace
- 6. pool deck & pool fence
- 7. Building behind





# 3.4 design proposal | planting

Incorporating the native streetscape palette, the streetscape will extend within the development, grounding the development within the urban context. Soft landscaping volume, within the development, that compliments the built massing, will be achieved through the incorporation of vegetation layering. The layering of foliage, texture, colour and form will provide a depth and lushness to the planting areas.

trees



Waterhousia floribunda



harpullia pendula



Elaeocarpus eumundi



podocarpus elatus



Cyathea cooperi



Syzygium cascade

shrubs



Blechnum indica



Heliconia pendula



Monstera delicosa



Strelitzia nicolai



Cordyline petiolaris



Doryanthes palmeri



Alpinia mutica



Rhapis excelsa

groundcovers



Philodendron scandens



Pyrostegia venusta



Syngonium podophyllum



Cissus antarctica



Dianella caerulea



Philodendron xanadu



Liriope evergreen



# 3.5

design proposal | materials strategy



insut concrete seating

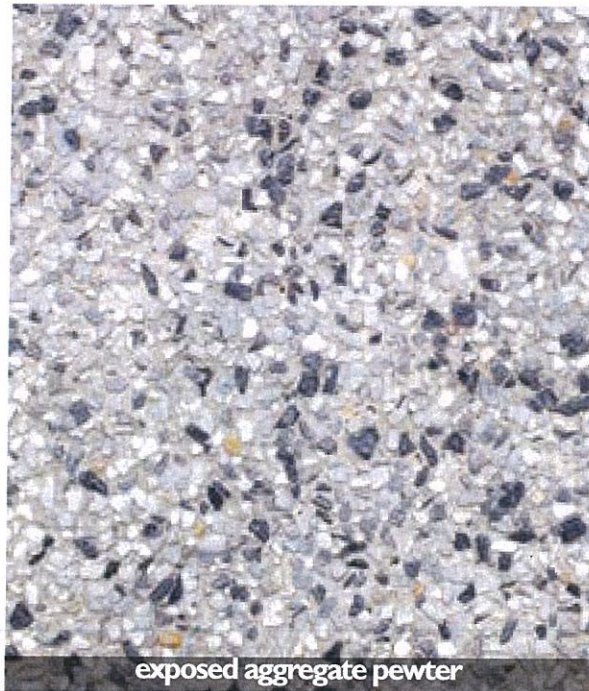

exposed aggregate pewter



granite pavers to lobby

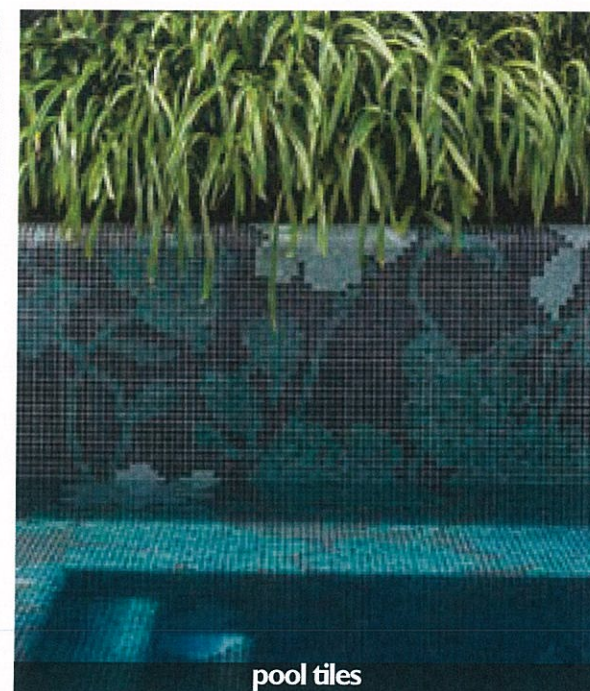

pool tiles

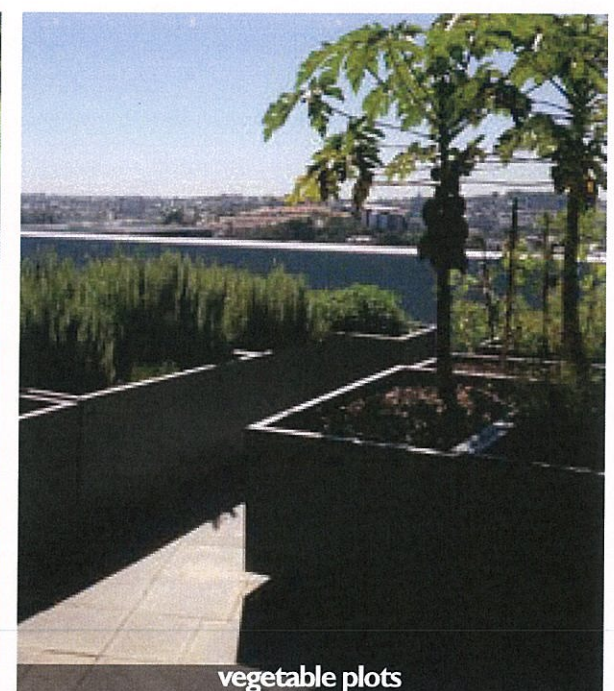

vegetable plots



planter walls

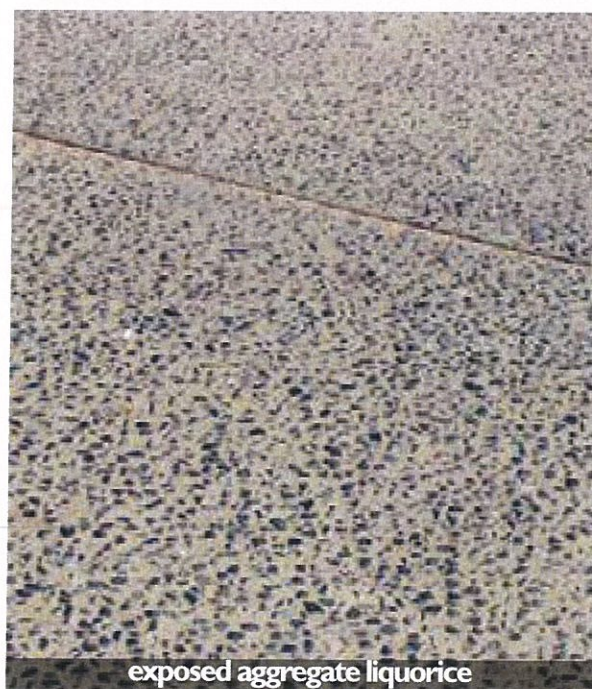

exposed aggregate liquorice

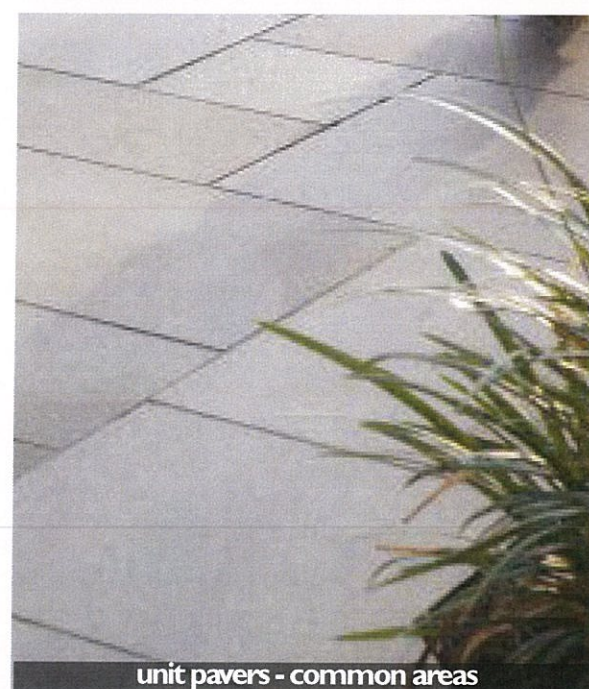

unit pavers - common areas



turf

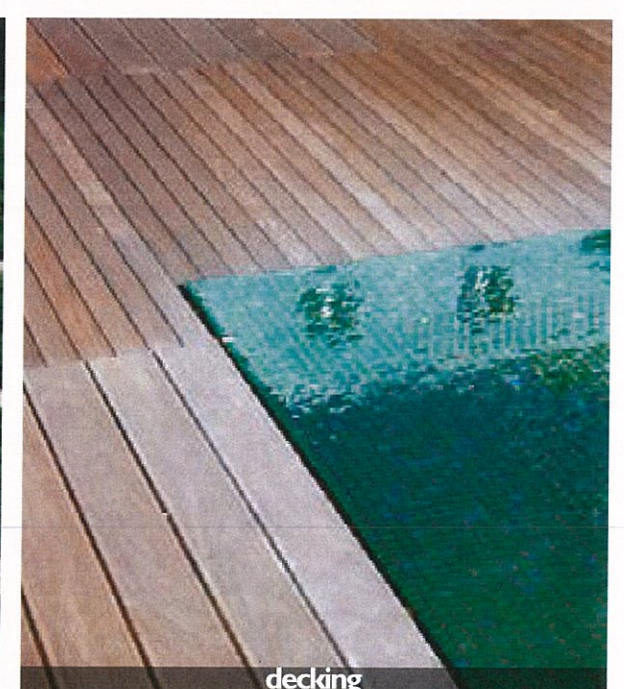

decking



RPS