

PRELIMINARY

Final intended use of new Lots & Easements:

Lot 500 - is for Stage 2.

Easement 16 - is for Right of Way for Access & Services - burdening Lot 500, benefiting Lot 11

PLANS AND DOCUMENTS
referred to in the PDA
DEVELOPMENT APPROVAL

Approval no: DEV2021/1221

Date: 2 September 2025

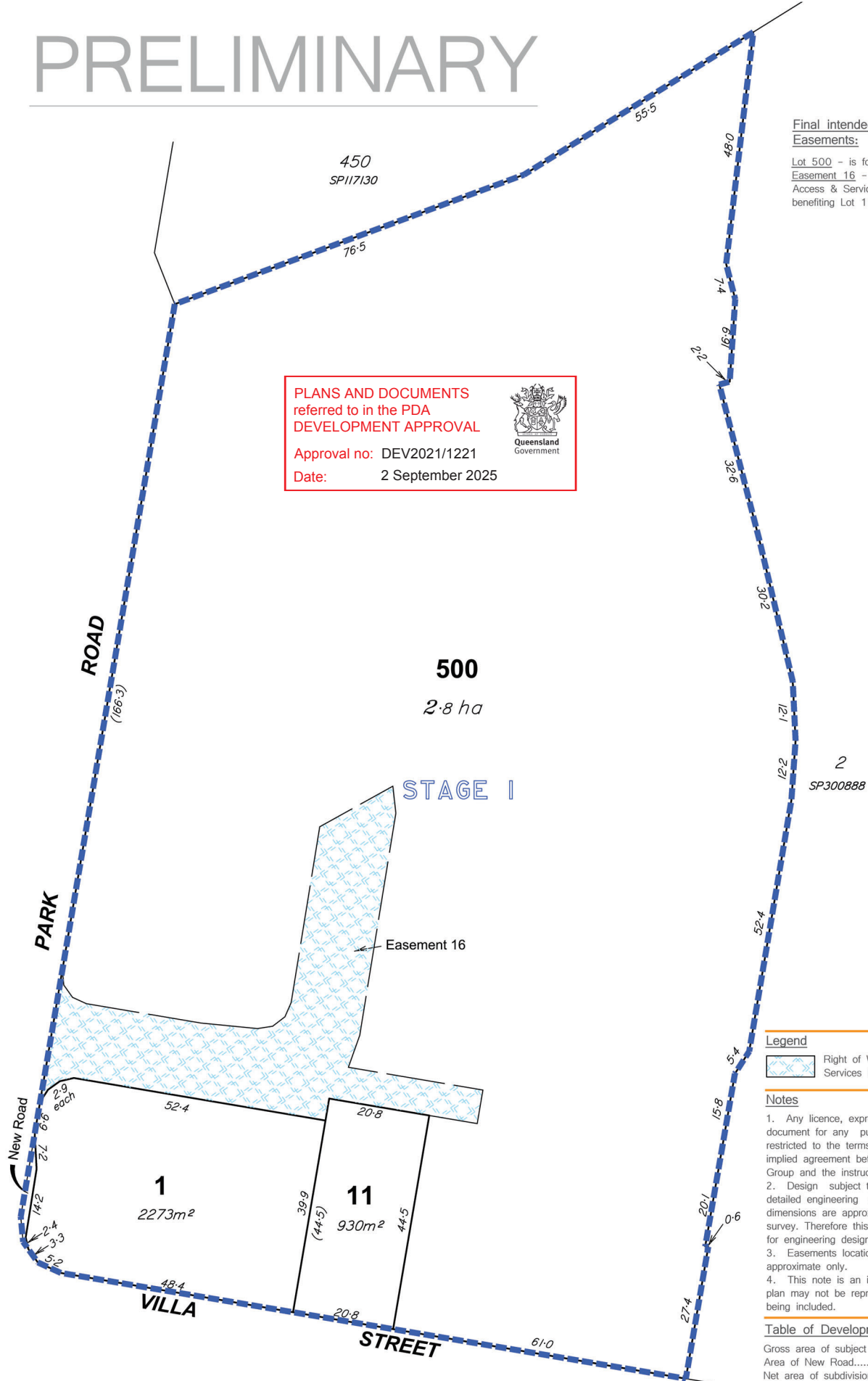
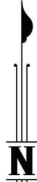

Legend

Right of Way for Access & Services Easements

Notes

1. Any licence, express or implied, to use this document for any purpose whatsoever is restricted to the terms of the agreement or implied agreement between Wolter Consulting Group and the instructing party.
2. Design subject to local authority approval & detailed engineering requirements, areas and dimensions are approximate only and are subject to survey. Therefore this drawing is not to be used for engineering design.
3. Easements locations from others and are approximate only.
4. This note is an integral part of this plan. This plan may not be reproduced without this notation being included.

Table of Development

Gross area of subject land.....	3.123 ha
Area of New Road.....	28 m²
Net area of subdivision.....	3.12 ha
Number of proposed lots.....	3
Number of existing lots.....	1

PRELIMINARY

