

# LUMINA OPEN SPACE

## ARCHITECTURE

### 100% DESIGN DEVELOPMENT ISSUE

DRAWING SCHEDULE - ARCHITECTURE	
SHEET NUMBER	SHEET NAME
A-0000	COVER SHEET
A-1000	TRELLIS - PLANS
A-2000	TRELLIS - ELEVATIONS & SECTIONS
A-2001	TRELLIS - LOUVRE SECTIONS
A-2002	TRELLIS - LOUVRE SCHEDULE
A-3000	TRELLIS - DETAILS - SHEET 1
A-3001	TRELLIS - DETAILS - SHEET 2
A-3002	TRELLIS - DETAILS - SHEET 3



ARTIST IMPRESSION

NOT FOR CONSTRUCTION



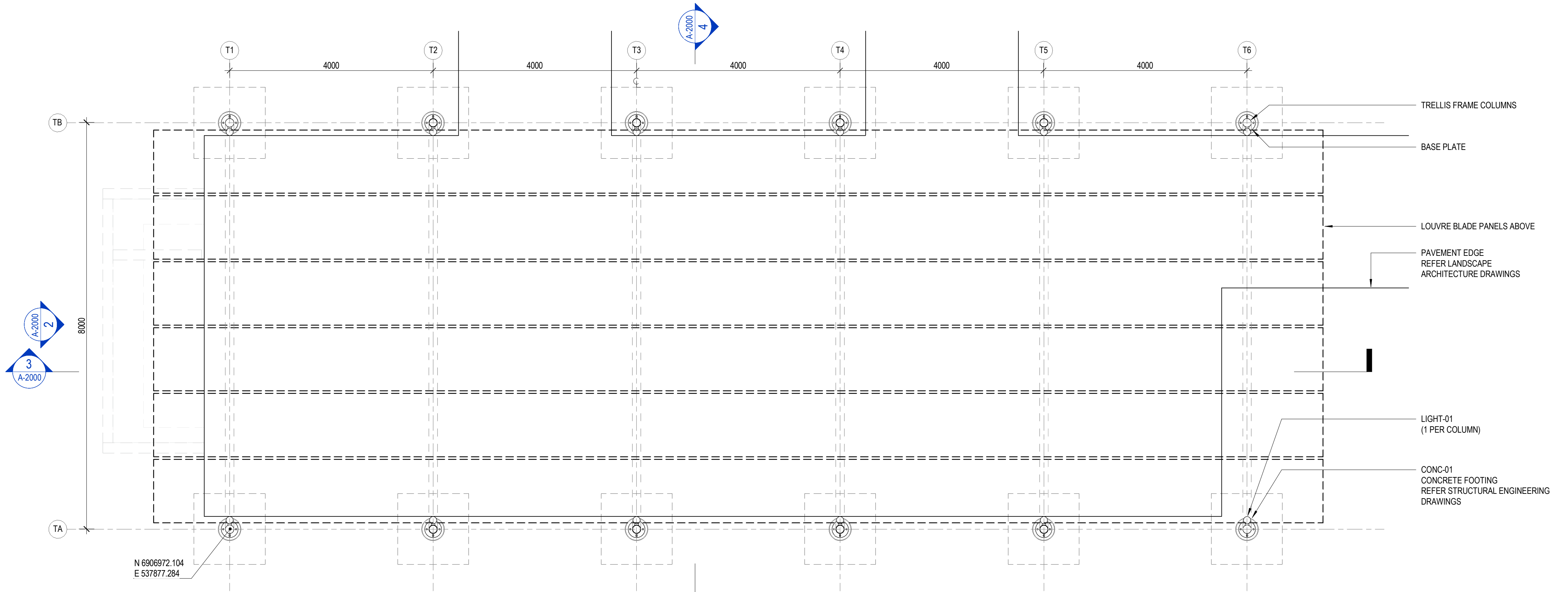

1 TRELLIS - PLAN  
SK101 1:50

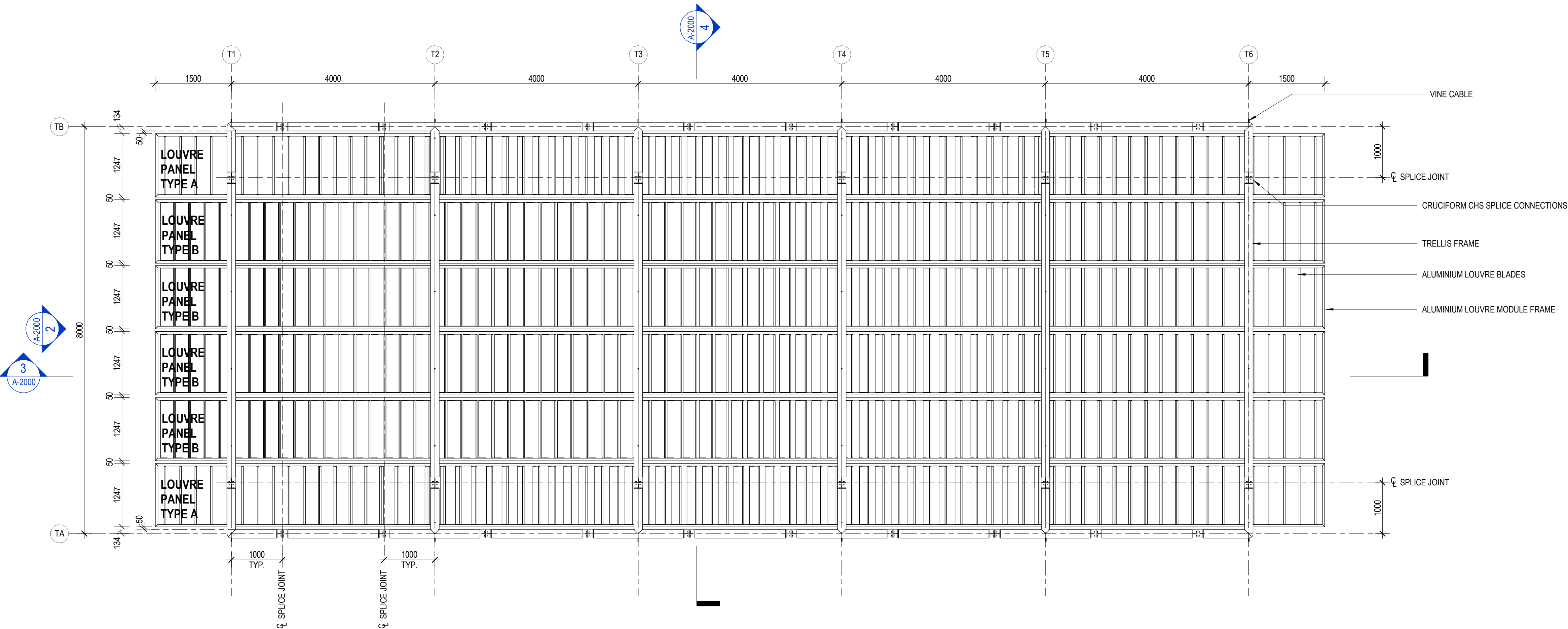

2 TRELLIS - ROOF PLAN  
1:50

**NOTE:**

- ALL FIXINGS TO BE GRADE 316 STAINLESS STEEL UNLESS NOTED OTHERWISE
- ALL WELDS TO BE CONTINUOUS AND GROUND SMOOTH
- ALL METALWORK TO BE FABRICATED AND PROTECTIVE COATED OFF SITE

**FINISHES SCHEDULE & DESCRIPTION OF ELEMENTS**

ITEM	SUPPLIER	FINISH
PAINTED LOUVRE PANELS - INCLUDING FRAME, BLADES, SPACER PLATES AND ALL VISIBLE	DULUX	MATERIAL: ALUMINIUM SYSTEM: - FINISH: POWDER COAT DULUX DURALLOY RAPIDCURE - THICKNESS: TO ENGINEER'S SPECIFICATION (VARIES) - COLOUR: DULUX STABILITY S20D2  ADDITIONAL INFORMATION: - COAT ALL FIXINGS TO COLOUR MATCH LOUVRES - PROVIDE COMPLETE LOUVRE PANEL SYSTEM INCLUDING FIXINGS, DISSIMILAR METAL SEPARATORS, SPACERS, JOINING & STIFFENING PLATES - LOUVRES VARY IN DIMENSION. ASSUME ALL MAXIMUM DIMENSION FOR PRICING. ACTUAL DIMENSION TO BE DOCUMENTED IN IFC SET - PROVIDE NOMINAL 3mm SPACINGS BETWEEN FRAME ELEMENTS - ALL CORNER JOINTS TO BE MITRED - CONTRACTOR TO ALLOW FOR BUILDING TOLERANCE - CONTRACTOR TO ALLOW FOR INCORPORATION OF METHODOLOGY FOR INSTALLATION & MAINTENANCE - ALL FIXINGS TO BE AS DRAWN AND NOT VISIBLE UNLESS SHOWN IN THIS SET - PROVIDE DRAINAGE HOLES IN MEMBERS IF WATER INGRESS IS POSSIBLE - PAINT SYSTEM TO BE APPLIED TO MANUFACTURERS SPECIFICATION INCLUDING BASE MATERIAL CLEANING, PREPARATION & APPLICATION - ALL MATERIALS TO BE PROTECTED FOR TRANSPORT & INSTALLATION - SITE PAINTING OTHER THAN TOUCH UP WILL NOT BE PERMITTED - PROVIDE 1m LENGTH OF LOUVRE PANEL INCLUDING END AS SAMPLE MOCKUP FOR APPROVAL PRIOR TO FULL FABRICATION
PAINTED TRELLIS FRAME TO ENGINEER'S SPECIFICATION	DULUX	MATERIAL: MILD STEEL SYSTEM: QUANTUM V90 PROTECTIVE COASTING SYSTEM - 1ST COAT ZINCANODE 402 - 2ND COAT DUREMAX GPE MIO QUICKTURN - 3RD COAT QUANTUM V90 FINISH: CLEAR STAIN COLOUR: DULUX STABILITY S20D2 ADDITIONAL INFORMATION: - COAT ALL FIXINGS TO COLOUR MATCH FRAME - INSTALL TO MANUFACTURERS SPEC.
VINE CABLE	RONSTAN	MATERIAL: STAINLESS STEEL
LIGHT 01		REFER ELECTRICAL ENGINEER'S DRAWINGS
CONC 01		CLASS 02 VISIBLE CONCRETE FOOTINGS TO STRUCTURAL ENGINEER'S DRAWINGS

NOT FOR CONSTRUCTION



CONSULTANT

**Hassell**

Hassell LTD ABN 24 007 711 435  
Level 2, Factory 1 West Village  
45 Mollison Street West End  
Brisbane QLD 4101 Australia  
T +61 7 3914 4000  
F +61 7 3914 4100  
brisbane@hassellstudio.com

REFERENCE

NORTH

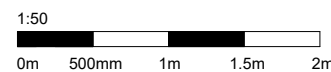
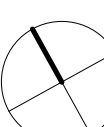

NOTES

1. Do not scale drawing. Written dimensions govern
  2. All dimensions are in millimeters unless noted otherwise
  3. All dimensions shall be verified on site before proceeding with the work. Hassell shall be notified in writing of any discrepancies.
  4. This drawing must be read in conjunction with all relevant contracts, specifications and drawings
- This drawing is an uncontrolled copy. Unless noted otherwise  
© Copyright of this drawing is vested in Hassell Ltd.

REV DESCRIPTION

A	50% DD CO-ORDINATION ISSUE
B	50% DD ISSUE
C	90% DD CO-ORDINATION ISSUE
D	95% DD CLIENT ISSUE
E	100% DD ISSUE

DATE

06.04.23
18.04.23
17.05.23
26.05.23
26.07.23

CLIENT

EDQ

PROJECT

LUMINA OPEN SPACE

STATUS

DESIGN DEVELOPMENT

DRAWING TITLE

TRELLIS - PLANS

REVIEWED

TB

APPROVED

DK

DRAWING NO.

A-1000

SCALE @ A1

1 : 50

PROJECT NO.

016319

REV NO.

E

PRINT IN COLOUR

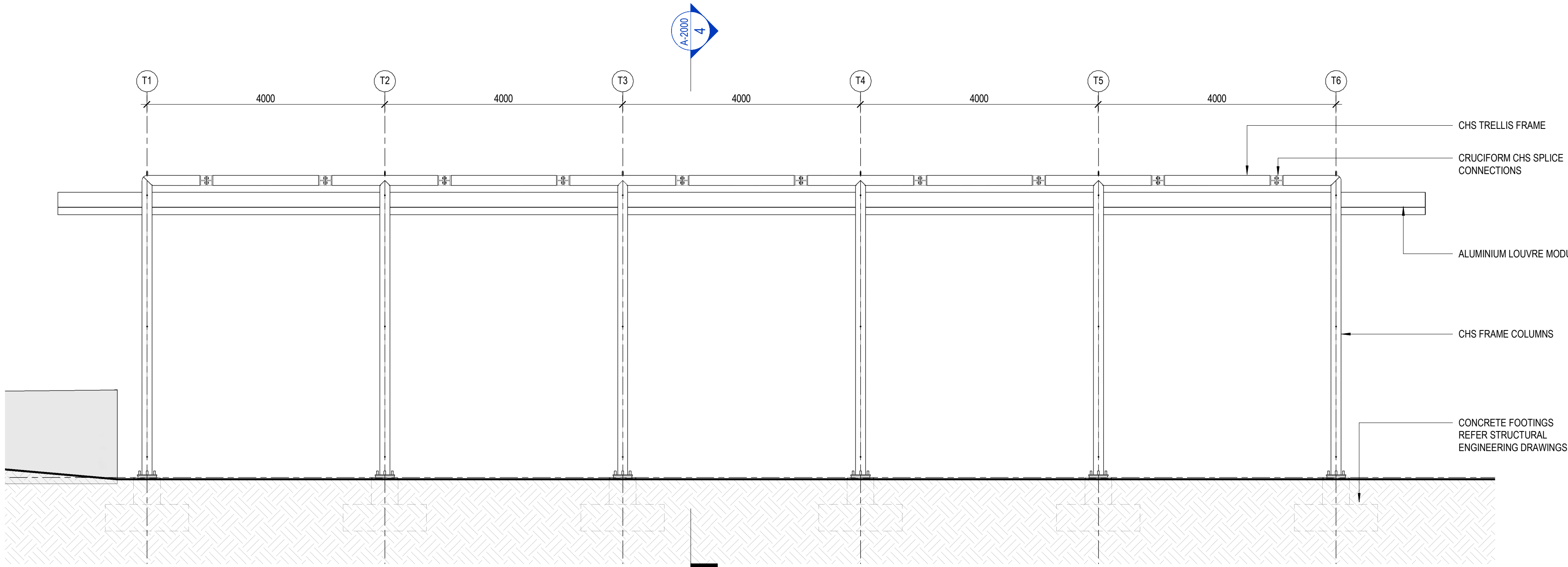

1 TRELLIS SIDE ELEVATION  
SK109 1:50

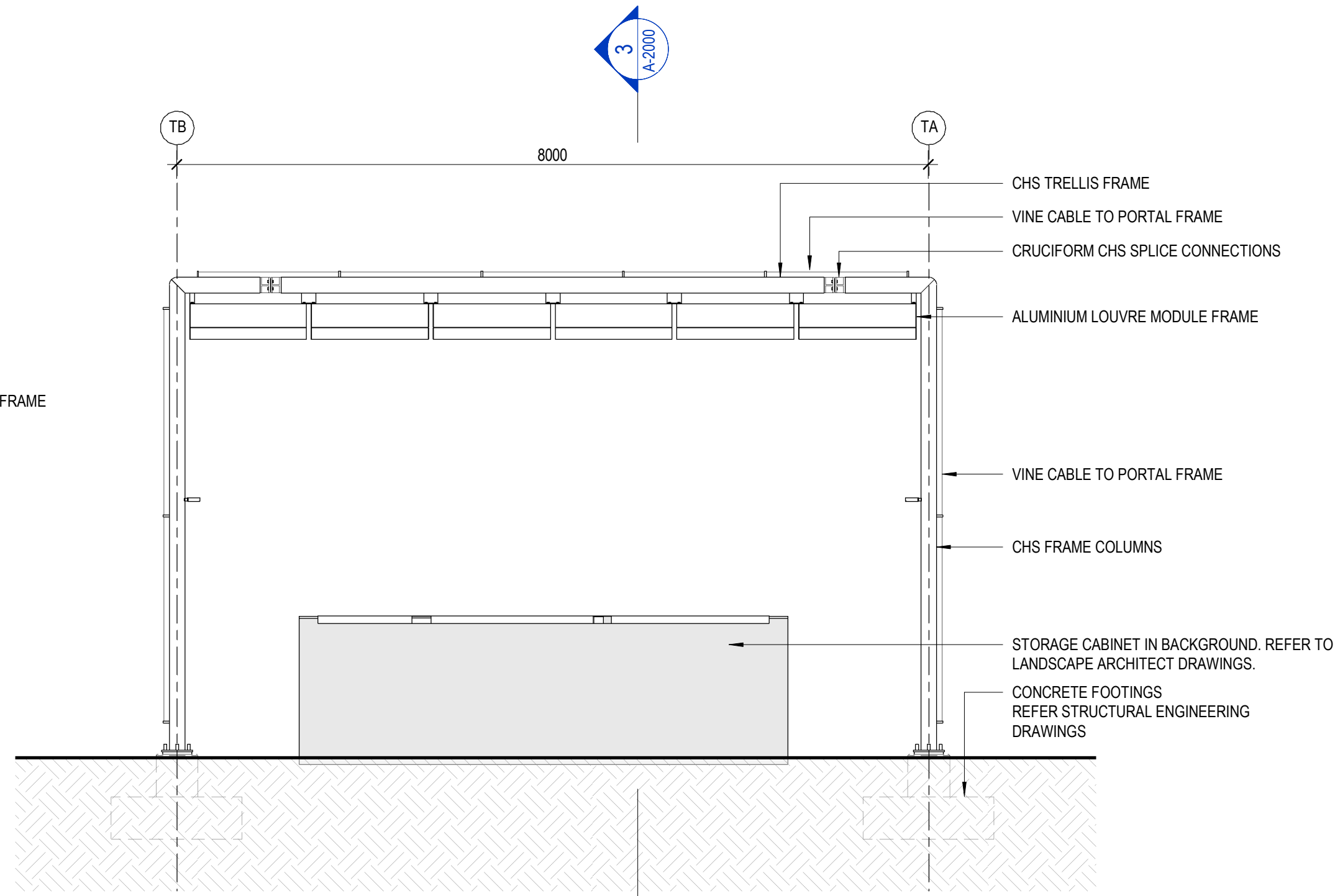

2 TRELLIS END ELEVATION  
A-1000 1:50

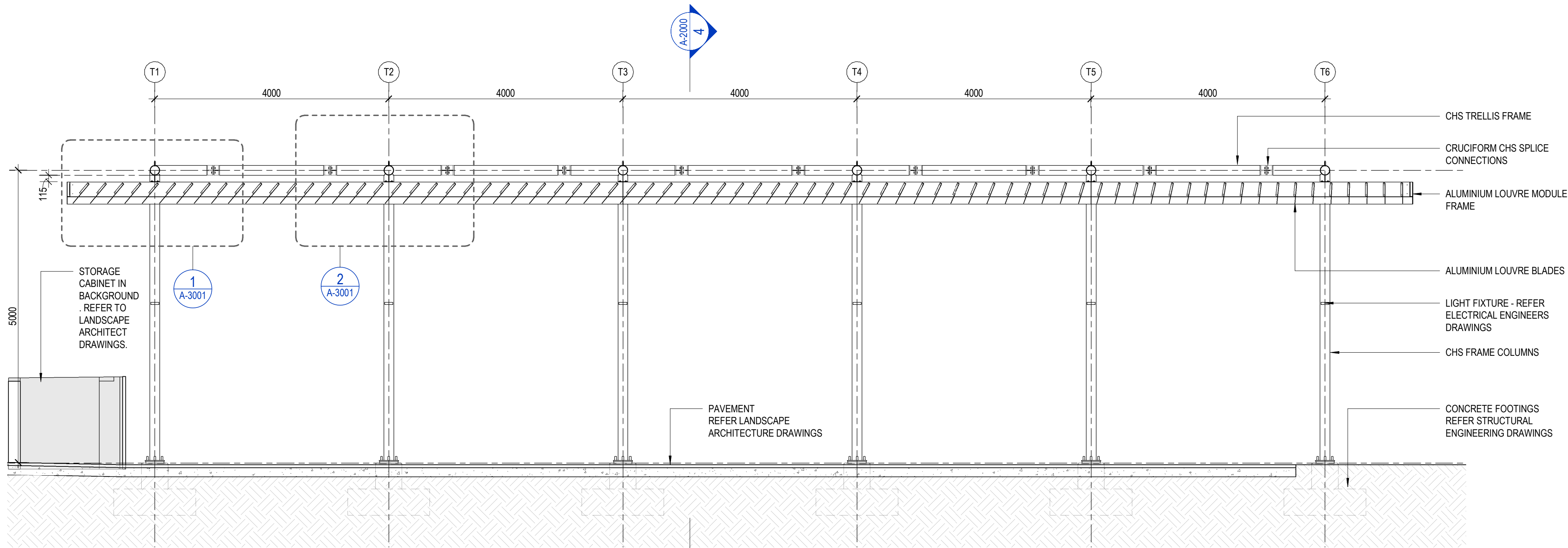

3 TRELLIS LONG SECTION  
A-1000 1:50

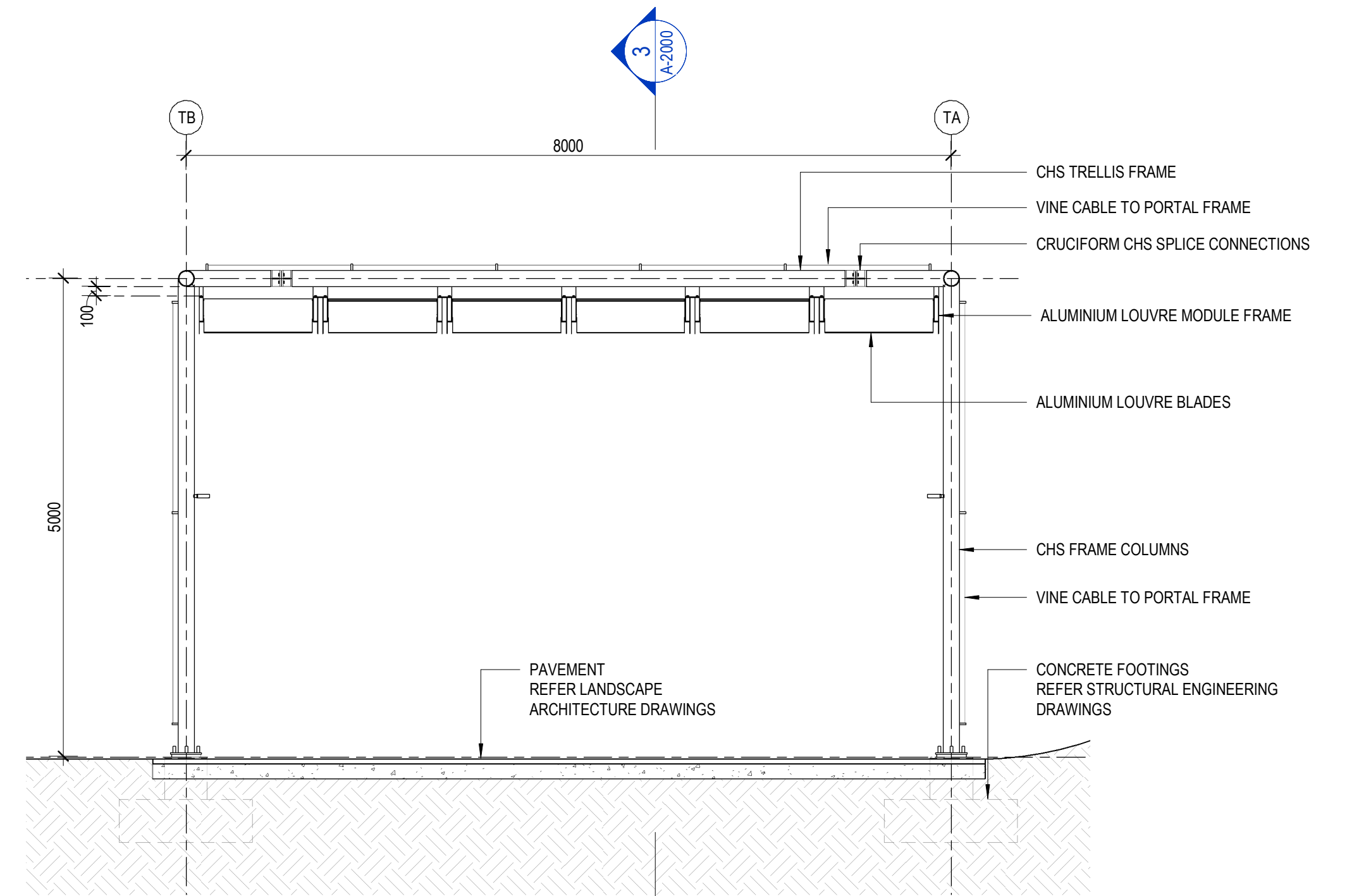

4 TRELLIS CROSS SECTION  
A-1000 1:50

NOT FOR CONSTRUCTION

H

CONSULTANT

Hassell

Hassell LTD ABN 24 007 711 435  
Level 2, Factory 1 West Village  
45 Mollison Street West End  
Brisbane QLD 4101 Australia  
T +61 7 3914 4000  
F +61 7 3914 4100  
brisbane@hassellstudio.com

REFERENCE

NORTH

NOTES

1. Do not scale drawing. Written dimensions govern
  2. All dimensions are in millimeters unless noted otherwise
  3. All dimensions shall be verified on site before proceeding with the work. Hassell shall be notified in writing of any discrepancies.
  4. This drawing must be read in conjunction with all relevant contracts, specifications and drawings
- This drawing is an uncontrolled copy. Unless noted otherwise  
© Copyright of this drawing is vested in Hassell Ltd.

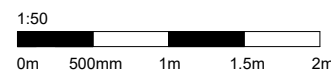

REV DESCRIPTION

A	50% DD CO-ORDINATION ISSUE
B	50% DD ISSUE
C	90% DD CO-ORDINATION ISSUE
D	95% DD CLIENT ISSUE
E	100% DD ISSUE

DATE

06.04.23
18.04.23
17.05.23
26.05.23
26.07.23

CLIENT

EDQ

PROJECT

LUMINA OPEN SPACE

STATUS

DESIGN DEVELOPMENT

DRAWING TITLE

TRELLIS - ELEVATIONS & SECTIONS

REVIEWED

TB

APPROVED

DK

DRAWING NO.

A-2000

SCALE @ A1

1:50

PROJECT NO.

016319

REV NO.

E

PRINT IN COLOUR



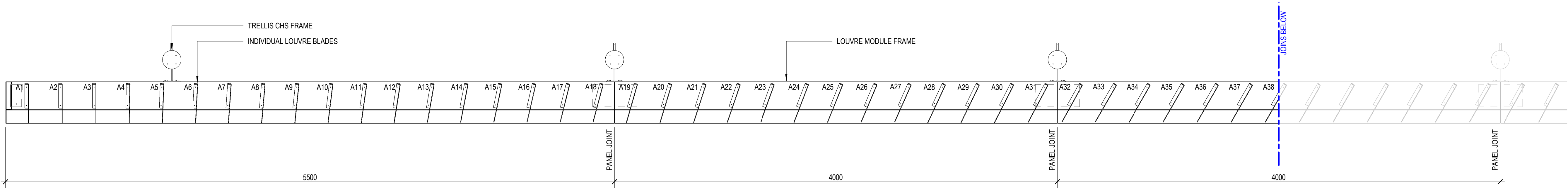

1 LOUVRE PANEL TYPE A SECTION - PART 1  
1:20

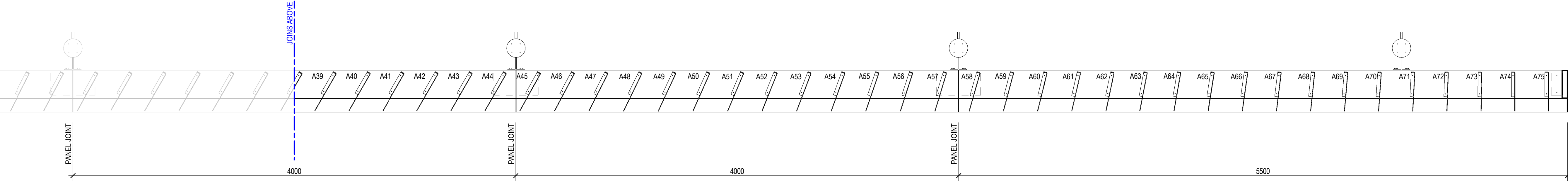

2 LOUVRE PANEL TYPE A SECTION - PART 2  
1:20

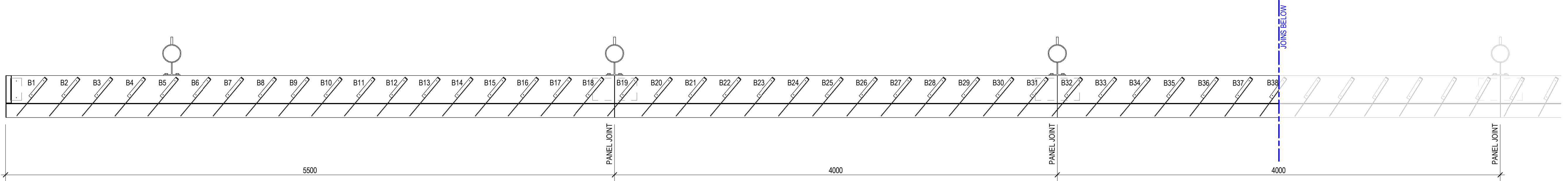

3 LOUVRE PANEL TYPE B SECTION - PART 1  
1:20

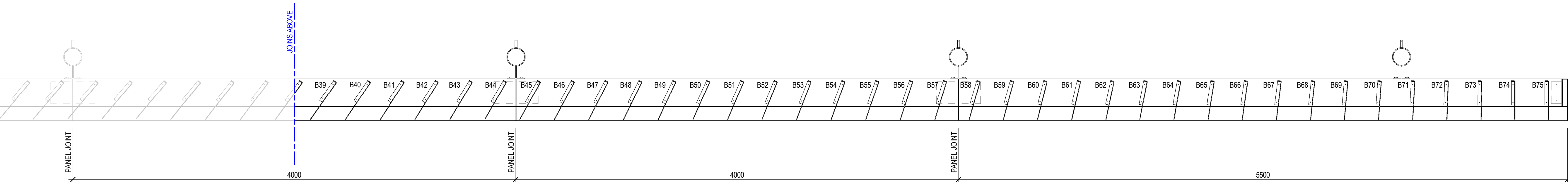

4 LOUVRE PANEL TYPE B SECTION - PART 2  
1:20

NOT FOR CONSTRUCTION

CONSULTANT

**Hassell**

Hassell LTD ABN 24 007 711 435  
Level 2, Factory 1 West Village  
45 Mollison Street West End  
Brisbane QLD 4101 Australia  
T +61 7 3914 4000  
F +61 7 3914 4100  
brisbane@hassellstudio.com

REFERENCE

NORTH

NOTES

1. Do not scale drawing. Written dimensions govern
  2. All dimensions are in millimeters unless noted otherwise
  3. All dimensions shall be verified on site before proceeding with the work. Hassell shall be notified in writing of any discrepancies.
  4. This drawing must be read in conjunction with all relevant contracts, specifications and drawings
- This drawing is an uncontrolled copy. Unless noted otherwise  
© Copyright of this drawing is vested in Hassell Ltd.

REV DESCRIPTION

A 90% DD CO-ORDINATION ISSUE  
B 95% DD CLIENT ISSUE  
C 100% DD ISSUE

DATE

17.05.23  
26.05.23  
26.07.23

CLIENT

EDQ

PROJECT

LUMINA OPEN SPACE

STATUS

DESIGN DEVELOPMENT

DRAWING TITLE

TRELLIS - LOUVRE SECTIONS

REVIEWED

TB

APPROVED

DK

DRAWING NO.

A-2001

SCALE @ A1

1:20

PROJECT NO.

016319

REV NO.

C

PRINT IN COLOUR



LOUVRE PANEL TYPE A		
LOUVRE BLADE NUMBER	LOUVRE BLADE ANGLE	LOUVRE BLADE HEIGHT
A1	90°	320
A2	90°	320
A3	90°	320
A4	89°	320
A5	88°	320
A6	87°	320
A7	86°	320
A8	85°	320
A9	84°	320
A10	83°	320
A11	82°	320
A12	81°	320
A13	80°	320
A14	79°	320
A15	78°	320
A16	77°	320
A17	76°	320
A18	75°	320
A19	74°	330
A20	73°	330
A21	72°	330
A22	71°	330
A23	70°	330
A24	69°	335
A25	68°	335
A26	67°	335
A27	66°	335
A28	65°	350
A29	64°	350
A30	63°	350
A31	62°	350
A32	61°	350
A33	60°	350
A34	60°	355
A35	60°	355
A36	60°	355
A37	60°	355
A38	60°	355
A39	60°	355
A40	60°	355
A41	60°	355
A42	60°	355
A43	60°	355
A44	60°	355
A45	61°	355
A46	62°	350
A47	63°	350
A48	64°	350
A49	65°	345
A50	66°	340
A51	67°	340
A52	68°	340
A53	69°	335
A54	70°	335
A55	71°	330
A56	72°	330
A57	73°	330
A58	74°	330
A59	75°	325
A60	76°	325
A61	77°	325
A62	78°	325
A63	79°	320
A64	80°	320
A65	81°	320
A66	82°	320
A67	83°	320
A68	84°	320
A69	85°	320
A70	86°	320
A71	87°	320
A72	88°	320
A73	89°	320
A74	90°	320
A75	90°	320

LOUVRE PANEL TYPE B		
LOUVRE BLADE NUMBER	LOUVRE BLADE ANGLE	LOUVRE BLADE HEIGHT
B1	50°	400
B2	50°	400
B3	50°	400
B4	50°	400
B5	50°	400
B6	50°	400
B7	50°	400
B8	50°	400
B9	50°	400
B10	50°	400
B11	50°	400
B12	50°	400
B13	50°	400
B14	50°	400
B15	50°	400
B16	50°	400
B17	50°	400
B18	50°	400
B19	50°	400
B20	50°	400
B21	50°	400
B22	50°	400
B23	50°	400
B24	50°	400
B25	50°	400
B26	50°	400
B27	50°	400
B28	50°	400
B29	50°	400
B30	50°	400
B31	50°	400
B32	50°	400
B33	50°	400
B34	50°	400
B35	51°	395
B36	52°	390
B37	53°	390
B38	54°	380
B39	55°	380
B40	56°	375
B41	57°	370
B42	58°	365
B43	59°	360
B44	60°	360
B45	61°	355
B46	62°	355
B47	63°	350
B48	64°	350
B49	65°	345
B50	66°	340
B51	67°	340
B52	68°	340
B53	69°	335
B54	70°	335
B55	71°	330
B56	72°	330
B57	73°	330
B58	74°	330
B59	75°	325
B60	76°	325
B61	77°	325
B62	78°	325
B63	79°	320
B64	80°	320
B65	81°	320
B66	82°	320
B67	83°	320
B68	84°	320
B69	85°	320
B70	86°	320
B71	87°	320
B72	88°	320
B73	89°	320
B74	90°	320
B75	90°	320

NOTES:

- EACH BLADE HAS A SPECIFIC ANGLE AND LENGTH AS SET OUT IN THESE TABLES
- BLADE ANGLE IS MEASURED FROM HORIZONTAL
- BLADES ARE TO BE SETOUT FROM JOINTS AND ENDS AND SPACED EQUALLY IN BETWEEN

NOT FOR CONSTRUCTION

CONSULTANT



Hassell

Hassell LTD ABN 24 007 711 435  
Level 2, Factory 1 West Village  
45 Mollison Street West End  
Brisbane QLD 4101 Australia  
T +61 7 3914 4000  
F +61 7 3914 4100  
brisbane@hassellstudio.com

REFERENCE

NORTH

NOTES

1. Do not scale drawing. Written dimensions govern
  2. All dimensions are in millimeters unless noted otherwise
  3. All dimensions shall be verified on site before proceeding with the work. Hassell shall be notified in writing of any discrepancies.
  4. This drawing must be read in conjunction with all relevant contracts, specifications and drawings
- This drawing is an uncontrolled copy. Unless noted otherwise
- © Copyright of this drawing is vested in Hassell Ltd.

REV DESCRIPTION

A 90% DD CO-ORDINATION ISSUE  
B 95% DD CLIENT ISSUE  
C 100% DD ISSUE

DATE

17.05.23  
26.05.23  
26.07.23

CLIENT

EDQ

PROJECT

LUMINA OPEN SPACE

STATUS

DESIGN DEVELOPMENT

DRAWING TITLE

TRELLIS - LOUVRE SCHEDULE

REVIEWED

TB

SCALE @ A1

1 : 50

APPROVED

DK

PROJECT NO.

016319

DRAWING NO.

A-2002

REV NO.

C

PRINT IN COLOUR



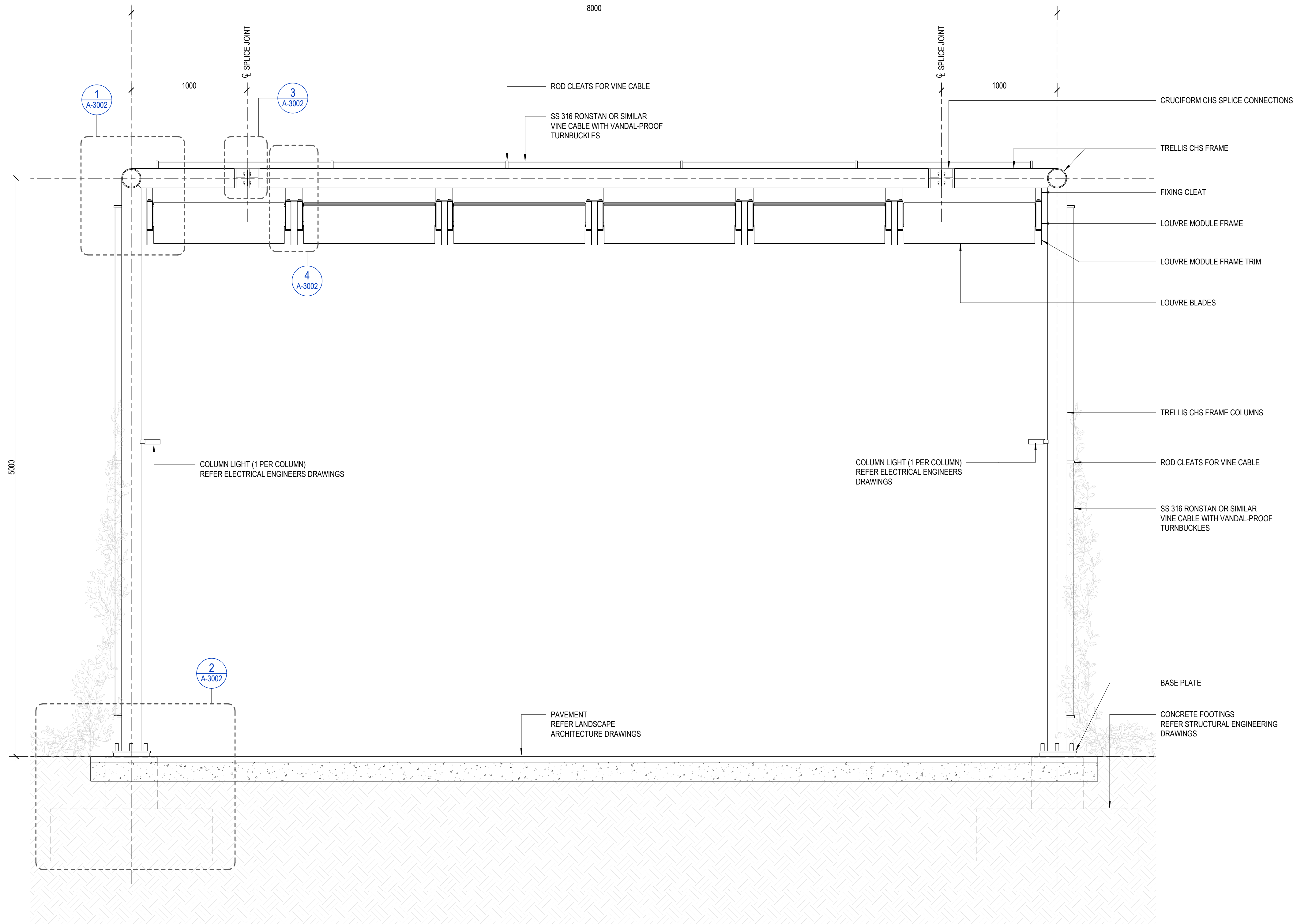

1 TRELLIS DETAIL CROSS SECTION  
SK109 1:20

NOT FOR CONSTRUCTION

CONSULTANT

**Hassell**

Hassell LTD ABN 24 007 711 435  
Level 2, Factory 1 West Village  
45 Mollison Street West End  
Brisbane QLD 4101 Australia  
T +61 7 3914 4000  
F +61 7 3914 4100  
brisbane@hassellstudio.com

REFERENCE

NORTH

NOTES

1. Do not scale drawing. Written dimensions govern
  2. All dimensions are in millimeters unless noted otherwise
  3. All dimensions shall be verified on site before proceeding with the work. Hassell shall be notified in writing of any discrepancies.
  4. This drawing must be read in conjunction with all relevant contracts, specifications and drawings
- This drawing is an uncontrolled copy. Unless noted otherwise  
© Copyright of this drawing is vested in Hassell Ltd.

REV DESCRIPTION

A	50% DD CO-ORDINATION ISSUE
B	50% DD ISSUE
C	90% DD CO-ORDINATION ISSUE
D	95% DD CLIENT ISSUE
E	100% DD ISSUE

DATE

06.04.23
18.04.23
17.05.23
26.05.23
26.07.23

CLIENT

EDQ

PROJECT

LUMINA OPEN SPACE

STATUS

DESIGN DEVELOPMENT

DRAWING TITLE

TRELLIS - DETAILS - SHEET 1

REVIEWED

TB

APPROVED

DK

DRAWING NO.

A-3000

SCALE @ A1

1:20

PROJECT NO.

016319

REV NO.

E

PRINT IN COLOUR





<div> <div>H</div> <div> <div>CONSULTANT</div> <div> <div>Hassell</div> <div> Hassell LTD ABN 24 007 711 435  Level 2, Factory 1 West Village  45 Mollison Street West End  Brisbane QLD 4101 Australia  T +61 7 3914 4000  F +61 7 3914 4100  brisbane@hassellstudio.com </div> </div> </div> </div>	<div> <div>REFERENCE</div> <div>NORTH</div> <div> </div> </div>	<div> <div>NOTES</div> <div> 1. Do not scale drawing. Written dimensions govern  2. All dimensions are in millimeters unless noted otherwise  3. All dimensions shall be verified on site before proceeding with the work. Hassell shall be notified in writing of any discrepancies.  4. This drawing must be read in conjunction with all relevant contracts, specifications and drawings    This drawing is an uncontrolled copy. Unless noted otherwise  © Copyright of this drawing is vested in Hassell Ltd. </div> </div>	<div> <div>REV DESCRIPTION</div> <div> A 90% DD CO-ORDINATION ISSUE  B 95% DD CLIENT ISSUE  C 100% DD ISSUE </div> <div> <div>DATE</div> <div> 17.05.23  26.05.23  26.07.23 </div> </div> </div>	<div> <div>CLIENT</div> <div>EDQ</div> <div> <div>PROJECT</div> <div>LUMINA OPEN SPACE</div> </div> </div>	<div> <div>STATUS</div> <div>DESIGN DEVELOPMENT</div> <div> <div>APPROVED</div> <div>DK</div> </div> <div> <div>DRAWING TITLE</div> <div>TRELLIS - DETAILS - SHEET 2</div> </div> <div> <div>REVIEWED</div> <div>TB</div> </div> <div> <div>SCALE @ A1</div> <div>As indicated</div> </div> <div> <div>PROJECT NO.</div> <div>016319</div> </div> <div> <div>REV NO.</div> <div>C</div> </div> <div> <div>DRAWING NO.</div> <div>A-3001</div> </div> </div>
---	---	--	--	--	---



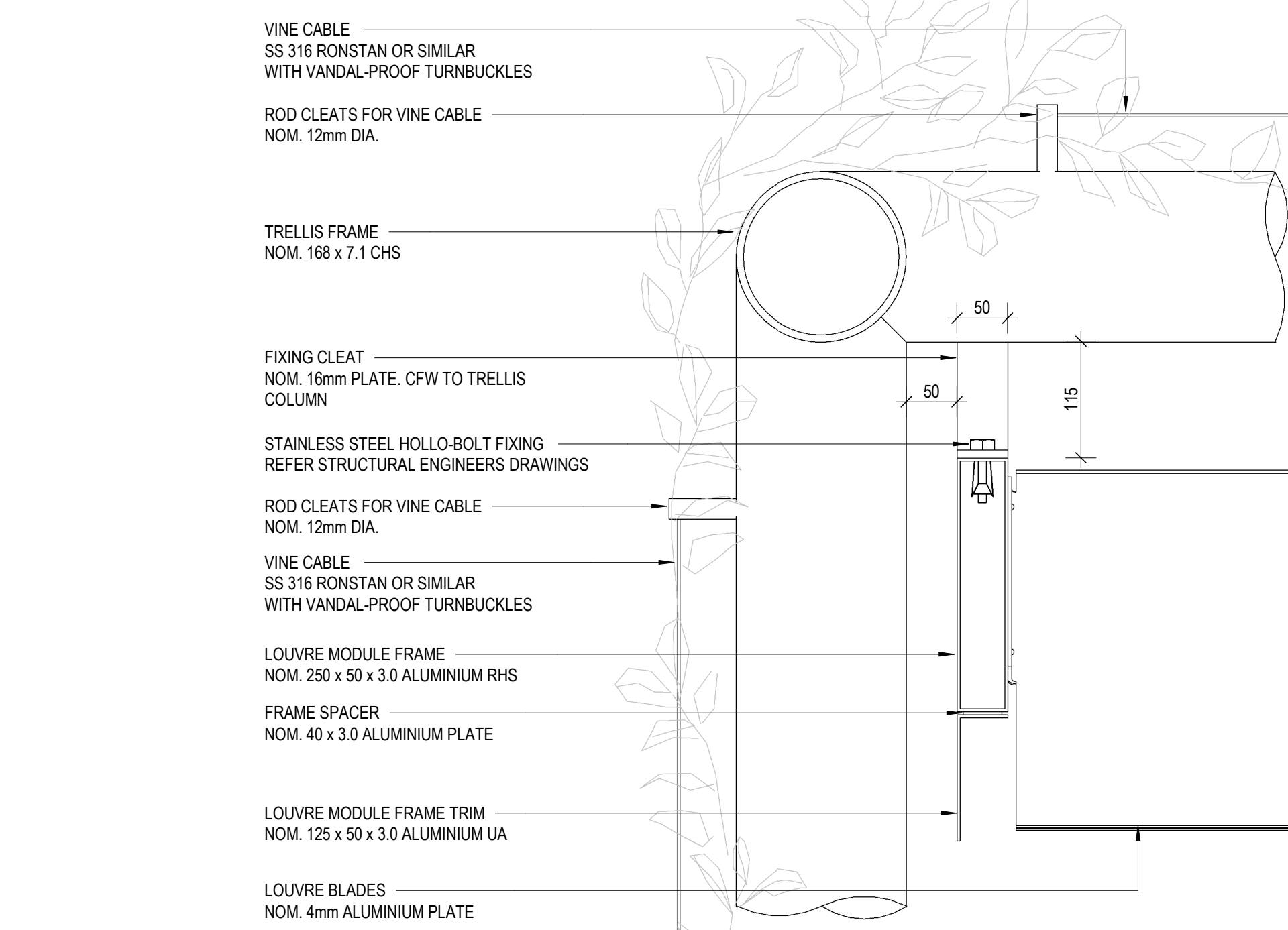

1 TRELLIS CORNER DETAIL  
A-3000 1:5

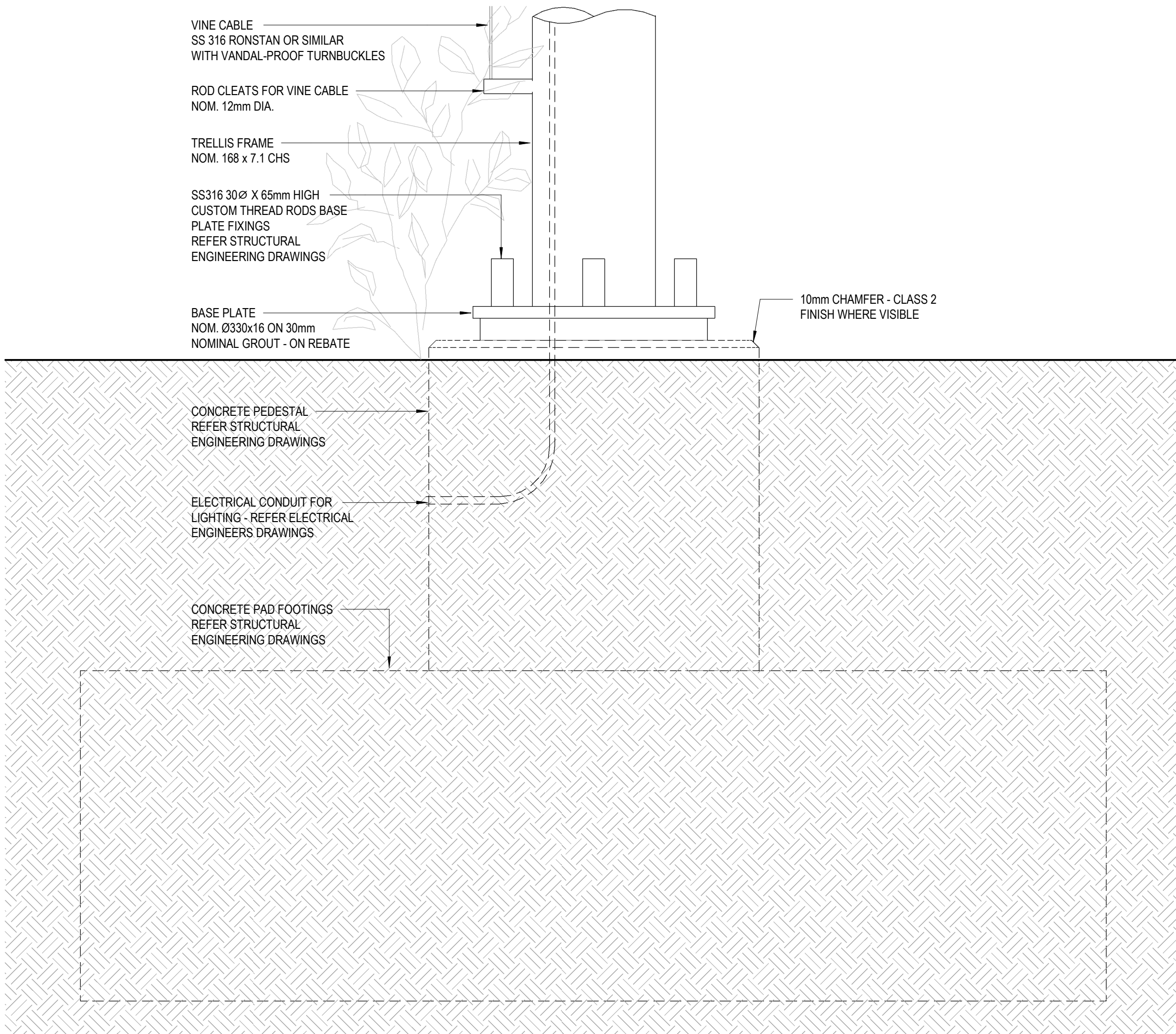

2 TRELLIS BASE DETAIL  
A-3000 1:5

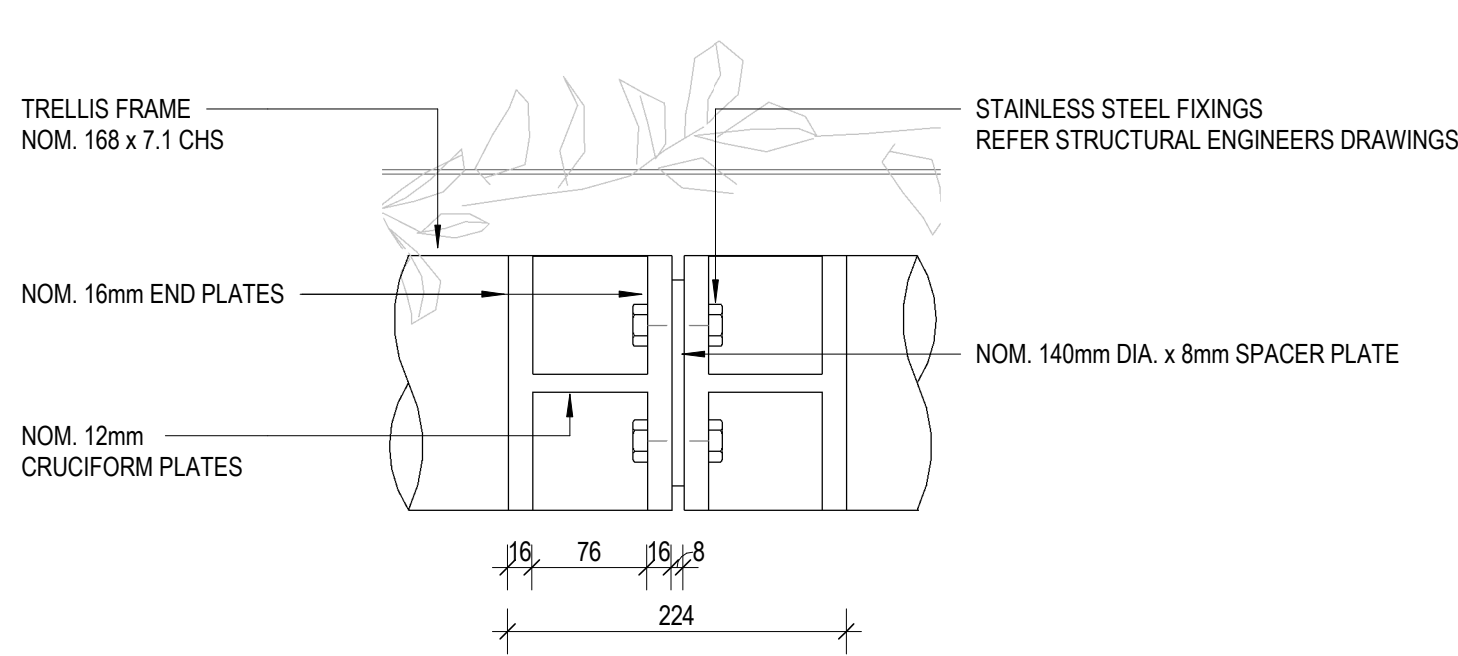

3 CRUCIFORM SPLICE DETAIL  
A-3000 1:5

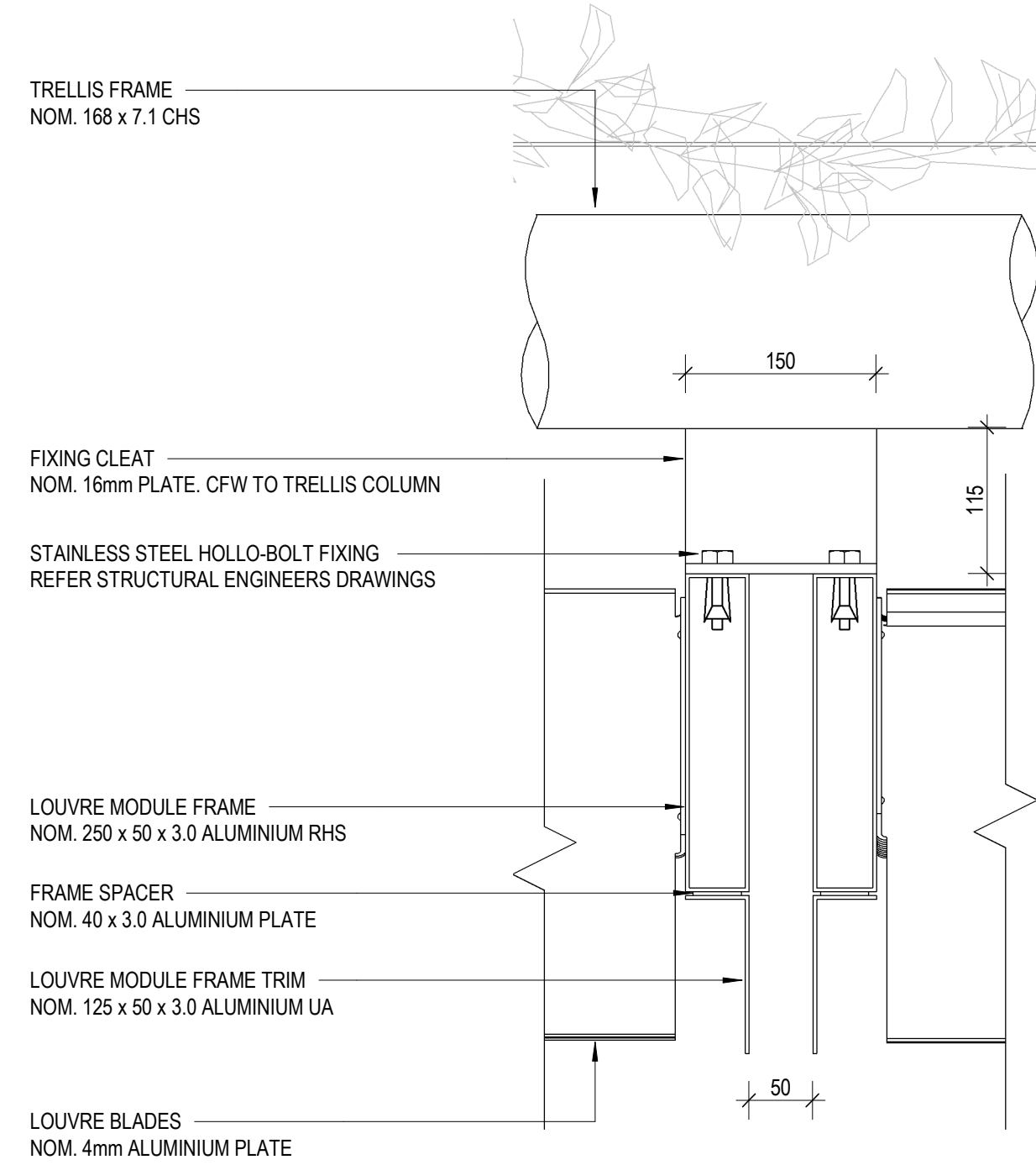

4 LOUVRE FRAME CONNECTION  
A-3000 1:5

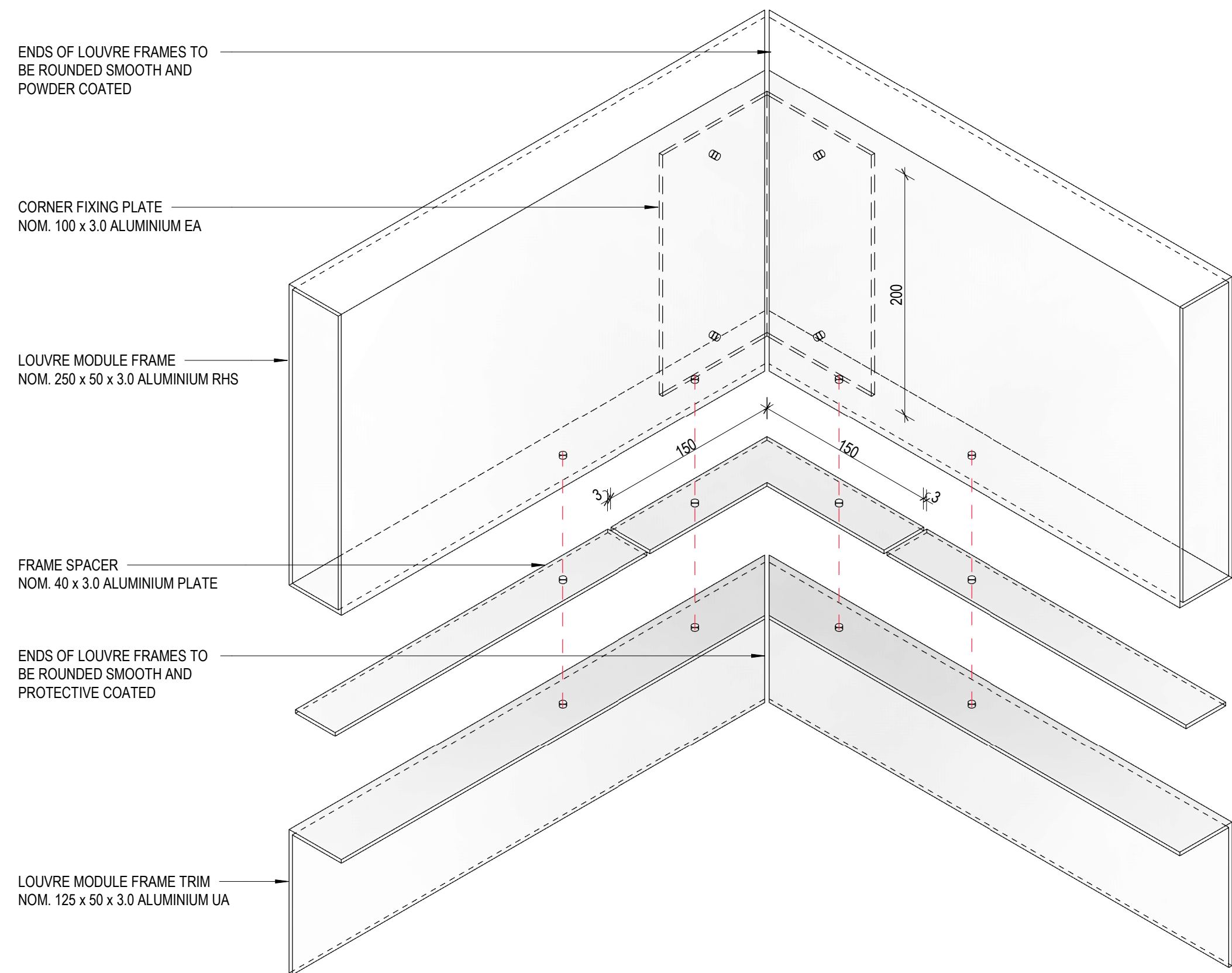

5 LOUVRE PANEL CORNER JUNCTION

NOT FOR CONSTRUCTION

H

CONSULTANT

Hassell

Hassell LTD ABN 24 007 711 435  
Level 2, Factory 1 West Village  
45 Mollison Street West End  
Brisbane QLD 4101 Australia  
T +61 7 3914 4000  
F +61 7 3914 4100  
brisbane@hassellstudio.com

REFERENCE

NORTH

NOTES

1. Do not scale drawing. Written dimensions govern
  2. All dimensions are in millimeters unless noted otherwise
  3. All dimensions shall be verified on site before proceeding with the work. Hassell shall be notified in writing of any discrepancies.
  4. This drawing must be read in conjunction with all relevant contracts, specifications and drawings
- This drawing is an uncontrolled copy. Unless noted otherwise  
© Copyright of this drawing is vested in Hassell Ltd.

REV DESCRIPTION

A 90% DD CO-ORDINATION ISSUE  
B 95% DD CLIENT ISSUE  
C 100% DD ISSUE

DATE

17.05.23  
26.05.23  
26.07.23

CLIENT

EDQ

PROJECT

LUMINA OPEN SPACE

STATUS

DESIGN DEVELOPMENT

DRAWING TITLE

TRELLIS - DETAILS - SHEET 3

REVIEWED

TB

APPROVED

DK

DRAWING NO.

A-3002

SCALE @ A1

1:5

PROJECT NO.

016319

REV NO.

C

PRINT IN COLOUR