

Archipelago

# YERONGA ACCESSWAY LANDSCAPE DATA REPORT



# 01

## CONTEXT

### OVERVIEW

The Parkside Yeronga Accessway (PYA) lies between the Yeronga Community Centre and the future commercial lot on Villa Street and is intended to provide an accessible pedestrian link from the established Villa Street to the newly created Currawong Crescent. More broadly it functions as a critical "accessible green" connection between Memorial Park to the south and the newly established Green Spine within Parkside Yeronga to the north, enhancing overall neighbourhood public realm connectivity. This connection not only facilitates movement but also offers a clear view of the CBD skyline, aligning with the core design principles established in the Parkside Yeronga master plan.

The public space has undergone a transformation from the initial master plan but nonetheless continues to strive for the delivery of a diverse and dynamic landscape accessible and enjoyable for people of all ages and abilities. The design intentionally prioritises high amenity equitable access through the provision of high-quality plaza style linkage with integrated and inviting resting spots along the access journey.

Generous plaza spaces are created at both ends of the accessway between Villa Street and Currawong Crescent ensuring the experience is of both the journey (walkways) and destination (plazas, community centre, Memorial Park). Holistically the accessway has been composed to boast a distinct identity and charm that fosters community interaction, casual gatherings, and longer stays across all levels of access.

Fundamentally the public realm has been inspired by and is underpinned by the indigenous meaning of the word 'Yeronga' – a place of tidal sands. The design interprets and abstractly references the tidal sands through shifting geometries and subtle level changes that are indicative of the patterns created by tidal waters on tidal flats. Further it is intended that through the potential for First Nations guidance and incorporation of abrasive blast patterning across the pavement that the "tidal sands" inspiration may be amplified. This aspiration is to be explored further with the EDQ team as an opportunity beyond the concept design phase.

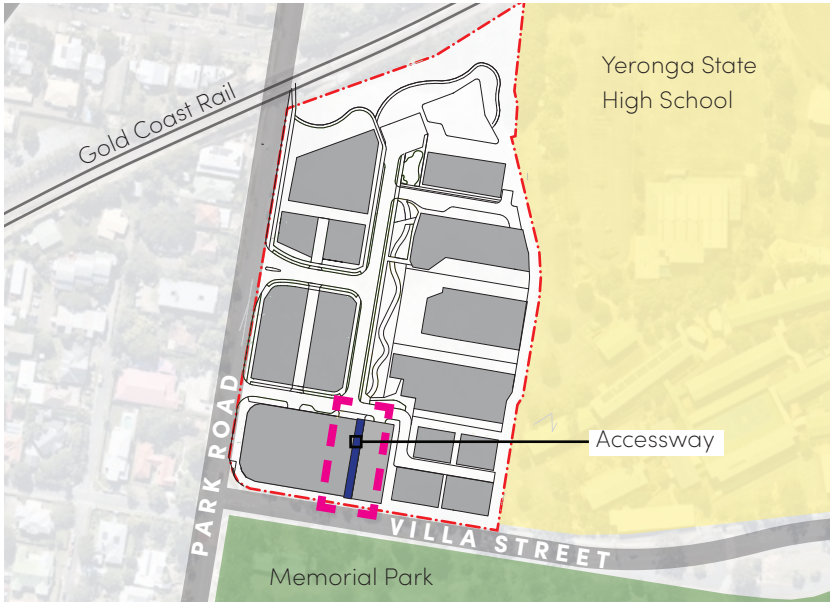

Location plan



# CONTENTS

## 01 CONTEXT

Overview and Location	2
Masterplan	3

## 02 PUBLIC REALM

Vision and design drivers	4
Site Plan	5
Accessway	7
Planting Palette	8
Hardscape Palette	9



# MASTER PLAN

**Parkside Yeronga** is an important inner city redevelopment showcasing how infill development can deliver diversity in form, use, and tenure.

It is to be a place that is sensitive to its context and respectful of its neighbours whilst providing an engaging new public realm and parkland offer expanding on the valued green space amenity of Memorial Park.

As part of the built form strategy for Parkside Yeronga, Economic Development Queensland (EDQ) has identified a site on the corner of Park Road and Villa Street as a development opportunity that may include health, commercial, residential or a mix of these uses. To the east of the corner site and located at the head of the Parkside Yeronga Green Spine on Villa Street, EDQ has delivered a new home for the Yeronga Community Centre (YCC) for the Department of Communities, Housing and Digital Economy.

A key element of the master plan is the construction of two new civic style buildings along Villa Street with the the YCC completed and the corner site undergoing further planning to establish the optimum uses that will drive a civic form. The YCC building and the future corner building will establish key master plan fabric around which the remaining uses will weave over time.

**Yeronga Accessway** is a new accessible space between the existing Yeronga Community centre and the future corner building. The accessway is framed by a plaza space at each end that will provide opportunities for large and small gatherings whilst enabling users of all abilities to connect to the YCC, between streets and with each other through an active, equitable and lush sub tropical landscape.



Note: All design arrangements are subject to ongoing design development.

VISION & DESIGN DRIVERS

“Delivering a curated, lush and comfortable landscape for those from near and far, for all abilities and every stage of life, the public realm for this accessway will be of and for all communities”

The landscape will carefully engage with the existing built form aesthetics, language and articulation of the YCC architecture whilst providing flexibility along the eastern edge for future building connectivity whilst concurrently expressing the vernacular visual language of Memorial Park and the local residential community.

Abstractly reflecting the first nations history of the site, the public realm is inspired by and underpinned by the indigenous meaning of the word ‘Yeronga’ – yerongpa, a place of tidal sands. The design through this underpinning and as captured in the design drivers is intended to interpret and abstractly reference the tidal sands through shifting geometries and subtle level changes that are indicative of the patterns created by tidal waters on tidal flats. As is identified earlier, the aspiration also exists to seek First Nations involvement in the development of abrasive blast patterning of the pavement so as to infuse genuine visual meaning into the "journey".

To achieve the aspirations of the vision, the Yerongpa inspiration and to deliver on the place potential of the site and development built form, the three design drivers to the right were established to guide the development of the public realm.

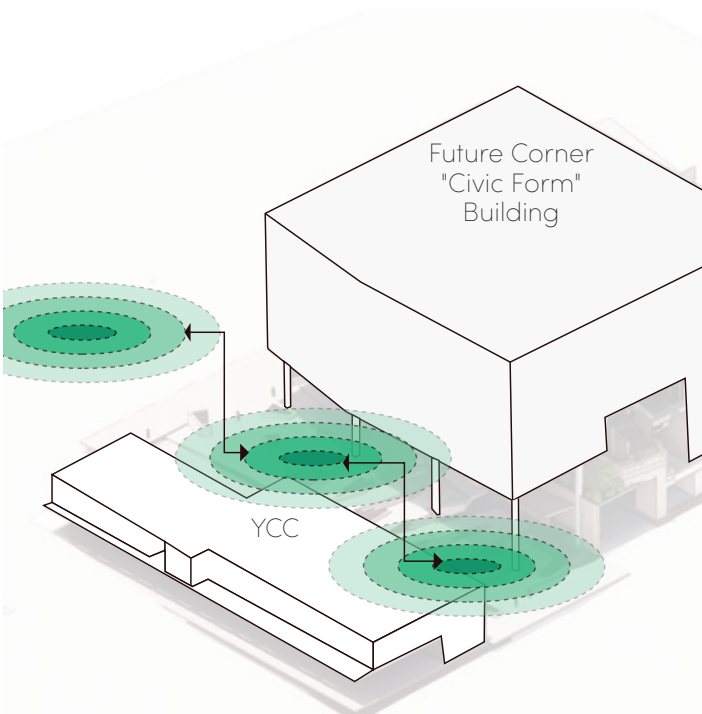

Nurture a Nexus

Establish an urban green community plaza heart at the sites core that forms the nucleus of the Green Spine uniting Parklands Yeronga with Memorial Park and the wider community.

Compose and furnish this public plaza to create a safe, comfortable and inviting destination that brings people together, connecting them with each other socially whilst also unlocking a new activated and equitable connection between Villa Street and Parkside Yeronga.

Whilst the plaza draws people together through functional provision for larger social gatherings and events, it should also offer a suite of more intimate places for respite, to retreat, to seek refuge, dwell and reflect.

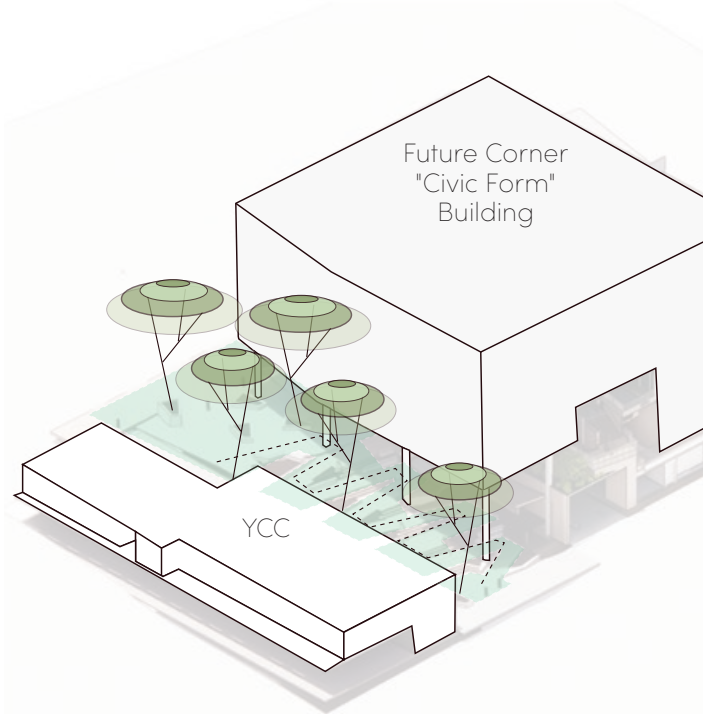

Lushly Layer

Create a rich urban sub-tropical tapestry of public realm experience by layering local materials, indigenous plantings, furniture and art from local suppliers in compositions that are engaging and speak to the Yerongpa inspiration of tidal sands.

Adopt layered and heavily articulated geometries of shallow walkways and staggered stairs to create a cascading lushly textured landscape place unfolding down from Villa Street to open up and out to reveal a cool inviting layered plaza address to Parkside Yeronga.

Consider the integration of abrasive blast patterning within pavements as an expression of the "shifting sands" journey.

In open spaces articulate the plaza and built form edges to engage and create a conversational design language between the built form and the public realm that provokes a public desire to occupy the places in between inside and outside.

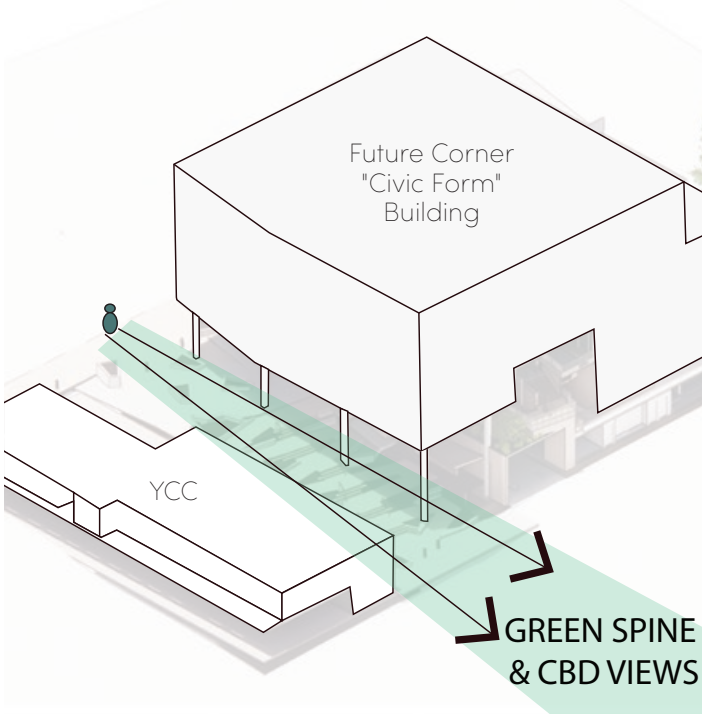

Curate Views

Feature and compose plaza and landscape places to frame and maximise the availability of expansive City Skyline and Memorial Park views.

Create a suite of landscape places throughout the public realm that sequence views of the CBD so that each view reveals a new angle, a skyline or building detail or is framed in a different and engaging way.

Curate the streetscape design to frame views toward the building, plaza landscape and retained street tree and site trees.

Retain the locally character significant Hoop Pines along Park Road and the *Handroanthus* along Villa Street to soften and integrate the built form edge.



SITE PLAN



- Legend
- 1 Loading bay
  - 2 Lot 1 driveway
  - 3 Lot 11 Accessway
  - 4 Currawong Crescent Plaza (110m<sup>2</sup>)
  - 5 Villa street plaza (175m<sup>2</sup>)
  - 6 DDA compliant walkway between Villa Street and Currawong Crescent
  - 7 Stair access between Villa Street and Currawong Crescent
  - 8 Stair access to Yeronga Community Centre entry threshold
  - 9 Seating nook, concrete bench seat
  - 10 Retaining wall to lot boundary
  - 11 Raised planter with seating
  - 12 Proposed lighting locations
  - 13 Wayfinding signage locations
  - 14 Significant tree on installation min 5m height 4m canopy spread
  - 15 Future footpath and streetscape planting to be constructed as part of Lot 1 works
  - 16 Existing streetscape works constructed as part of Parkside Yeronga Stage 1 works



# ACCESSWAY



Artist impression of view from Currawong Crescent Plaza, south towards Villa Street



Artist impression of Nature Nook



Artist impression

- Legend**
- 1 Yeronga Community Centre
  - 2 Lot 1 Future development
  - 3 Public Plaza (Villa Street)
  - 4 South Street Plaza
  - 5 Cascading walkway and stair



## Accessway

The Accessway with public plazas is a community space located on the green spine axis linking Memorial Park to the Parkside Yeronga public green spine and CBD, and Villa Street to Currawong Crescent. This community social place is composed to take maximum advantage of its green spine connectivity to open up and unlock public access to expansive CBD skyline views.

The Accessway provides the welcome mat to the precinct with access from the informal crossing at Villa Street and full block interfaces to the Yeronga Community Centre (YCC, to the east) and future corner building (west).

The Accessway provides YCC event break out spaces and the community areas to host small public events and a safe and equitable path of travel between Villa Street, Currawong Crescent and Maidenhair Place. It will provide for clear sight-lines and intuitive movement between the upper level plaza at Villa Street and the lower level plaza on Currawong Crescent via an articulated walkway with integrated informal seating nooks and a companion stair.

Underpinning the Public Plaza design is the overarching and originating “Yerongpa” indigenous generative theming. This theming of “tidelands in sand” is abstractly expressed through the Public Plaza design arrangement and materiality. Specifically the wandering walkway, cascading stairs and nature nooks have been geometrically composed as a representation of the “irregular erosive patterns” of water on sands, a metaphor for natural systems and process. Similarly the opportunity for First Nations inspired abrasive blast patterning offers the potential to deepen the layers of meaning through direct visual expression.

The materiality of the plaza will be composed to speak to the public building architecture on its eastern edge. Specifically the plaza space will selectively draw upon and draw through the low civic brick language established in the YCC walling through an abstracted jointing expression on the walkway “low side” as part of a contrast band to define the edge.

Complimenting the “visual” brick carried though from the adjacent YCC, the ground plane will adopt a warm toned coloured concrete in honed and coarse broomed finishes. The honing process will reveal brown and white aggregates that visually reinforce the “shifting sands” inspiration whilst the broom finished areas may include an abrasive blast pattern to further visually express the “shifting sands” underpinning. At the interface between the seat walls and walls, a ground plane apron or puddle of porphyry or jointed brick expression is proposed to wrap so as to elegantly and engagingly stitch together the horizontal and vertical ground planes.

Planting within the Plaza will be naturally composed with subtropical species at strategic scales to maintain sight-lines, and deliver ample plaza shade whilst cossetting the community within a lush native Brisbane environment.

Under planting will be lush low maintenance species deliberately composed as a counterpoint to the monolithic plaza pavement with its stone and brick highlights.



# PLANTING PALETTE

New planting throughout the site will seek to contribute to the subtropical landscape character of Brisbane. The planting palette will include predominately native species but will also include non-invasive plant species which are appropriate to Brisbane's climate and the character of the site.

Street tree species will be selected in accordance with the Brisbane City Council street tree palette to ensure they are species that are good performers, have low maintenance needs and are climate resilient. Street tree species are selected and arranged so as to not impact sight distances (narrow trunks, clear trunked with foliage above sight lines) and will be set back from the kerb in accordance with BCC standards and in anticipation of future left turn pocket delivery.



TREE TYPE 1  
T1

SPECIES

Ficus microcarpa var. hillii - Hill's Weeping Fig

SIZE	MATURE SIZE
200Ltr	10m H x 6m W.

DESCRIPTION  
This is a very tall spreading shade tree with weeping foliage.



TREE TYPE 2  
T2

SPECIES

Elaeocarpus eumundii - Eumundi Quandong

SIZE	MATURE SIZE
200Ltr	10m H x 3m W.

DESCRIPTION  
Native foliage tree with bronzed red new growth and deep green glossy leaves arranged in a fan. Flowers late spring to early summer with clusters of sweetly scented cream flowers.



TREE TYPE 3  
T3

SPECIES

Randia fitzalanii - Native Gardenia

SIZE	MATURE SIZE
200Ltr	Up to 5 m H x 2-4 m W.

DESCRIPTION  
Australian native also known as yellow mangosteen. Clusters of small highly fragrant flowers above glossy evergreen foliage. Flowers in spring followed by large yellow-brown edible fruit which are ready to eat when soft.



TREE TYPE 4  
T4

SPECIES

Handroanthus palmeri, 'Pink Trumpet Tree'

SIZE	MATURE SIZE
100Ltr	8m H x 5m W

DESCRIPTION  
A native of Mexico with a rounded canopy. Has upright growth habit with attractive grey bark. Leaves are mid green and has masses of pink flowers in late winter to summer.



TREE TYPE 5  
T5

SPECIES

Backhousia citriodora - Lemon scented Myrtle

SIZE	MATURE SIZE
200Ltr	15m H x 4m W

DESCRIPTION  
Hardy, native, fluffy white flowers, lemon-scented foliage. Lemon Myrtle is sometimes referred to as the “Queen of the Lemon Herbs”. It boasts an intensely citrus fragrance and flavour, and has long been used in Aboriginal cuisine and medicine



TREE TYPE 6  
T6

SPECIES

Wodyetia bifurcata - Foxtail palm

SIZE	MATURE SIZE
200Ltr	4m H x 10m W

DESCRIPTION  
Slender, tall and compact palm.



# PLANTING PALETTE

New planting surrounding the built form will seek to contribute to the subtropical landscape character of Brisbane. The planting palette will include predominately native species but will also include non-invasive plant species which are appropriate to Brisbane’s climate and the character of the site.

Street tree species will be selected in accordance with the Brisbane City Council street tree palette to ensure they are species that are good performers, have low maintenance needs and are climate resilient.



FEATURE PLANTING TYPE 1  
FP1

SPECIES  
Melaleuca thymifolia - honey myrtle

SIZE	MATURE SIZE
200mm	1.5 m H x 1.5 m W

DESCRIPTION  
Fine-leaved bushy native shrub with purple-pink feathery flowers in summer-autumn.



FEATURE PLANTING TYPE 2  
FP2

SPECIES  
Grevillea sp - Grevillea

SIZE	MATURE SIZE
300mm	0.3 m H x 1.0 m W

DESCRIPTION  
Strappy leaf evergreen clumping plant suited to shaded areas of the garden. Flowers late winter and early spring in clusters of gentle pastel trumpet-shaped flowers with green centres, followed by red cherry-like seedpods..



FEATURE PLANTING TYPE 3  
FP3

SPECIES  
Callistemon spp - Bottle brush

SIZE	MATURE SIZE
300mm	1.m H x 1.m W

DESCRIPTION  
Fast growing, hardy, woody shrub that produces beautiful blooms in a variety of single colours in spring and summer and sometimes again in autumn.



FEATURE PLANTING TYPE 4  
FP4

SPECIES  
Crinum peduncuatum - Brisbane River lily

SIZE	MATURE SIZE
300mm	1.5 m H x 1.2 m W

DESCRIPTION  
Tufting plant with strappy leaves up to two metres. Open white flowers on thick stems from November to March. Prefers a damp spot in full sun or part shade



FEATURE PLANTING TYPE 5  
FP5

SPECIES  
Philodendron Xanadu

SIZE	MATURE SIZE
300mm	1.2 m H x 1.2 m W

DESCRIPTION  
Luscious evergreen foliage with compact growth habit. Decoratively shaped leaves.



FEATURE PLANTING TYPE 6  
FP6

SPECIES  
Doryanthes excelsa - Gumea lily

SIZE	MATURE SIZE
45L	1.5m H x 1.5m W

DESCRIPTION  
Large native clumping plant with upright long sword-shaped leaves and giant 2-4m red flower spikes on mature plants in spring. The flowers start as a teardrop-shaped bud and open into a cluster of starry flowers, rich in nectar, each with green pollen.



# HARDSCAPE PALETTE



PLAZA AND WALKWAY PAVEMENT  
PT1

MATERIAL  
Honed Insitu coloured concrete CCS Paperbark

SIZE  
125mm Depth

DESCRIPTION  
Honed Insitu coloured concrete with caspian aggregate and penetrative sealant.

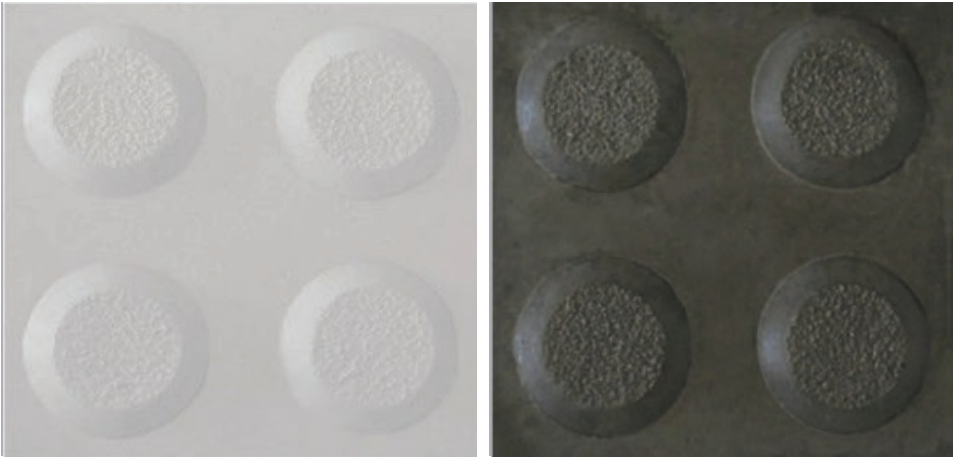

TACTILE GROUND SURFACE INDICATOR  
PT4

MATERIAL  
TGSI - Concrete paver

SIZE  
300x 300x 40mm

DESCRIPTION  
Chelmstone Precast concrete hazard TGSI (Tactile Ground Surface Indicator).



SEAT TYPE

MATERIAL  
Precast concrete

SIZE  
Custom length 425 width

DESCRIPTION  
Precast concrete seat with anti skate notches.



WALKWAY LIGHTING

MATERIAL  
WEE-EF AFL100 LED POLE MOUNTED LUMINAIRE



STAIR HANDRAIL

MATERIAL  
STAINLESS STEEL



—CONTACT

Dominic Powell  
Archipelago Architects Pty Ltd

T— +61 (07) 3236 4606  
E— mail@archipelago.com.au

—DOCUMENT ISSUE RECORD

Client:	Economic Development Queensland	
Report:	Yeronga Parkside Landscape DA Report_Draft	
File:	21009_Yeronga Parkside Preliminary Approval	
Date:	Revision:	Checked:
03/05/2025	A	DP

© ARCHIPELAGO. All Rights Reserved

This work is copyright and cannot be reproduced or copied by any means without written permission of Archipelago Architects Pty Ltd. Any license, express or implied, to use this document for any purpose whatsoever is restricted to the terms of the agreement between Archipelago Architects Pty Ltd and the instructing party.