

OVERALL CONCEPT PLAN

NOT TO BE USED FOR ENGINEERING DESIGN
OR CONSTRUCTION

NOTES

This plan was prepared as a conceptual layout only. The information on this plan is not suitable for any other purpose.

Property dimensions, areas, numbers of lots and contours and other physical features shown have been compiled from existing information and may not have been verified by field survey. These may need verification if the development application is approved and development proceeds, and may change when a full survey is undertaken or in order to comply with development approval conditions.

No reliance should be placed on the information on this plan for detailed subdivision design or for any financial dealings involving the land.

Pavements and centrelines shown are indicative only and are subject to Engineering Design.

Saunders Havill Group therefore disclaims any liability for any loss or damage whatsoever or howsoever incurred, arising from any party using or relying upon this plan for any purpose other than as a document prepared for the sole purpose of accompanying a development application and which may be subject to alteration beyond the control of the Saunders Havill Group. Unless a development approval states otherwise, this is not an approved plan.

DCDB © State of Queensland (Department of Natural Resources and Mines) 2019.
Lidar Data © State of Queensland (Department of Natural Resources and Mines) 2016.

* This note is an integral part of this plan/data. Reproduction of this plan or any part of it without this note being included in full will render the information shown on such reproduction invalid and not suitable for use.

PROJECTION: SURVEY COORDINATES
SUBJECT BOUNDARIES: LOT CALCULATIONS FROM SAUNDERS
HAVILL GROUP DATED 09/05/2023
CONTOURS: ELVIS - LIDAR

LEGEND

- Site Boundary
- Major Contour (1.0m interval)
- Minor Contour (0.25m interval)
- Flagstone Creek Centreline
- 50m Centreline Waterway Buffer
- 100m Centreline Waterway Buffer
- Approx High Bank - Derived from Slope analysis utilising lidar data
- 50m High Bank Offset
- 1 in 5 ARI
- Riparian Zone - 5.051 ha
- Linear Park 9.739 ha
- Remnant Endangered Mapping
- 4m wide Landscape Interface Buffer
- Previous Road Alignment
- Staging Boundary
- Staging Number
- Q100
- Potential Multiple Residential Allotment
- Signage Location - Large Entry Statement
- Signage Location - Secondary Entry Statement
- Signage Location - Billboard (6x3 double sided V)
- Signage Location - H Frame
- Signage Location - Banner Pole

PLANS AND DOCUMENTS
referred to in the PDA
DEVELOPMENT APPROVAL

Approval no: DEV2019/1013/8
Date: 09 May 2024



DEVELOPMENT STATISTICS			
RESIDENTIAL ALLOTMENTS	No. Lots	%	Net Area
Laneway Terrace Lots	7	1.4%	0.168 ha
Terrace Lots	7	1.4%	0.169 ha
Vila Lots	159	30.9%	4.802 ha
Premium Villa Lots	174	33.9%	6.597 ha
Courtyard Lots	122	23.7%	5.210 ha
Premium Courtyard Lots	14	2.7%	0.750 ha
Interface Lots	31	6.0%	2.404 ha
Total Residential Allotments	514	100.0%	20.100 ha
Land Budget	Area (Ha)	%	
Area of Subject Site / Stage	40.703 ha	—	
Net Residential Area (no roads)	20.100 ha	49.4%	
Neighbourhood Recreation Park	0.491 ha	1.2%	
Linear Park	11.062 ha	27.2%	
Road Areas	8.771 ha	21.5%	
Child Care Centre	0.279 ha	0.7%	
Total	40.703 ha	100.0%	
Average Lot Size (m²)	391 m²		
Length of New Road	4916 m		

RP DESCRIPTION: Lot 30 on SP309195

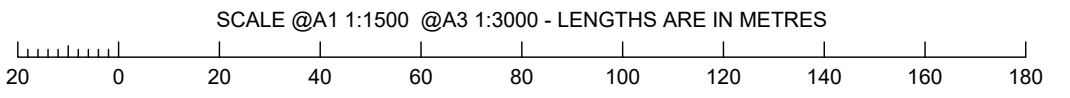

DALEFORD PROPERTY PTY LTD

STAGING PLAN - STAGE 1

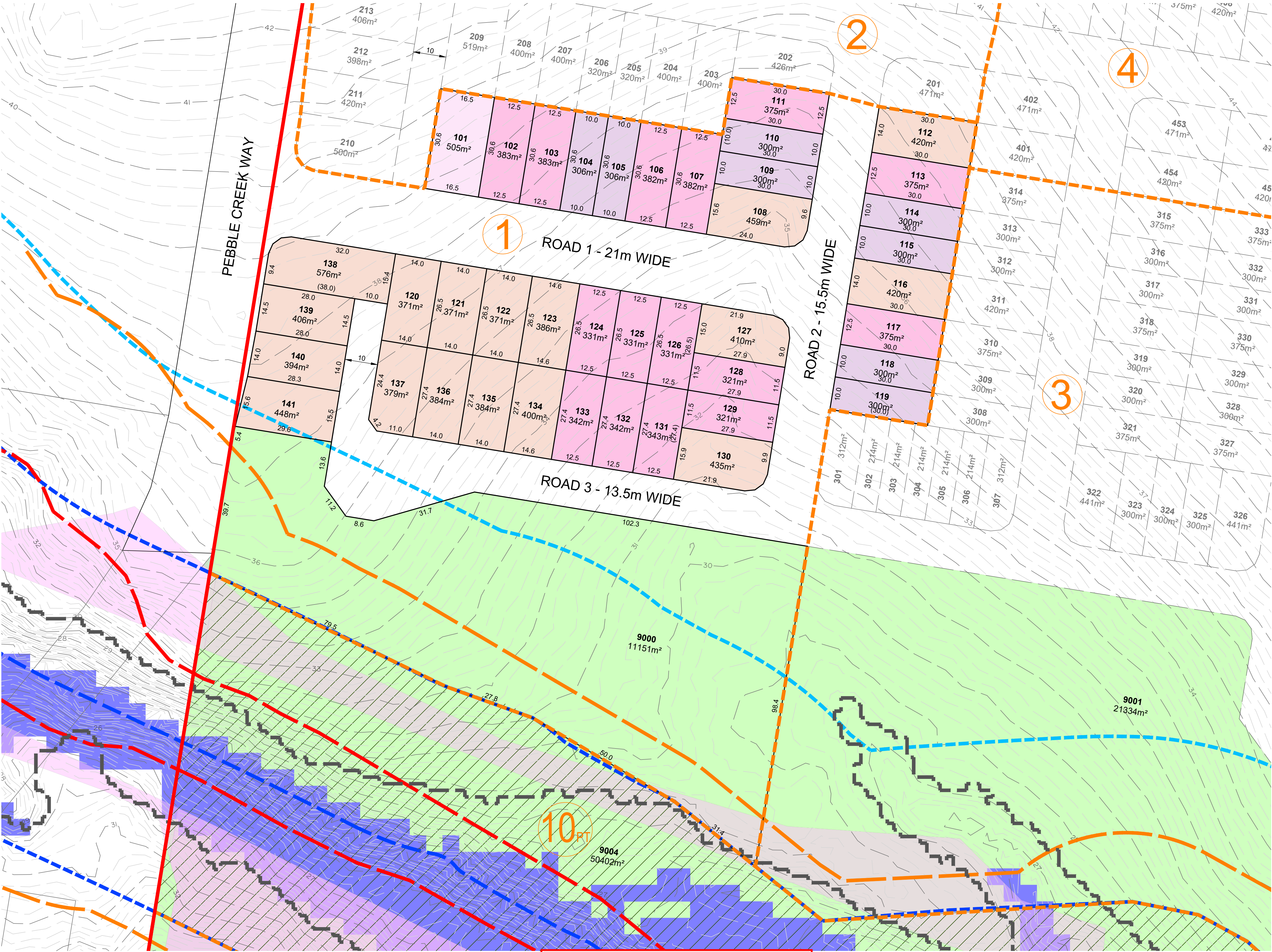

NOT TO BE USED FOR ENGINEERING DESIGN
OR CONSTRUCTION

NOTES

This plan was prepared as a provisional layout to accompany a development application. The information on this plan is not suitable for any other purpose.

Property dimensions, areas, numbers of lots and contours and other physical features shown have been compiled from existing information and may not have been verified by field survey. These may need verification if the development application is approved and development proceeds, and may change when a full survey is undertaken or in order to comply with development approval conditions.

No reliance should be placed on the information on this plan for detailed subdivision design or for any financial dealings involving the land.

Pavements and centrelines shown are indicative only and are subject to Engineering Design.

Saunders Havill Group therefore disclaims any liability for any loss or damage whatsoever or howsoever incurred, arising from any party using or relying upon this plan for any purpose other than as a document prepared for the sole purpose of accompanying a development application and which may be subject to alteration beyond the control of the Saunders Havill Group. Unless a development approval states otherwise, this is not an approved plan.

DCDB © State of Queensland (Department of Natural Resources and Mines) 2019.
Lidar Data © State of Queensland (Department of Natural Resources and Mines) 2016.

* This note is an integral part of this plan/data. Reproduction of this plan or any part of it without this note being included in full will render the information shown on such reproduction invalid and not suitable for use.

PROJECTION: SURVEY COORDINATES
SUBJECT BOUNDARIES: LOT CALCULATIONS FROM SAUNDERS
HAVILL GROUP DATED 09/05/2023
CONTOURS: ELVIS - LIDAR

LEGEND

- Site Boundary
- Major Contour (1.0m interval)
- Minor Contour (0.25m interval)
- Flagstone Creek Centreline
- 50m Centreline Waterway Buffer
- 100m Centreline Waterway Buffer
- Approx High Bank - Derived from Slope analysis utilising lidar data
- 50m High Bank Offset
- 1 in 5 ARI
- Riparian Zone
- Linear Park
- Remnant Endangered Mapping
- Staging Boundary
- Stage No.
- Q100

DEVELOPMENT STATISTICS - Stage 1			
RESIDENTIAL ALLOTMENTS	No. Lots	%	Net Area
Villa Lots	8	19.5%	0.241 ha
Premium Villa Lots	15	36.6%	0.532 ha
Courtyard Lots	17	41.5%	0.701 ha
Premium Courtyard Lots	1	2.4%	0.051 ha
Total Residential Allotments	41	100.0%	1.525 ha
Land Budget	Area (Ha)	%	
Area of Subject Site / Stage	3.490 ha	—	
Net Residential Area (no roads)	1.525 ha	43.7%	
Linear Park	1.115 ha	31.9%	
Road Areas	0.850 ha	24.4%	
Total	3.490 ha	100.0%	
Average Lot Size (m ²)	372 m ²		
Length of New Road	423 m		

RP DESCRIPTION: Lot 30 on SP309195

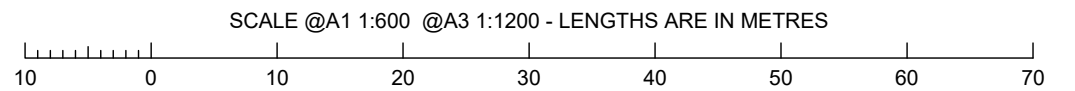

PLANS AND DOCUMENTS
referred to in the PDA
DEVELOPMENT APPROVAL

Approval no: DEV2019/1013/8
Date: 09 May 2024



STAGING PLAN - STAGE 2

NOT TO BE USED FOR ENGINEERING DESIGN
OR CONSTRUCTION

NOTES

This plan was prepared as a provisional layout to accompany a development application. The information on this plan is not suitable for any other purpose.

Property dimensions, areas, numbers of lots and contours and other physical features shown have been compiled from existing information and may not have been verified by field survey. These may need verification if the development application is approved and development proceeds, and may change when a full survey is undertaken or in order to comply with development approval conditions.

No reliance should be placed on the information on this plan for detailed subdivision design or for any financial dealings involving the land.

Pavements and centrelines shown are indicative only and are subject to Engineering Design.

Saunders Havill Group therefore disclaims any liability for any loss or damage whatsoever or howsoever incurred, arising from any party using or relying upon this plan for any purpose other than as a document prepared for the sole purpose of accompanying a development application and which may be subject to alteration beyond the control of the Saunders Havill Group. Unless a development approval states otherwise, this is not an approved plan.

DCDB © State of Queensland (Department of Natural Resources and Mines) 2019.
Lidar Data © State of Queensland (Department of Natural Resources and Mines) 2016.

* This note is an integral part of this plan/data. Reproduction of this plan or any part of it without this note being included in full will render the information shown on such reproduction invalid and not suitable for use.

PROJECTION: SURVEY COORDINATES
SUBJECT BOUNDARIES: LOT CALCULATIONS FROM SAUNDERS
HAVILL GROUP DATED 09/05/2023
CONTOURS: ELVIS - LIDAR

LEGEND

- Site Boundary
- Major Contour (1.0m interval)
- Minor Contour (0.25m interval)
- Staging Boundary
- Stage No.
- 100m Centreline Waterway Buffer
- 50m High Bank Offset

PLANS AND DOCUMENTS
referred to in the PDA
DEVELOPMENT APPROVAL

Approval no: DEV2019/1013/8
Date: 09 May 2024



DEVELOPMENT STATISTICS - Stage 2			
RESIDENTIAL ALLOTMENTS	No. Lots	%	Net Area
Vila Lots	17	27.9%	0.514 ha
Premium Villa Lots	26	42.6%	0.989 ha
Courtyard Lots	14	23.0%	0.584 ha
Premium Courtyard Lots	4	6.6%	0.200 ha
Total Residential Allotments	61	100.0%	2.287 ha
Land Budget			
Area of Subject Site / Stage	Area (Ha)	%	
Net Residential Area (no roads)	2.287 ha	72.3%	
Road Areas	0.875 ha	27.7%	
Total	3.162 ha	100.0%	
Average Lot Size (m²)	375 m²		
Length of New Road	430 m		

RP DESCRIPTION: Lot 30 on SP309195

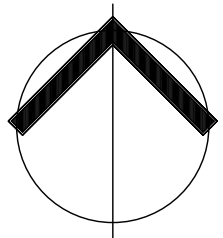
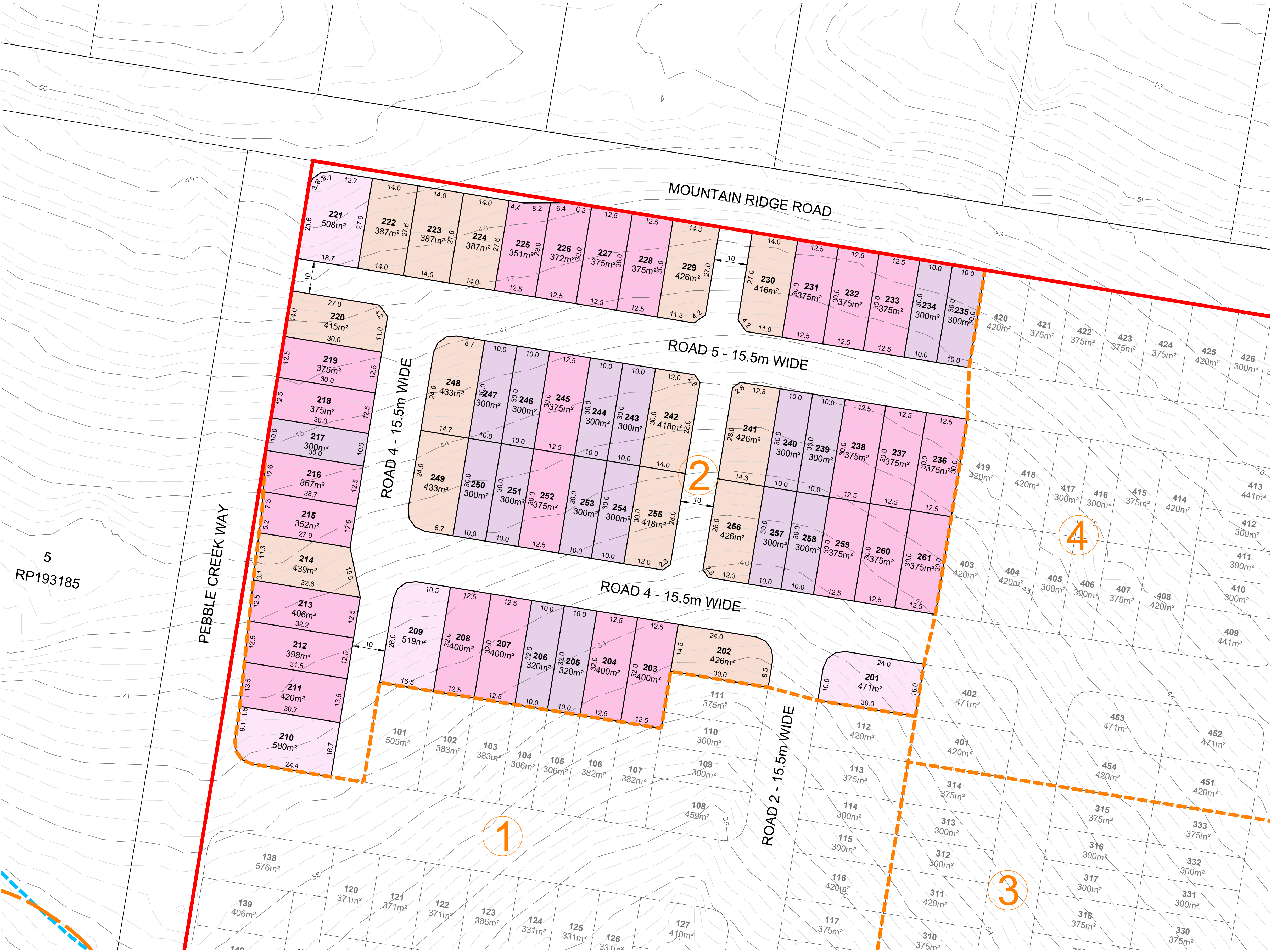
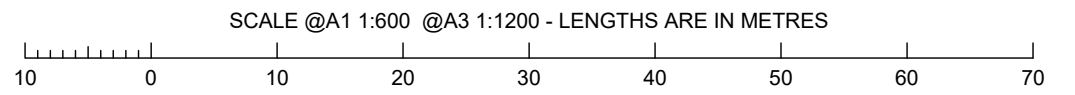

STAGING PLAN - STAGE 3

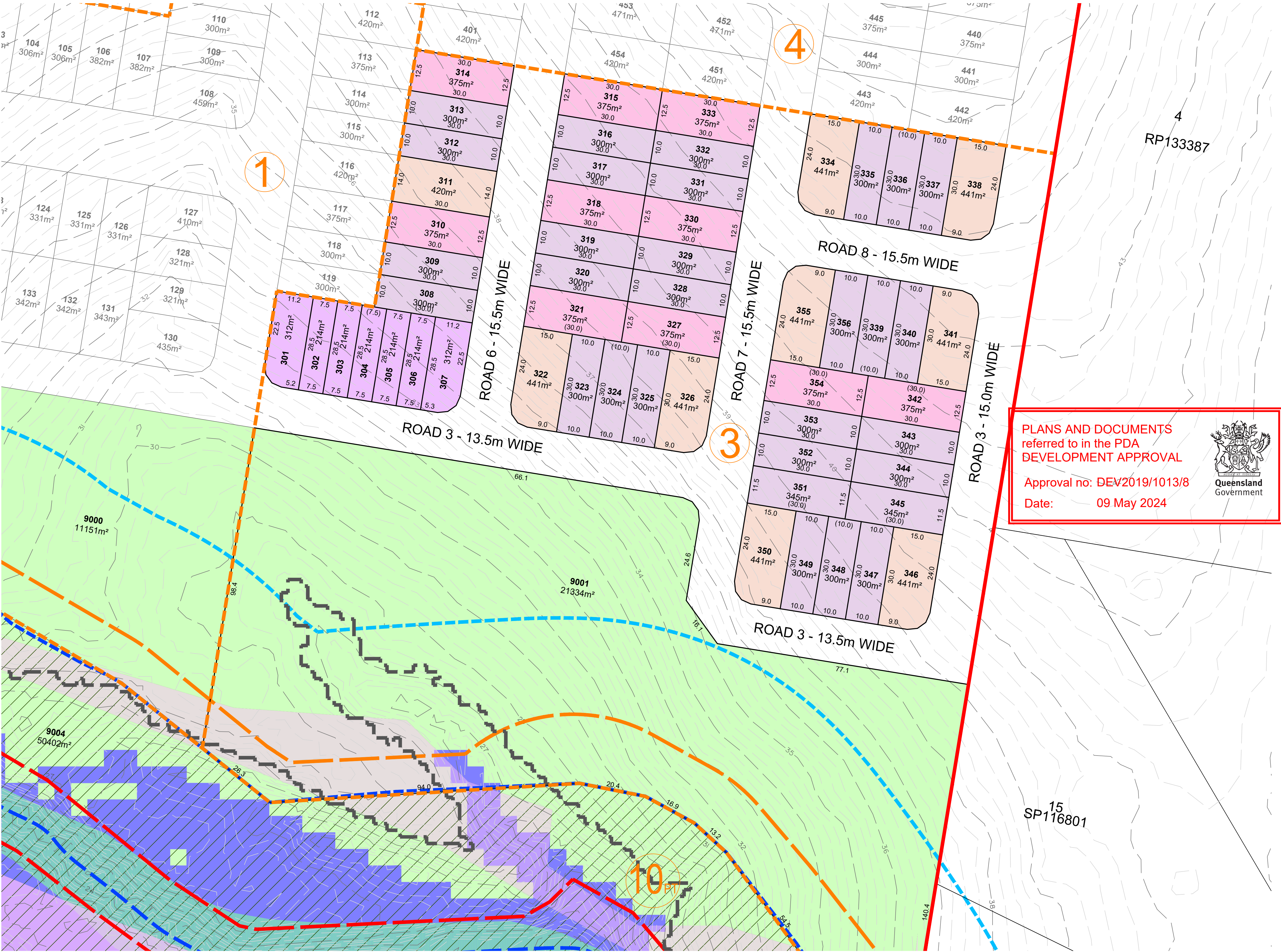

NOT TO BE USED FOR ENGINEERING DESIGN OR CONSTRUCTION

NOTES

This plan was prepared as a provisional layout to accompany a development application. The information on this plan is not suitable for any other purpose.

Property dimensions, areas, numbers of lots and contours and other physical features shown have been compiled from existing information and may not have been verified by field survey. These may need verification if the development application is approved and development proceeds, and may change when a full survey is undertaken or in order to comply with development approval conditions.

No reliance should be placed on the information on this plan for detailed subdivision design or for any financial dealings involving the land.

Pavements and centrelines shown are indicative only and are subject to Engineering Design.

Saunders Havill Group therefore disclaims any liability for any loss or damage whatsoever or howsoever incurred, arising from any party using or relying upon this plan for any purpose other than as a document prepared for the sole purpose of accompanying a development application and which may be subject to alteration beyond the control of the Saunders Havill Group. Unless a development approval states otherwise, this is not an approved plan.

DCDB © State of Queensland (Department of Natural Resources and Mines) 2019.
Lidar Data © State of Queensland (Department of Natural Resources and Mines) 2016.

* This note is an integral part of this plan/data. Reproduction of this plan or any part of it without this note being included in full will render the information shown on such reproduction invalid and not suitable for use.

PROJECTION: SURVEY COORDINATES
SUBJECT BOUNDARIES: LOT CALCULATIONS FROM SAUNDERS HAVILL GROUP DATED 09/05/2023
CONTOURS: ELVIS - LIDAR

LEGEND

- Site Boundary
- Major Contour (1.0m interval)
- Minor Contour (0.25m interval)
- Flagstone Creek Centreline
- 50m Centreline Waterway Buffer
- 100m Centreline Waterway Buffer
- Approx High Bank - Derived from Slope analysis utilising lidar data
- 50m High Bank Offset
- 1 in 5 ARI
- Riparian Zone
- Linear Park
- Remnant Endangered Mapping
- Staging Boundary
- Stage No.
- Q100

DEVELOPMENT STATISTICS - Stage 3			
RESIDENTIAL ALLOTMENTS	No. Lots	%	Net Area
Terrace Lots	7	12.5%	0.169 ha
Vila Lots	30	53.6%	0.909 ha
Premium Villa Lots	10	17.9%	0.375 ha
Courtyard Lots	9	16.1%	0.395 ha
Total Residential Allotments	56	100.0%	1.848 ha
Land Budget	Area (Ha)	%	
Area of Subject Site / Stage	4.997 ha	—	
Net Residential Area (no roads)	1.848 ha	37.0%	
Linear Park	2.133 ha	42.7%	
Road Areas	1.016 ha	20.3%	
Total	4.997 ha	100.0%	
Average Lot Size (m²)	330 m²		
Length of New Road	655 m		

RP DESCRIPTION: Lot 30 on SP309195

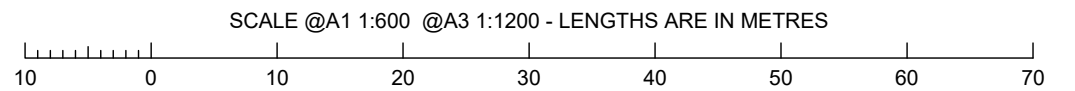

STAGING PLAN - STAGE 4

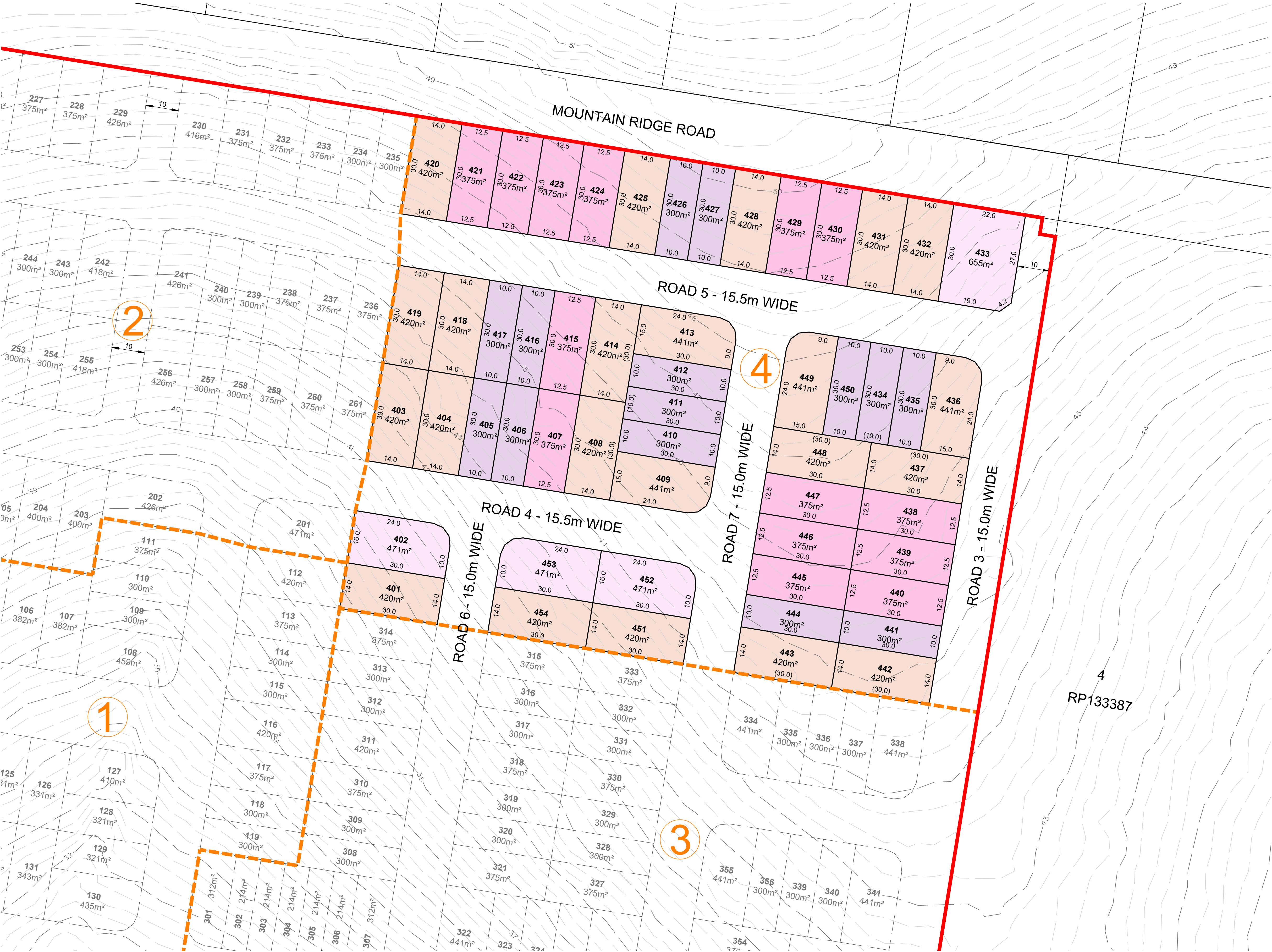

NOT TO BE USED FOR ENGINEERING DESIGN
OR CONSTRUCTION

NOTES

This plan was prepared as a provisional layout to accompany a development application. The information on this plan is not suitable for any other purpose.

Property dimensions, areas, numbers of lots and contours and other physical features shown have been compiled from existing information and may not have been verified by field survey. These may need verification if the development application is approved and development proceeds, and may change when a full survey is undertaken or in order to comply with development approval conditions.

No reliance should be placed on the information on this plan for detailed subdivision design or for any financial dealings involving the land.

Pavements and centrelines shown are indicative only and are subject to Engineering Design.

Saunders Havill Group therefore disclaims any liability for any loss or damage whatsoever or howsoever incurred, arising from any party using or relying upon this plan for any purpose other than as a document prepared for the sole purpose of accompanying a development application and which may be subject to alteration beyond the control of the Saunders Havill Group. Unless a development approval states otherwise, this is not an approved plan.

DCDB © State of Queensland (Department of Natural Resources and Mines) 2019.
Lidar Data © State of Queensland (Department of Natural Resources and Mines) 2016.

* This note is an integral part of this plan/data. Reproduction of this plan or any part of it without this note being included in full will render the information shown on such reproduction invalid and not suitable for use.

PROJECTION: SURVEY COORDINATES
SUBJECT BOUNDARIES: LOT CALCULATIONS FROM SAUNDERS
HAVILL GROUP DATED 09/05/2023
CONTOURS: ELVIS - LIDAR

LEGEND

- Site Boundary
- Major Contour (1.0m interval)
- Minor Contour (0.25m interval)
- Staging Boundary
- Stage No.

PLANS AND DOCUMENTS
referred to in the PDA
DEVELOPMENT APPROVAL

Approval no: DEV2019/1013/8
Date: 09 May 2024



DEVELOPMENT STATISTICS - Stage 4			
RESIDENTIAL ALLOTMENTS	No. Lots	%	Net Area
Vila Lots	14	25.9%	0.420 ha
Premium Villa Lots	14	25.9%	0.525 ha
Courtyard Lots	22	40.7%	0.933 ha
Premium Courtyard Lots	4	7.4%	0.207 ha
Total Residential Allotments	54	100.0%	2.085 ha
Land Budget			
Area of Subject Site / Stage	2.954 ha	—	
Net Residential Area (no roads)	2.085 ha	70.6%	
Road Areas	0.869 ha	29.4%	
Total	2.954 ha	100.0%	
Average Lot Size (m ²)	386 m ²		
Length of New Road	555 m		

RP DESCRIPTION: Lot 30 on SP309195

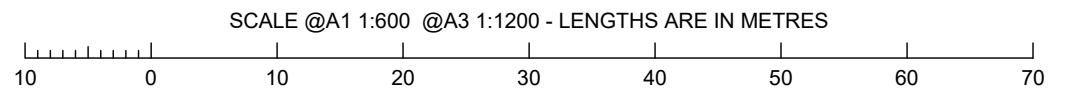

DALEFORD PROPERTY PTY LTD

STAGING PLAN - STAGE 5

NOT TO BE USED FOR ENGINEERING DESIGN
OR CONSTRUCTION

NOTES

This plan was prepared as a provisional layout to accompany a development application. The information on this plan is not suitable for any other purpose.

Property dimensions, areas, numbers of lots and contours and other physical features shown have been compiled from existing information and may not have been verified by field survey. These may need verification if the development application is approved and development proceeds, and may change when a full survey is undertaken or in order to comply with development approval conditions.

No reliance should be placed on the information on this plan for detailed subdivision design or for any financial dealings involving the land.

Pavements and centrelines shown are indicative only and are subject to Engineering Design.

Saunders Havill Group therefore disclaims any liability for any loss or damage whatsoever or howsoever incurred, arising from any party using or relying upon this plan for any purpose other than as a document prepared for the sole purpose of accompanying a development application and which may be subject to alteration beyond the control of the Saunders Havill Group. Unless a development approval states otherwise, this is not an approved plan.

DCDB © State of Queensland (Department of Natural Resources and Mines) 2019.
Lidar Data © State of Queensland (Department of Natural Resources and Mines) 2016.

* This note is an integral part of this plan/data. Reproduction of this plan or any part of it without this note being included in full will render the information shown on such reproduction invalid and not suitable for use.

PROJECTION: SURVEY COORDINATES
SUBJECT BOUNDARIES: LOT CALCULATIONS FROM SAUNDERS
HAVILL GROUP DATED 09/05/2023
CONTOURS: ELVIS - LIDAR

LEGEND

- Site Boundary
- Major Contour (1.0m interval)
- Minor Contour (0.25m interval)
- Flagstone Creek Centreline
- 50m Centreline Waterway Buffer
- 100m Centreline Waterway Buffer
- Approx High Bank - Derived from Slope analysis utilising lidar data
- 50m High Bank Offset
- 1 in 5 ARI
- Riparian Zone
- Linear Park
- Remnant Endangered Mapping
- Staging Boundary
- Stage No.
- Q100

PLANS AND DOCUMENTS
referred to in the PDA
DEVELOPMENT APPROVAL

Approval no: DEV2019/1013/8
Date: 09 May 2024



DEVELOPMENT STATISTICS - Stage 5			
RESIDENTIAL ALLOTMENTS	No. Lots	%	Net Area
Vila Lots	17	33.3%	0.517 ha
Premium Villa Lots	19	37.3%	0.717 ha
Courtyard Lots	14	27.5%	0.613 ha
Premium Courtyard Lots	1	2.0%	0.057 ha
Total Residential Allotments	51	100.0%	1.904 ha
Land Budget	Area (Ha)	%	
Area of Subject Site / Stage	—		
Net Residential Area (no roads)	1.904 ha	48.1%	
Linear Park	0.870 ha	22.0%	
Road Areas	0.905 ha	22.9%	
Child Care Centre	0.279 ha	7.0%	
Total	3.958 ha	100.0%	
Average Lot Size (m²)	373 m²		
Length of New Road	485 m		

RP DESCRIPTION: Lot 30 on SP309195

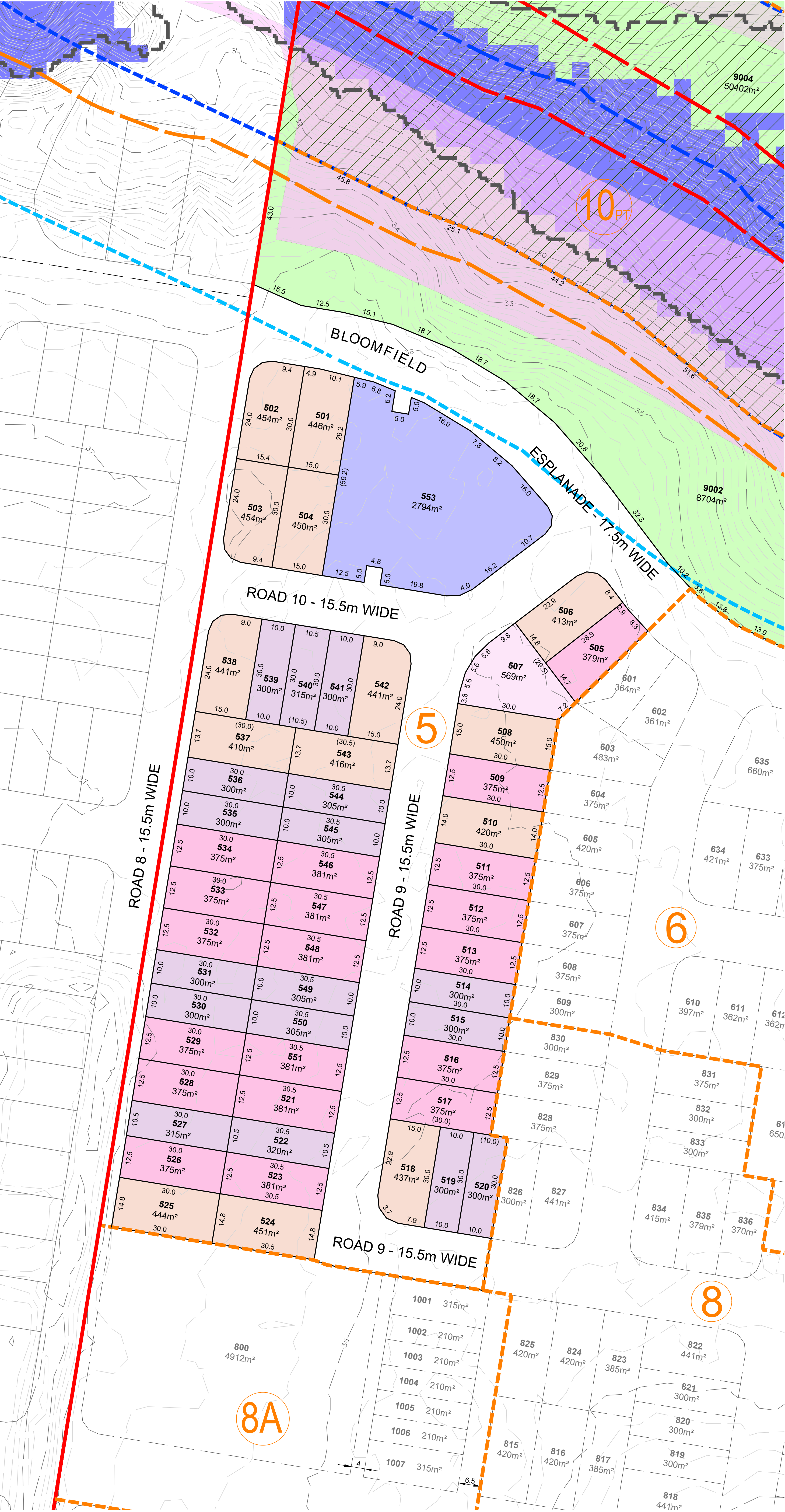
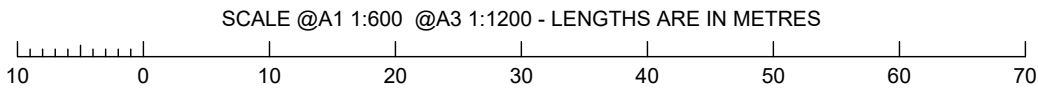

STAGING PLAN - STAGE 6

NOT TO BE USED FOR ENGINEERING DESIGN
OR CONSTRUCTION

NOTES

This plan was prepared as a provisional layout to accompany a development application. The information on this plan is not suitable for any other purpose.

Property dimensions, areas, numbers of lots and contours and other physical features shown have been compiled from existing information and may not have been verified by field survey. These may need verification if the development application is approved and development proceeds, and may change when a full survey is undertaken or in order to comply with development approval conditions.

No reliance should be placed on the information on this plan for detailed subdivision design or for any financial dealings involving the land.

Pavements and centrelines shown are indicative only and are subject to Engineering Design.

Saunders Havill Group therefore disclaims any liability for any loss or damage whatsoever or howsoever incurred, arising from any party using or relying upon this plan for any purpose other than as a document prepared for the sole purpose of accompanying a development application and which may be subject to alteration beyond the control of the Saunders Havill Group. Unless a development approval states otherwise, this is not an approved plan.

DCDB © State of Queensland (Department of Natural Resources and Mines) 2019.
Lidar Data © State of Queensland (Department of Natural Resources and Mines) 2016.

* This note is an integral part of this plan/data. Reproduction of this plan or any part of it without this note being included in full will render the information shown on such reproduction invalid and not suitable for use.

PROJECTION: SURVEY COORDINATES
SUBJECT BOUNDARIES: LOT CALCULATIONS FROM SAUNDERS
HAVILL GROUP DATED 09/05/2023
CONTOURS: ELVIS - LIDAR

LEGEND

- Site Boundary
- Major Contour (1.0m interval)
- Minor Contour (0.25m interval)
- Flagstone Creek Centreline
- 50m Centreline Waterway Buffer
- 100m Centreline Waterway Buffer
- Approx High Bank - Derived from Slope analysis utilising lidar data
- 50m High Bank Offset
- 1 in 5 ARI
- Riparian Zone
- Linear Park
- Remnant Endangered Mapping
- Staging Boundary
- Stage No.
- Q100
- Potential Multiple Residential Allotment

DEVELOPMENT STATISTICS - Stage 6			
RESIDENTIAL ALLOTMENTS	No. Lots	%	Net Area
Villa Lots	15	28.3%	0.451 ha
Premium Villa Lots	19	35.8%	0.757 ha
Courtyard Lots	16	30.2%	0.678 ha
Premium Courtyard Lots	3	5.7%	0.185 ha
Total Residential Allotments	53	100.0%	2.071 ha
Land Budget	Area (Ha)	%	
Area of Subject Site / Stage	5.161 ha		
Net Residential Area (no roads)	2.071 ha	40.1%	
Linear Park	1.904 ha	36.9%	
Road Areas	1.186 ha	23.0%	
Total	5.161 ha	100.0%	
Average Lot Size (m ²)	391 m ²		
Length of New Road	653 m		

RP DESCRIPTION: Lot 30 on SP309195

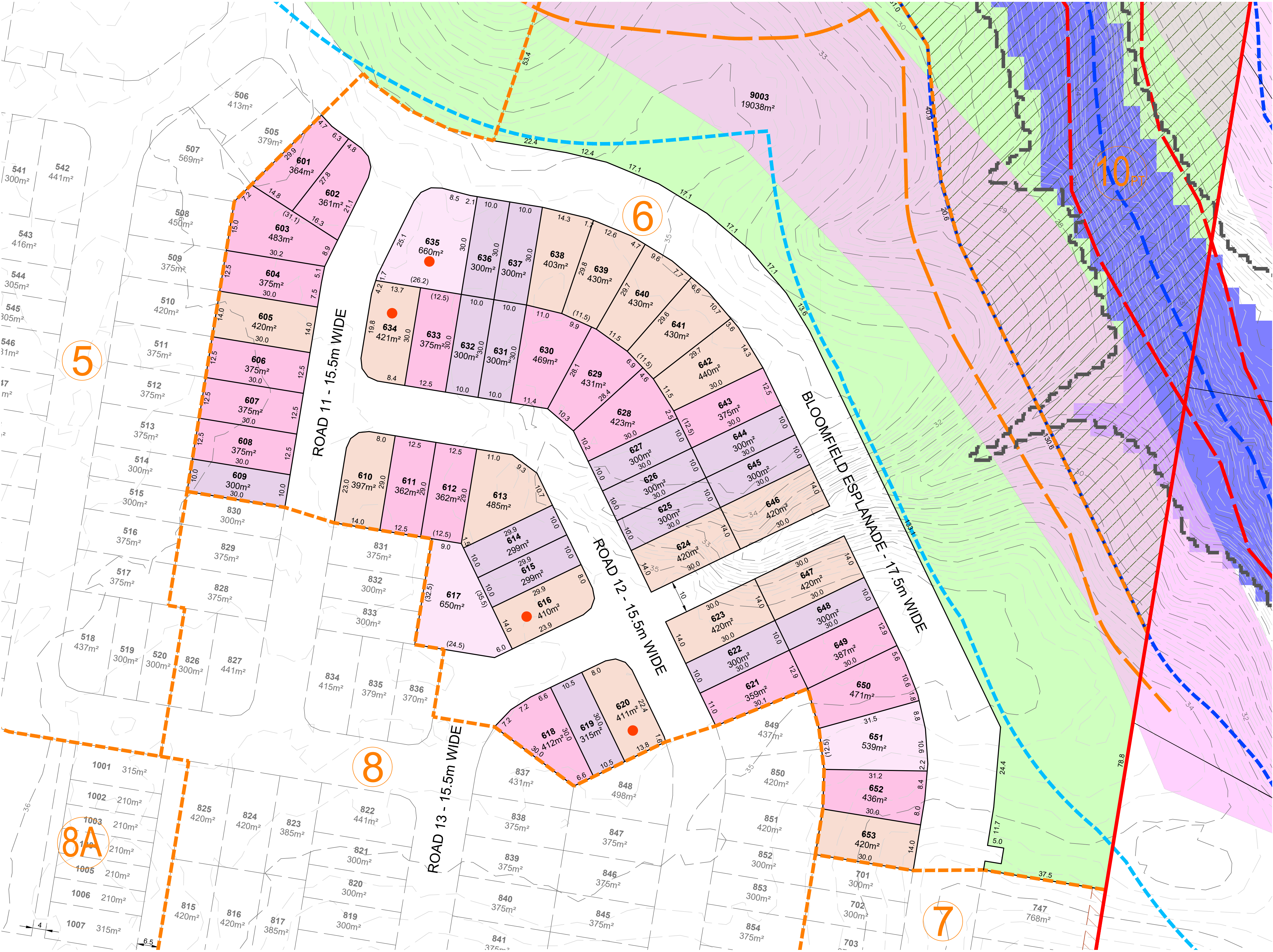
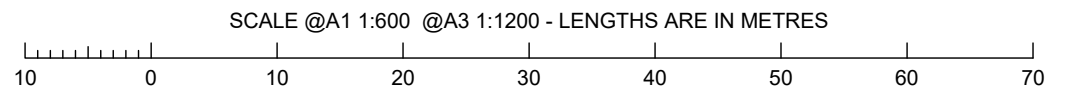

PLANS AND DOCUMENTS
referred to in the PDA
DEVELOPMENT APPROVAL

Approval no: DEV2019/1013/8
Date: 09 May 2024

Queensland
Government

STAGING PLAN - STAGE 7

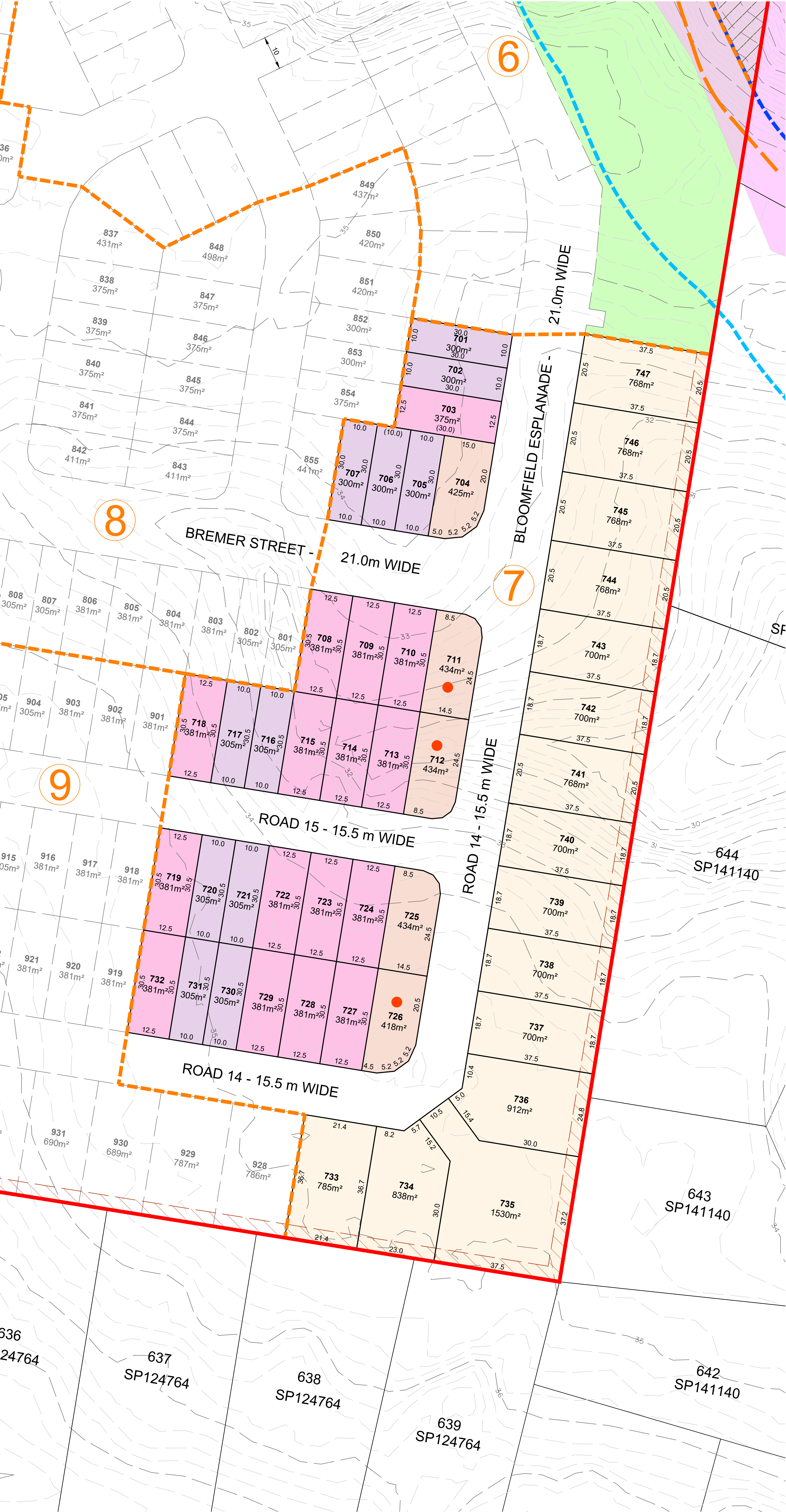

NOT TO BE USED FOR ENGINEERING DESIGN
OR CONSTRUCTION

NOTES

This plan was prepared as a provisional layout to accompany a development application. The information on this plan is not suitable for any other purpose.

Property dimensions, areas, numbers of lots and contours and other physical features shown have been compiled from existing information and may not have been verified by field survey. These may need verification if the development application is approved and development proceeds, and may change when a full survey is undertaken or in order to comply with development approval conditions.

No reliance should be placed on the information on this plan for detailed subdivision design or for any financial dealings involving the land.

Pavements and centrelines shown are indicative only and are subject to Engineering Design.

Saunders Havill Group therefore disclaims any liability for any loss or damage whatsoever or howsoever incurred, arising from any party using or relying upon this plan for any purpose other than as a document prepared for the sole purpose of accompanying a development application and which may be subject to alteration beyond the control of the Saunders Havill Group. Unless a development approval states otherwise, this is not an approved plan.

DCDB © State of Queensland (Department of Natural Resources and Mines) 2019.
Lidar Data © State of Queensland (Department of Natural Resources and Mines) 2016.

* This note is an integral part of this plan/data. Reproduction of this plan or any part of it without this note being included in full will render the information shown on such reproduction invalid and not suitable for use.

PROJECTION: SURVEY COORDINATES
SUBJECT BOUNDARIES: LOT CALCULATIONS FROM SAUNDERS
HAVILL GROUP DATED 09/05/2023
CONTOURS: ELVIS - LIDAR

LEGEND

- Site Boundary
- Major Contour (1.0m interval)
- Minor Contour (0.25m interval)
- 50m Centreline Waterway Buffer
- 100m Centreline Waterway Buffer
- 50m High Bank Offset
- Riparian Zone
- Linear Park
- Remnant Endangered Mapping
- Staging Boundary
- Stage No.
- 4m wide Landscape Interface Buffer
- Potential Multiple Residential Allotment

PLANS AND DOCUMENTS
referred to in the PDA
DEVELOPMENT APPROVAL

Approval no: DEV2019/1013/8
Date: 09 May 2024



DEVELOPMENT STATISTICS - Stage 7			
RESIDENTIAL ALLOTMENTS	No. Lots	%	Net Area
Villa Lots	11	23.4%	0.333 ha
Premium Villa Lots	16	34.0%	0.609 ha
Courtyard Lots	5	10.6%	0.214 ha
Interface Lots	15	31.9%	1.211 ha
Total Residential Allotments	47	100.0%	2.367 ha
Land Budget	Area (Ha)	%	
Area of Subject Site / Stage	3.138 ha		
Net Residential Area (no roads)	2.367 ha	75.4%	
Road Areas	0.771 ha	24.6%	
Total	3.138 ha	100.0%	
Average Lot Size (m²)	504 m²		
Length of New Road	447 m		

RP DESCRIPTION: Lot 30 on SP309195

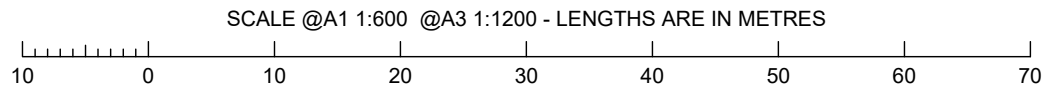

DALEFORD PROPERTY PTY LTD

STAGING PLAN - STAGE 8 & 8A

NOT TO BE USED FOR ENGINEERING DESIGN
OR CONSTRUCTION

NOTES

This plan was prepared as a provisional layout to accompany a development application. The information on this plan is not suitable for any other purpose.

Property dimensions, areas, numbers of lots and contours and other physical features shown have been compiled from existing information and may not have been verified by field survey. These may need verification if the development application is approved and development proceeds, and may change when a full survey is undertaken or in order to comply with development approval conditions.

No reliance should be placed on the information on this plan for detailed subdivision design or for any financial dealings involving the land.

Pavements and centrelines shown are indicative only and are subject to Engineering Design.

Saunders Havill Group therefore disclaims any liability for any loss or damage whatsoever or howsoever incurred, arising from any party using or relying upon this plan for any purpose other than as a document prepared for the sole purpose of accompanying a development application and which may be subject to alteration beyond the control of the Saunders Havill Group. Unless a development approval states otherwise, this is not an approved plan.

DCDB © State of Queensland (Department of Natural Resources and Mines) 2019.
Lidar Data © State of Queensland (Department of Natural Resources and Mines) 2016.

* This note is an integral part of this plan/data. Reproduction of this plan or any part of it without this note being included in full will render the information shown on such reproduction invalid and not suitable for use.

PROJECTION: SURVEY COORDINATES
SUBJECT BOUNDARIES: LOT CALCULATIONS FROM SAUNDERS
HAVILL GROUP DATED 09/05/2023
CONTOURS: ELVIS - LIDAR

LEGEND

- Site Boundary
- Major Contour (1.0m interval)
- Minor Contour (0.25m interval)
- 100m Centreline Waterway Buffer
- Linear Park
- Staging Boundary
- Stage No.
- Potential Multiple Residential Allotment

DEVELOPMENT STATISTICS - Stage 8			
RESIDENTIAL ALLOTMENTS	No. Lots	%	Net Area
Villa Lots	14	25.5%	0.422 ha
Premium Villa Lots	25	45.5%	0.955 ha
Courtyard Lots	15	27.3%	0.641 ha
Premium Courtyard Lots	1	1.8%	0.050 ha
Total Residential Allotments	55	100.0%	2.068 ha
Land Budget	Area (Ha)	%	
Area of Subject Site / Stage	2.997 ha		
Net Residential Area (no roads)	2.068 ha	69.0%	
Road Areas	0.929 ha	31.0%	
Total	2.997 ha	100.0%	
Average Lot Size (m ²)	376 m ²		
Length of New Road	534 m		

DEVELOPMENT STATISTICS - Stage 8A			
RESIDENTIAL ALLOTMENTS	No. Lots	%	Net Area
Laneway Terrace Lots	7	100.0%	0.168 ha
Total Residential Allotments	7	100.0%	0.168 ha
Land Budget	Area (Ha)	%	
Area of Subject Site / Stage	1.003 ha	0.0%	
Net Residential Area (no roads)	0.168 ha	0.0%	
Neighbourhood Recreation Park	0.491 ha	0.0%	
Road Areas	0.344 ha	0.0%	
Total	1.003 ha	0.0%	
Average Lot Size (m ²)	240 m ²		
Length of New Road	123 m		

RP DESCRIPTION: Lot 30 on SP309195

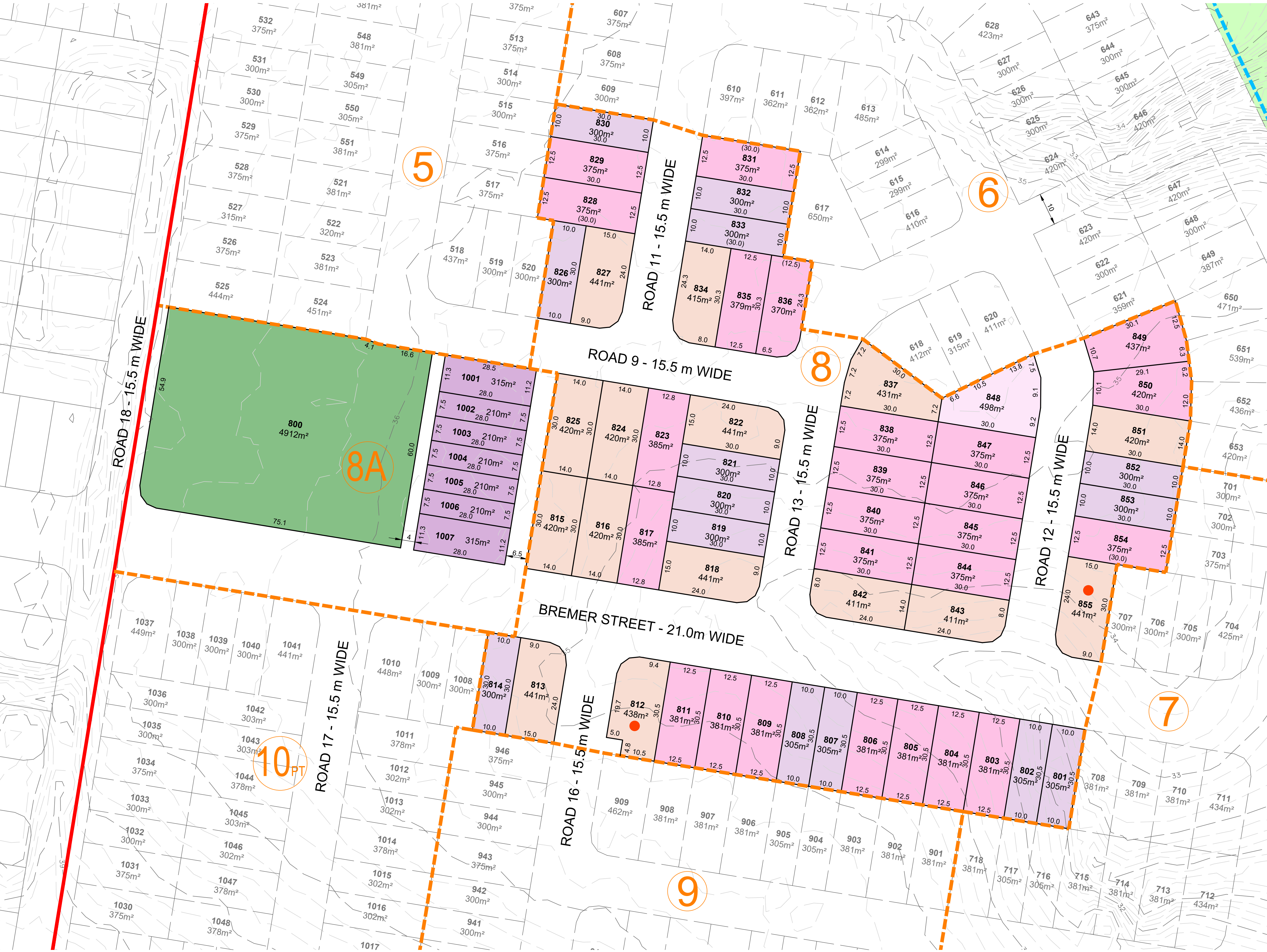
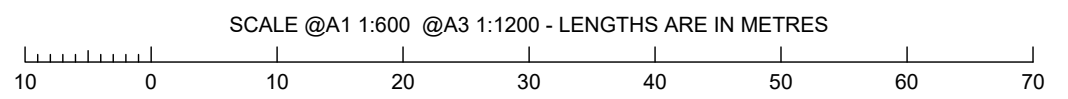

PLANS AND DOCUMENTS
referred to in the PDA
DEVELOPMENT APPROVAL
Approval no: DEV2019/1013/8
Date: 09 May 2024

STAGING PLAN - STAGE 9

NOT TO BE USED FOR ENGINEERING DESIGN
OR CONSTRUCTION

NOTES

This plan was prepared as a provisional layout to accompany a development application. The information on this plan is not suitable for any other purpose.

Property dimensions, areas, numbers of lots and contours and other physical features shown have been compiled from existing information and may not have been verified by field survey. These may need verification if the development application is approved and development proceeds, and may change when a full survey is undertaken or in order to comply with development approval conditions.

No reliance should be placed on the information on this plan for detailed subdivision design or for any financial dealings involving the land.

Pavements and centrelines shown are indicative only and are subject to Engineering Design.

Saunders Havill Group therefore disclaims any liability for any loss or damage whatsoever or howsoever incurred, arising from any party using or relying upon this plan for any purpose other than as a document prepared for the sole purpose of accompanying a development application and which may be subject to alteration beyond the control of the Saunders Havill Group. Unless a development approval states otherwise, this is not an approved plan.

DCDB © State of Queensland (Department of Natural Resources and Mines) 2019.
Lidar Data © State of Queensland (Department of Natural Resources and Mines) 2016.

* This note is an integral part of this plan/data. Reproduction of this plan or any part of it without this note being included in full will render the information shown on such reproduction invalid and not suitable for use.

PROJECTION: SURVEY COORDINATES
SUBJECT BOUNDARIES: LOT CALCULATIONS FROM SAUNDERS
HAVILL GROUP DATED 09/05/2023
CONTOURS: ELVIS - LIDAR

LEGEND

- Site Boundary
- Major Contour (1.0m interval)
- Minor Contour (0.25m interval)
- Staging Boundary
- Stage No.
- 4m wide Landscape Interface Buffer
- Potential Multiple Residential Allotment

DEVELOPMENT STATISTICS - Stage 9			
RESIDENTIAL ALLOTMENTS	No. Lots	%	Net Area
Vila Lots	11	23.9%	0.333 ha
Premium Villa Lots	21	45.7%	0.799 ha
Courtyard Lots	4	8.7%	0.183 ha
Interface Lots	10	21.7%	0.741 ha
Total Residential Allotments	46	100.0%	2.056 ha
Land Budget	Area (Ha)	%	
Area of Subject Site / Stage	2.626 ha		
Net Residential Area (no roads)	2.056 ha	78.3%	
Road Areas	0.570 ha	21.7%	
Total	2.626 ha	100.0%	
Average Lot Size (m ²)	447 m ²		
Length of New Road	363 m		

RP DESCRIPTION: Lot 30 on SP309195

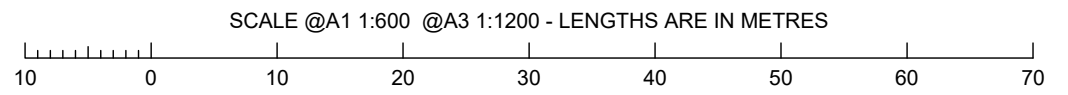

DALEFORD PROPERTY PTY LTD

MOUNTAIN RIDGE ROAD, SOUTH MACLEAN 02/04/2024 9534 P 03 Rev Z -STG 09

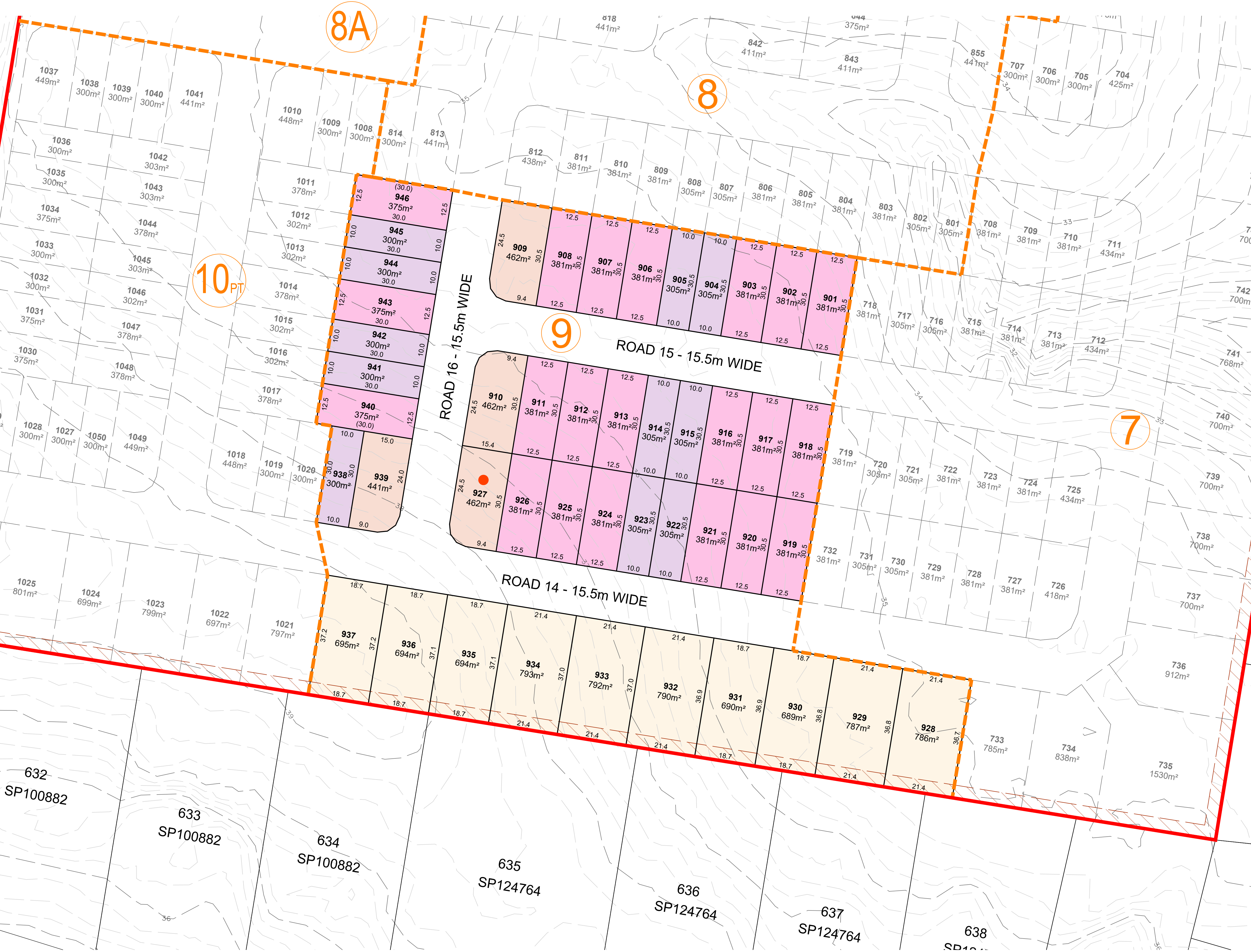

PLANS AND DOCUMENTS
referred to in the PDA
DEVELOPMENT APPROVAL

Approval no: DEV2019/1013/8
Date: 09 May 2024

Queensland
Government

STAGING PLAN - STAGE 10

NOT TO BE USED FOR ENGINEERING DESIGN
OR CONSTRUCTION

NOTES

This plan was prepared as a provisional layout to accompany a development application. The information on this plan is not suitable for any other purpose.

Property dimensions, areas, numbers of lots and contours and other physical features shown have been compiled from existing information and may not have been verified by field survey. These may need verification if the development application is approved and development proceeds, and may change when a full survey is undertaken or in order to comply with development approval conditions.

No reliance should be placed on the information on this plan for detailed subdivision design or for any financial dealings involving the land.

Pavements and centrelines shown are indicative only and are subject to Engineering Design.

Saunders Havill Group therefore disclaims any liability for any loss or damage whatsoever or howsoever incurred, arising from any party using or relying upon this plan for any purpose other than as a document prepared for the sole purpose of accompanying a development application and which may be subject to alteration beyond the control of the Saunders Havill Group. Unless a development approval states otherwise, this is not an approved plan.

DCDB © State of Queensland (Department of Natural Resources and Mines) 2019.
Lidar Data © State of Queensland (Department of Natural Resources and Mines) 2016.

* This note is an integral part of this plan/data. Reproduction of this plan or any part of it without this note being included in full will render the information shown on such reproduction invalid and not suitable for use.

PROJECTION: SURVEY COORDINATES
SUBJECT BOUNDARIES: LOT CALCULATIONS FROM SAUNDERS
HAVILL GROUP DATED 09/05/2023
CONTOURS: ELVIS - LIDAR

LEGEND

- Site Boundary
- Major Contour (1.0m interval)
- Minor Contour (0.25m interval)
- Staging Boundary
- Stage No.
- 4m wide Landscape Interface Buffer
- Potential Multiple Residential Allotment

PLANS AND DOCUMENTS
referred to in the PDA
DEVELOPMENT APPROVAL

Approval no: DEV2019/1013/8
Date: 09 May 2024

Queensland
Government

NOTE:

Stage 10 includes the remainder of the Linear Park with
Riparian Zone overlay of 5.04ha as shown on Overall
Concept Plan, Drawing No. 9534 P 03 Rev Z - PRO 01

DEVELOPMENT STATISTICS - Stage 10			
RESIDENTIAL ALLOTMENTS	No. Lots	%	Net Area
Vila Lots	22	51.2%	0.662 ha
Premium Villa Lots	9	20.9%	0.339 ha
Courtyard Lots	6	14.0%	0.268 ha
Interface Lots	6	14.0%	0.452 ha
Total Residential Allotments	43	100.0%	1.721 ha
Land Budget	Area (Ha)	%	
Area of Subject Site / Stage	7.217 ha		
Net Residential Area (no roads)	1.721 ha	23.8%	
Linear Park	5.040 ha	69.8%	
Road Areas	0.456 ha	6.3%	
Total	7.217 ha	100.0%	
Average Lot Size (m²)	400 m²		
Length of New Road	248 m		

RP DESCRIPTION: Lot 30 on SP309195

