

Appendix C

Staging Plan

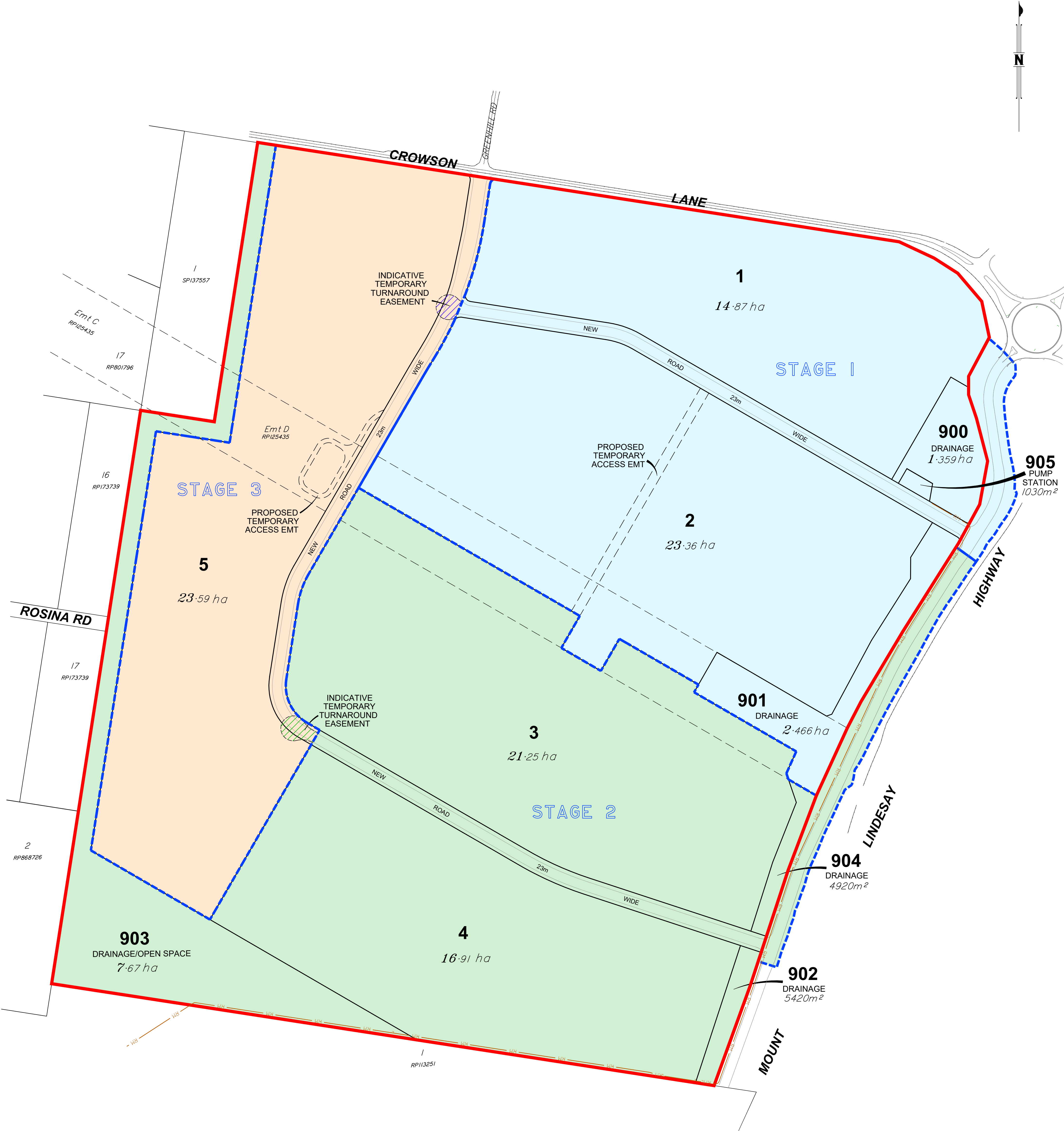



Notes

- Any licence, express or implied, to use this document for any purpose whatsoever is restricted to the terms of the agreement or implied agreement between Wolter Consulting Group and the instructing party.
- Design subject to local authority approval & detailed engineering requirements, areas and dimensions are approximate only and are subject to survey. Therefore this drawing is not to be used for engineering design.
- Cadastral data supplied by others and is approximate only.
- Earthworks for Sewer Rising Main and full service road will be completed with Stage 1.
- Indicative road horizontal design, subject to biopods and engineering review.
- This note is an integral part of this plan. This plan may not be reproduced without this notation being included.

PLANS AND DOCUMENTS referred to in the PDA DEVELOPMENT APPROVAL
Approval no.: **DEV2018/961/8**
Date: **27/09/2023**

Legend	
	Site Boundary
	Stage Boundary
	Stage 1
	Stage 2
	Stage 3
	Indicative Temporary Turnaround - Stage 1
	Indicative Temporary Turnaround - Stage 2
	Indicative Temporary Turnaround - Stage 3
	Sewer Rising Main

WOLTER
consulting group

Scale 1:2500 @ A1 - Lengths are in metres.

Planning Urban Design Landscape Environment Surveying

Staging Sketch Plan
4499-4651 Mount Lindesay Highway
Description Local Authority Lot 39 on SP258739 Logan City

CLIENT
Charter Hall Group

DRAWING NO. 22-0007P/01-03 VERSION E
DATE DRAWN 14-08-2023 SHEET NO. 1 of 1