

STAGE 3

Sheet 2 of 2

PO Box 5021, GCMC QLD 9726
Ph: (07) 5631 8000
mail@bennettandbennett.com.au

Surveying, Town Planning & Spatial Services
GOLD COAST | BRISBANE | SUNSHINE COAST | NORTHERN RIVERS
www.bennettandbennett.com.au

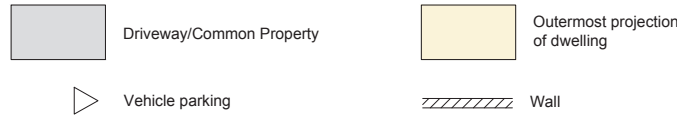

LEGEND

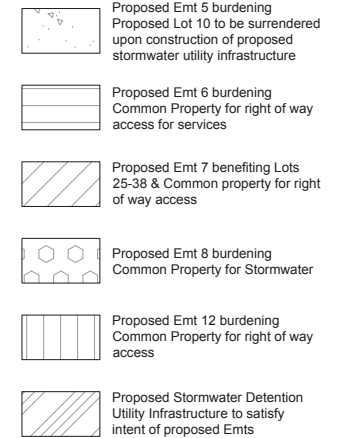

Total Area 3040m²

NOTES:

1. Drawn to scale on an A3 sheet.
2. All dimensions and areas are subject to final survey, construction and approval by EDQ.
3. Meridian SP300888.
4. Architectural information based on drawings I50-30, 200-30, 200-31, 200-32 & 200-33 provided by Arkhefield on 15-12-2022.

F	Area added	BRJ	23/02/2023
E	DEV 2022/1331 Further Issues	BRJ	19/12/2022
D	Issue for DA 31-8-2002	BRJ	2/09/2022
C	Boundary & Buildings Revised	BRJ	27/07/2022
B	Dimensions Added & Building	DAR	23/03/2022
Detail Sheet 2			
A	Original Issue	DAR	24/01/2022
Issue	Revision	Int	Date

Plan of Proposed Subdivision of Lots 25-38 & Common Property (SP338067)

Cancelling Lot 10 (being part of Lot 3 on SP300888)

Client: **BENNETT & ASSOCIATES**

Locality:	YERONGA		
Local Gov:	BCC	Prepared By:	DAR
Surveyed By:		Approved:	CS
Date Created:	24/01/2022	Scale:	1:100
Comp File:	211537.project		
Plan No:	211537_004_PRO		

PLANS AND DOCUMENTS referred to in the PDA DEVELOPMENT APPROVAL

Approval no: DEV2022/1331
Date: 1 June 2023

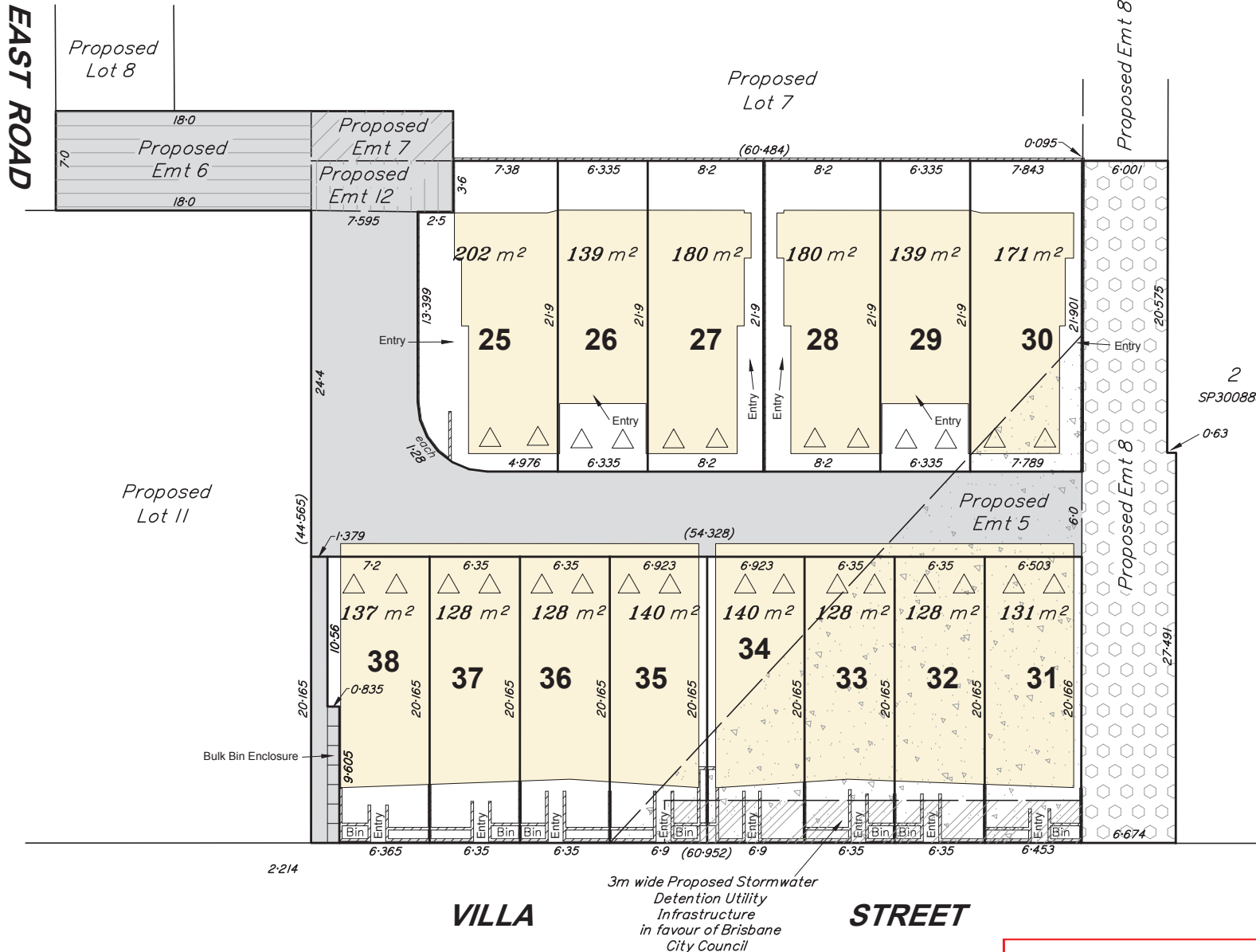

3m wide Proposed Stormwater Detention Utility Infrastructure in favour of Brisbane City Council

Scale 1:300

