

04 LANDSCAPE APPROACH

04.3 A RESILIENT AND LUSH PALETTE

The proposed palette combines species that are resilient to wind exposed, on podium conditions, whilst still creating a lush and vibrant landscape effect within the gardens and the street.

Trees species have been selected to have a dense canopy for shade and wind protection, and clear trunk to maintain sight lines. The species selected match the established trees on site. Epiphytic plants will be attached to the trunks, providing an interesting accent to the palette and referencing original species of the riverine scrub that once prevailed along the Northshore.

Feature shrubs and flowy grasses placed in clusters of three will provide texture, volume, and scale to portions of the gardens. The scattering of these will allow visual permeability to be maintained.

Climbers, ground covers and drapers perform an essential role to soften planter walls, trail over the trellis, awnings and posts and cascade overhead.

Climber species reference the thick vine forests native to this area and become the accent of the palette, as a draping, flowering canopy overhead.

TREES



Botanical Name
Podocarpus laurifolius
Common Name
Karoaka Gum



Botanical Name
Wickstroemia rubicunda 'green avenue'
Common Name
Weeping Lily Pilly

DRAPERS



Botanical Name
Juniperus conferta
Common Name
Shore Juniper



Botanical Name
Myrsine javanica
Common Name
Creeping Boobialla



Botanical Name
Phyllanthus cordobensis
Common Name
Vietnam Leaf Flower



Botanical Name
Ruscus sparganii
Common Name
Fountain Bush

FEATURE SHRUBS



Botanical Name
Alpinia nutans
Common Name
False Cardamom Ginger



Botanical Name
Carissa macrocarpa
Common Name
Hawai Plum



Botanical Name
Dorstenia peltata
Common Name
Giant Spider Lily



Botanical Name
Lomandra longifolia
Common Name
Basket Grass



Botanical Name
Westringia rubicosa
Common Name
Native Rosemary



Botanical Name
Ficus microcarpa 'Green Island'
Common Name
Green Island Ficus



Botanical Name
Kalanchoe baccata
Common Name
Blue Teaspoons



Botanical Name
Pittosporum tobira
Common Name
Mica Muffin

SMALL CLUSTERS

GROUND COVERS



Botanical Name
Dichondra silver falls
Common Name
Silver Falls



Botanical Name
Dichondra repens
Common Name
Kilbey Weed



Botanical Name
Viola hederacea
Common Name
Native Violet



Botanical Name
Zoysa tenuifolia
Common Name
Korean Carpet Grass



Botanical Name
Pholidotum amabile
Common Name
Saxifrage

CLIMBERS



Botanical Name
Chromolaena fragrans
Common Name
Native Frangipani



Botanical Name
Cissampelos grandis
Common Name
Kangaroo Vine



Botanical Name
Pisonia lemnocladia 'Lady Dr'
Common Name
Bower Vine



Botanical Name
Stephanandra rotundifolia
Common Name
Madagascar Jasmine

EPIPHYTIC



PLA Pilot
Botanical Name
Polypodium elongatum
Common Name
Tape Fern



PLA Pilot
Botanical Name
Polypodium bifurcatum
Common Name
Elkhorn Fern



PLA Pilot
Botanical Name
Polypodium superbum
Common Name
Staghorn Fern

PLANS AND DOCUMENTS
referred to in the PDA
DEVELOPMENT APPROVAL

Approval no: DEV2022/1357

Date: 22/03/2023



04 LANDSCAPE APPROACH

04.5 ON PODIUM LANDSCAPE: PLANTER TYPOLOGY 1

Planter typology 1 consists of existing and proposed low level planters -typically 400-500mm high- that act as edges to public spaces, provide a base for seating, and frame LSA's.

This planter typology has limited soil depth and will only contain low level shrubs, climbers, drapers and ground cover species. Given the height of this typology, it will be typically utilised to provide a seating edge as well.

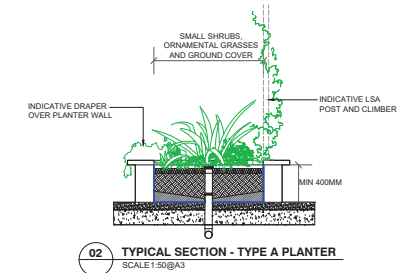
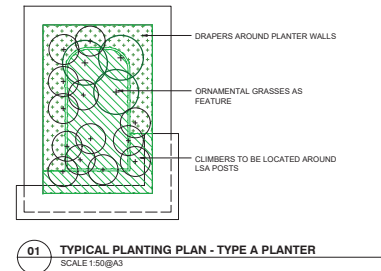

INDICATIVE VIEWS AND DRAWINGS OF PLANTER TYPOLOGY 1. REFER LANDSCAPE DRAWINGS FOR PLANTING PLANS.

04 LANDSCAPE APPROACH

04.6 ON PODIUM LANDSCAPE: PLANTER TYPOLOGY 2

Planter typology 2 consists of existing and proposed multi level planters with stepped walls ranging from 400mm to 1000mm high. The soil within these planters will be mounded to achieve deep zones for canopy trees and low zones to match planter typology 1. The gardens will act as edges to public spaces, provide street trees, places to sit, and frame LSA's.

This planter typology contains enough soil depth for an ex-ground or 400L tree as well as shrubs, climbers, drapers, and ground cover species. Given the height transition of this typology, mounding over a minimum diameter of 2m around the tree will be required to ensure the gradient is gentle enough to hold the landscape.

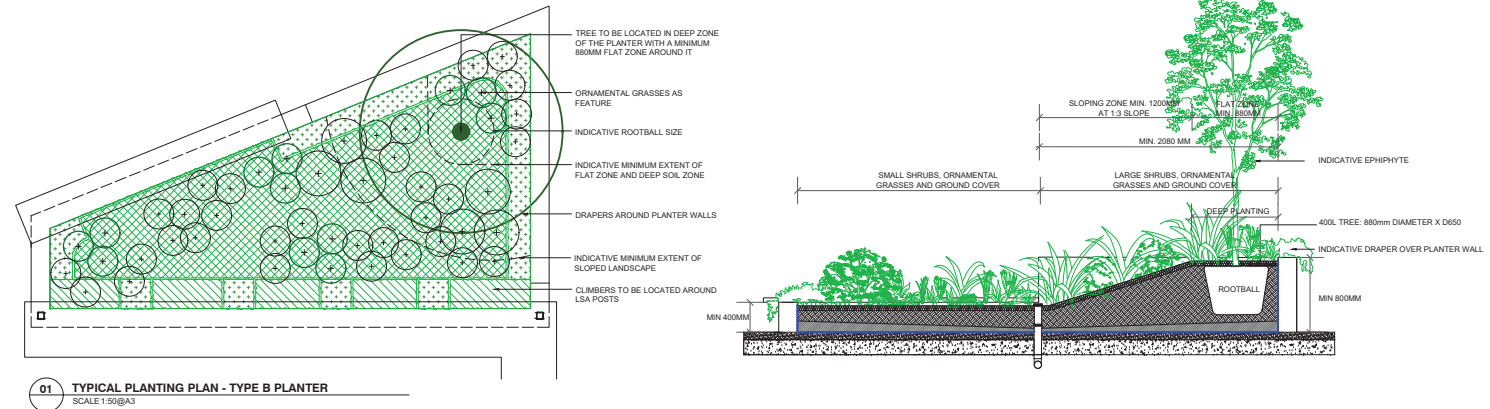

INDICATIVE VIEWS AND DRAWINGS OF PLANTER TYPOLOGY 2. REFER LANDSCAPE DRAWINGS FOR PLANTING PLANS.