

Non-exempt Works Plan 1/4

AMENDED IN RED

By: Chris Hinton

Date: 19 May 2022

 Queensland Government

Date: 19 May 2022



NOTES:

1. REFER LANDSCAPING DRAWINGS FOR DETAILS OF VERGE TREATMENT.
2. FENCING TO BE STRONG ENOUGH TO SUPPORT BANNERS.
3. INSTALL TACTILES TO BCC STANDARDS.

BOUNDARIES			
EXISTING	PROPOSED	FUTURE	
ROADWORKS			
EXISTING	PROPOSED	FUTURE	
	CH270.00		CHAINAGE
			CONTROL LINE
			1.8m HIGH BLACK CHAIN WIRE FENCE
			(2 GATES PER LOT)
			KERB
			TREE TO BE RETAINED
			RETAINING WALL
			BOLLARD
			STREET NAME SIG
			TRAFFIC SIGN
			STREET LIGHTING
			TACTILE INDICATOR: CONCRETE TILES (REFER DOC STD 003 FOR LOCATION AND CONSTRUCTION DETAILS)
			FOOTPATH
			BICYCLE FOOTPATH
			ROAD PAVING INC. PARKING BAYS
			FOOTPATH - PT1 REFER LANDSCAPE ARCHITECT PLANS
			FOOTPATH - PT2 REFER LANDSCAPE ARCHITECT PLANS
			LANDSCAPE BUFFER (4m WIDE)
			BIOPOD (REFER DRAWING NO. 223 AND 224 FOR SETOUT DETAILS)
			ASPHALT MILLING AND RESURFACING ONLY (EXISTING RUNDABOUTS)
EARTHWORKS			
EXISTING	PROPOSED	FUTURE	
	-25.00		MAJOR SURFACE CONTOURS
			MINOR SURFACE CONTOURS
SERVICES			
EXISTING	PROPOSED	FUTURE	
			ELECTRICAL PIT
			ELECTRICITY UG
			ELECTRICITY OH
			GAS
			OPTIC FIBRE
			TELECOMMUNICATION
			SEWER & MAINTENANCE STRUCTURES
			STORMWATER DR (N)
			UNREINFORCED CONCRETE SPOON DRAIN
			WATER
			RECYCLED WATER

NOTES

1. For roadwork notes and details refer drg no. 2521E-01-200.

BEWARE OF UNDERGROUND SERVICES

The locations of underground services are approximate only and their exact position should be proven on site.
No guarantee is given that all existing services are shown. Locate all underground services before commencement of works
DIAL 1100 BEFORE YOU DIG

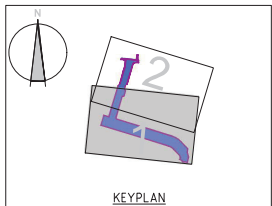

PT	CHAINAGE	EASTING	NORTHING	HEIGHT	BEARING	RAD/SPIRAL	A LENGTH	DEF LANE
PP 1	0+00.0	8075.371	4520.555	3.456	19+07.56.08			
	20+00.0	8075.371	4520.555	3.456	19+07.56.08			
	40+00.0	8085.453	4558.110	3.456	19+07.56.08			
TC	44+40.0	8087.638	4562.901	3.470	19+07.56.08			
	44+56.8	8087.638	4562.901	3.470	19+07.56.08			
PT	44+56.8	8087.638	4562.901	3.470	19+07.56.08			
	45+00.0	8087.638	4562.901	3.470	19+07.56.08			
	50+00.0	8095.729	4578.255	3.546	19+50.00.00	R = 50+100	0.005	0+45.03.53"
	80+00.0	8095.729	4578.255	3.546	19+50.00.00			
PP 3	81+40.0	8095.473	4578.255	3.546	19+50.00.00			

Ag-Port Locations Amended	2/23/23	MG-MS	0053	GP
C. Re-issue for Construction	3/11/23	AC-PM	0041	GP
C. Re-issue for Construction	3/11/23	AY-EG	0036	GP
C. Re-issue for Construction	3/11/23	AC-CE	0034	GP
C. Re-issue for construction	2/29/23	AY-AY	0030	GP
C. Re-issue for construction	2/29/23	AY-AY	0023	GP
C. Cedar Road Swale Drainage Updated	3/27/23	AC-IM	0011	GP
C. Issue for Construction	1/05/23	DRO-0	006	GP
Activity	DATE	DESIGN	WIR	STATUS

RPEQ# 17514

Principal
Economic Development Queensland
1 William Street
Brisbane, 4000

All setting out should be carried out in accordance with GAA/Council's standard drawings or as nominated on hard copy plans provided by SMEC. Any digital information supplied by this office is for information only. Any discrepancies should be discussed with the superintendent.

Project Leader
G. Pereira
Designed
D. Rapson
Drawn
K. McCoy
Checked
D. Rapson
Authorised
G. Pereira
Date
May-2021

Scale @ A1
1:500
0 5 10 20
Scale 1:500



© SMEC Australia Pty Ltd
ABN 47 065 475 140

These designs and drawings are the copyright of SMEC Australia Pty Ltd. The drawing shall not be reproduced or copied, in whole or part, without the written permission of SMEC Australia Pty Ltd. The contents of this drawing are electronically generated, are confidential and may only be used for the purpose for which they are intended.



Northshore, Hamilton
Package 01
Economic Development Queensland
Roadworks
Roadworks Layout Plan
Drawing No. 2521E-01-211
Dev. App. No.
Sheet No. 1 of 2

Rev H

Issue for Construction

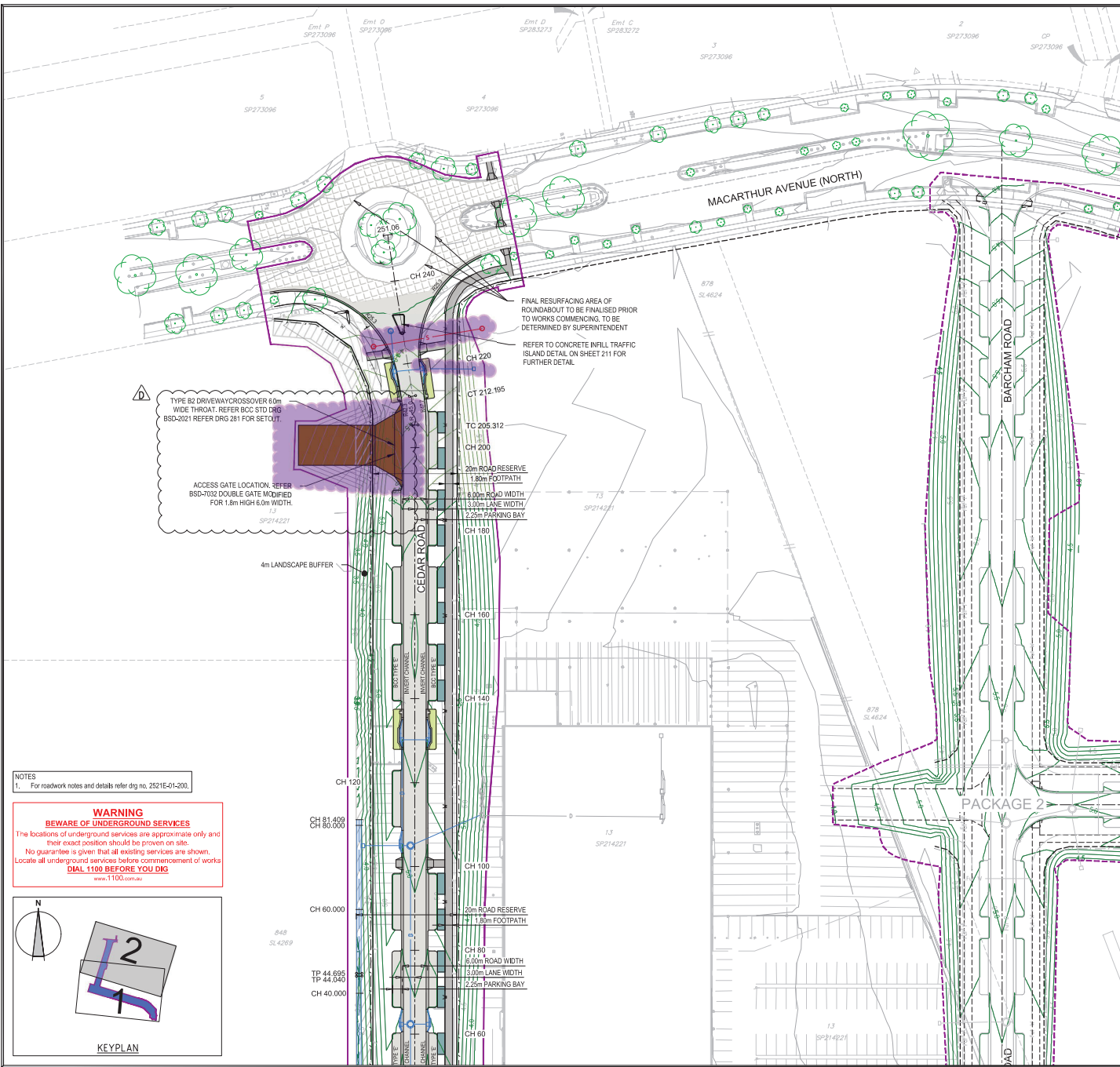

NOTES:
1. REFER LANDSCAPING DRAWINGS FOR DETAILS OF VERGE TREATMENT.
2. FENCING TO BE STRONG ENOUGH TO SUPPORT BANNERS.
3. INSTALL TACTILES TO BCC STANDARDS.

- BOUNDARIES**
EXISTING PROPOSED FUTURE STAGE BOUNDARY
ROAD RESERVE
- ROADWORKS**
EXISTING PROPOSED FUTURE
CH270.00
CHAINAGE
CONTROL LINE
1.8m HIGH BLACK CHAIN WIRE FENCE
(2 GATES PER LOT) REFER BCC STD DRG
BSD-7003
KERB
TREE TO BE RETAINED
BOLLARD
STREET NAME SIGN
TRAFFIC SIGN
STREET LIGHTING
TACTILE INDICATOR CONCRETE TILES
(REFER BCC STD DRGS FOR LOCATION
AND CONSTRUCTION DETAILS)
FOOTPATH
BICYCLE FOOTPATH
ROAD PAVING INCL PARKING
BAYS
FOOTPATH - PT1
REFER LANDSCAPE ARCHITECT PLANS
FOOTPATH - PT2
REFER LANDSCAPE ARCHITECT PLANS
LANDSCAPE BUFFER (4m WIDE)
DRIVEWAYS
BIPOD (REFER DRAWING No. 223 AND 224
FOR SETOUT DETAILS)
ASPHALT MILLING AND RESURFACE
ONLY (EXISTING ROUNDABOUTS)
- EARTHWORKS**
EXISTING PROPOSED FUTURE
-25.0-
MAJOR SURFACE CONTOURS
MINOR SURFACE CONTOURS
- SERVICES**
EXISTING PROPOSED FUTURE
E - Ful E -
ELECTRICITY UG
ELECTRICITY OH
GAS
OPTIC FIBRE
TELECOMMUNICATION
SEWER & MAINTENANCE STRUCTURES
STORMWATER DRAIN
UNREINFORCED CONCRETE SPOON DRAIN
WATER
RECYCLED WATER

NOTES
1. For roadwork notes and details refer dsg no. 2521E-01-200.

WARNING
BEWARE OF UNDERGROUND SERVICES
The locations of underground services are approximate only and their exact position should be proven on site.
No guarantee is given that all existing services are shown.
Locate all underground services before commencement of works
DIAL 1100 BEFORE YOU DIG
www.1100.com.au

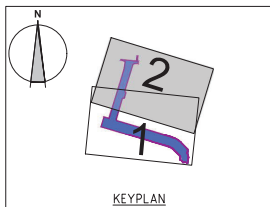

REVISION	DATE	DESIGN	WDR	APPRO
D	15/09/21	AY/KM	0025	GP
C	25/08/21	AY/AY	0023	GP
B	20/08/21	AY/EG	0019	GP
A	11/06/21	DR/KM	008	GP

Gustavo Pereira
RPEQ# 17514
Principal
Economic Development Queensland
1 William Street
Brisbane, 4000

All setting out should be carried out in accordance with GAA/Council's standard drawings or as nominated on hard copy plans provided by SMEC. Any digital information supplied by this office is for information only. Any discrepancies should be discussed with the superintendent.

Project Leader
G. Pereira
Designed
D. Rapson
Drawn
K. McCoy
Checked
D. Rapson
Authorised
G. Pereira
Date
May-2021

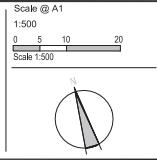

© SMEC Australia Pty Ltd
ABN 47 065 475 149
These designs and drawings are the copyright of SMEC Australia Pty Ltd. The drawing shall not be reproduced or copied, in whole or part, without the written permission of SMEC Australia Pty Ltd.
The contents of this drawing are electronically generated, are confidential and may only be used for the purpose for which they are intended.

SMEC AUSTRALIA
Level 1, 632 Southport-Nerang Road, Nerang, QLD, 4211
p +61 7 5578 0200 | f +61 7 3029 6650 | www.smec.com

Member of the **Surbana Jurong Group**
ABN 47 065 475 149

Address: +61 8 8225 9800 Geelong +61 3 5228 3100
Brisbane +61 7 3651 8888 Melbourne +61 3 9869 3800
Cambridge +61 2 4540 8222 Perth +61 8 9323 5900
Canberra +61 2 6126 1060 Traralgon +61 3 9173 0108

Northshore, Hamilton
Package 01
Economic Development Queensland
Roadworks
Roadworks Layout Plan
Drawing No. 2521E-01-212
Dev. App. No.
Sheet No. 2 of 2
Issue for Construction

Rev D

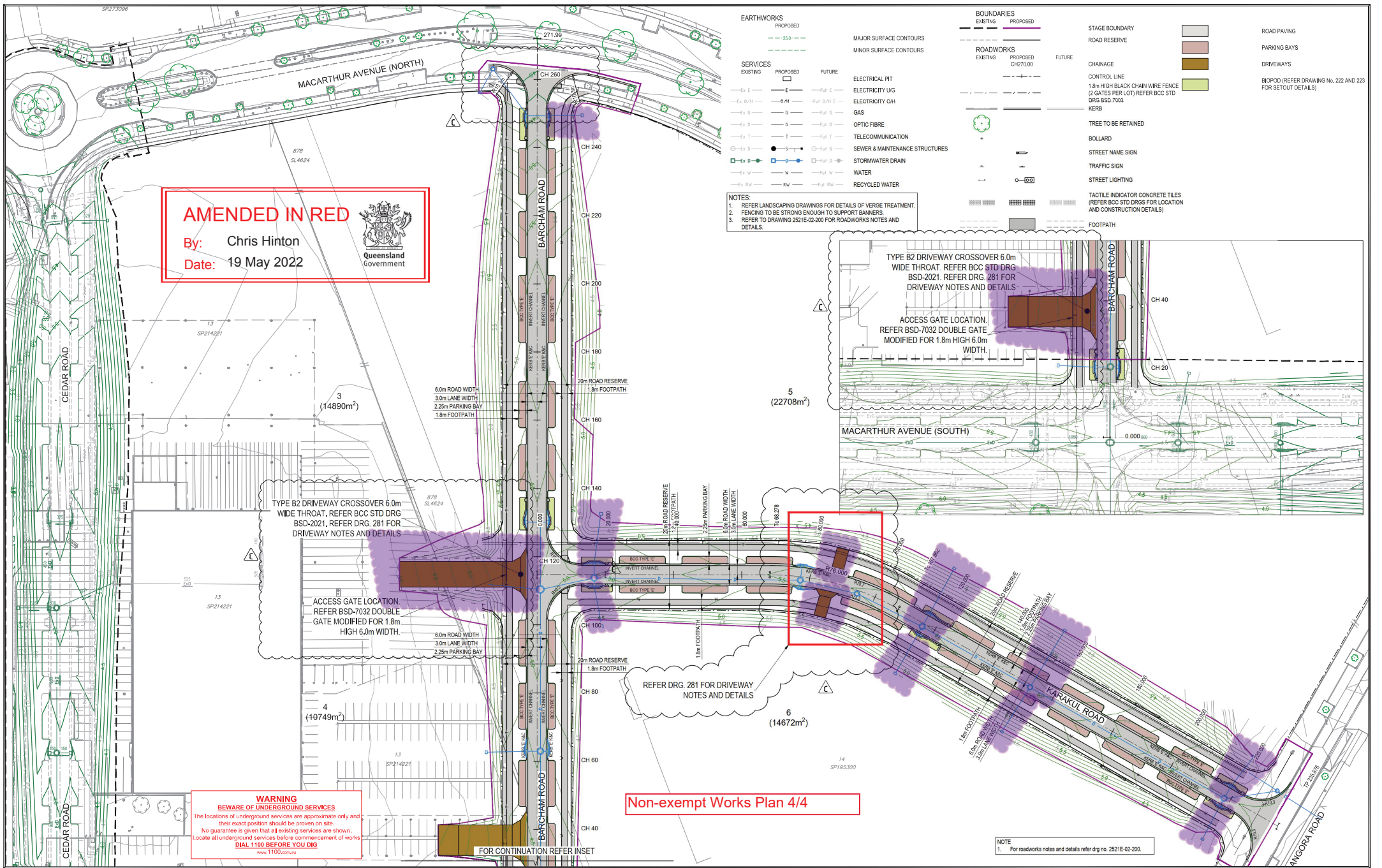

EARTHWORKS

PROPOSED

MAJOR SURFACE CONTOURS

MINOR SURFACE CONTOURS

SERVICES

EXISTING

PROPOSED

FUTURE

ELECTRICAL PIT

ELECTRICITY UG

ELECTRICITY OH

GAS

OPTIC FIBRE

TELECOMMUNICATION

SEWER & MAINTENANCE STRUCTURES

STORMWATER DRAIN

WATER

RECYCLED WATER

BOUNDARIES

EXISTING

PROPOSED

ROADWORKS

EXISTING

PROPOSED

CH270.00

FUTURE

STAGE BOUNDARY

ROAD RESERVE

CHAINAGE

CONTROL LINE

1.8m HIGH BLACK CHAIN WIRE FENCE (2 GATES PER LOT) REFER BCC STD DRG BSD-7003

KERBS

TREE TO BE RETAINED

BOLLARD

STREET NAME SIGN

TRAFFIC SIGN

STREET LIGHTING

TACTILE INDICATOR CONCRETE TILES (REFER BCC STD DRGS FOR LOCATION AND CONSTRUCTION DETAILS)

FOOTPATH

ROAD PAVING

PARKING BAYS

DRIVEWAYS

BIPOD (REFER DRAWING No. 222 AND 223 FOR SETOUT DETAILS)

NOTES:

- REFER LANDSCAPING DRAWINGS FOR DETAILS OF VERGE TREATMENT.
- FENCING TO BE STRONG ENOUGH TO SUPPORT BANNERS.
- REFER TO DRAWING 2521E-02-200 FOR ROADWORKS NOTES AND DETAILS.

AMENDED IN RED

By: Chris Hinton

Date: 19 May 2022

Queensland Government

WARNING

BEWARE OF UNDERGROUND SERVICES

The locations of underground services are approximate only and their exact position should be proven on site.

No guarantee is given that all existing services are shown.

Locate all underground services before commencement of works.

DIAL 1100 BEFORE YOU DIG

www.1100.com.au

Non-exempt Works Plan 4/4

NOTE

1. For roadworks notes and details refer drg no. 2521E-02-200.

FOR CONTINUATION REFER INSET

Scale @ A1

1:500

0 5 10 20

Scale 1:500

Project Leader

G. Pereira

Designed

D. Rapson

Drawn

K. McCoy

Checked

D. Rapson

Authorised

G. Pereira

Date

Dec-2020

Principal

Economic Development Queensland

1 William Street

Brisbane, 4000

Scale 1:500

0 5 10 20

© SMEC Australia Pty Ltd

ABN 47 065 475 149

These designs and drawings are the copyright of SMEC Australia Pty Ltd. The drawing shall not be reproduced or copied, in whole or part, without the written permission of SMEC Australia Pty Ltd.

The contents of this drawing are electronically generated, are confidential and may only be used for the purpose for which they are intended.

SMC AUSTRALIA

Level 1, 632 Southport-Nerang Road, Nerang, QLD, 4211

p +61 7 5578 0200 | f +61 7 3029 6650 | www.smc.com.au

Australia +61 8 8225 9800 Geelong +61 3 5228 3100
Brisbane +61 7 3051 8888 Melbourne +61 3 9889 3000
Canberra +61 2 4540 8222 Perth +61 8 9323 5900
Cardiff +61 2 6126 1000 Traralgon +61 3 5173 0108

Northshore, Hamilton

Package 02

Economic Development Queensland

Roadworks

Roadworks Layout Plan

Drawing No. 2521E-02-211

Dev. App. No.

Sheet No. 1 of 1

Issue for Construction

Rev C

REVISION	DATE	DESIGN	WDR	APPRO
C BCC Comments Addressed	15/09/21	AY/KM	0026	GP
B Re-issue for Construction	12/08/21	AY/EG	0016	GP
A Issue for Construction	11/06/21	DR/KM	008	GP