

PLANS AND DOCUMENTS referred to in the PDA DEVELOPMENT APPROVAL

Approval no: DEV2017/891

Date: 22 November 2018



DETAIL A - TYPICAL FAÇADE STACK JOINT

DETAIL B - DETAIL THROUGH FAÇADE RECESSES

Basement Level 02 and below

Sheet
1 of
10

**PLANS AND DOCUMENTS
referred to in the PDA
DEVELOPMENT APPROVAL**



Approval no: DEV2017/891
Date: 22 November 2018

CONSTANCE STREET

BREWERS STREET

SYMES STREET

SYMES STREET

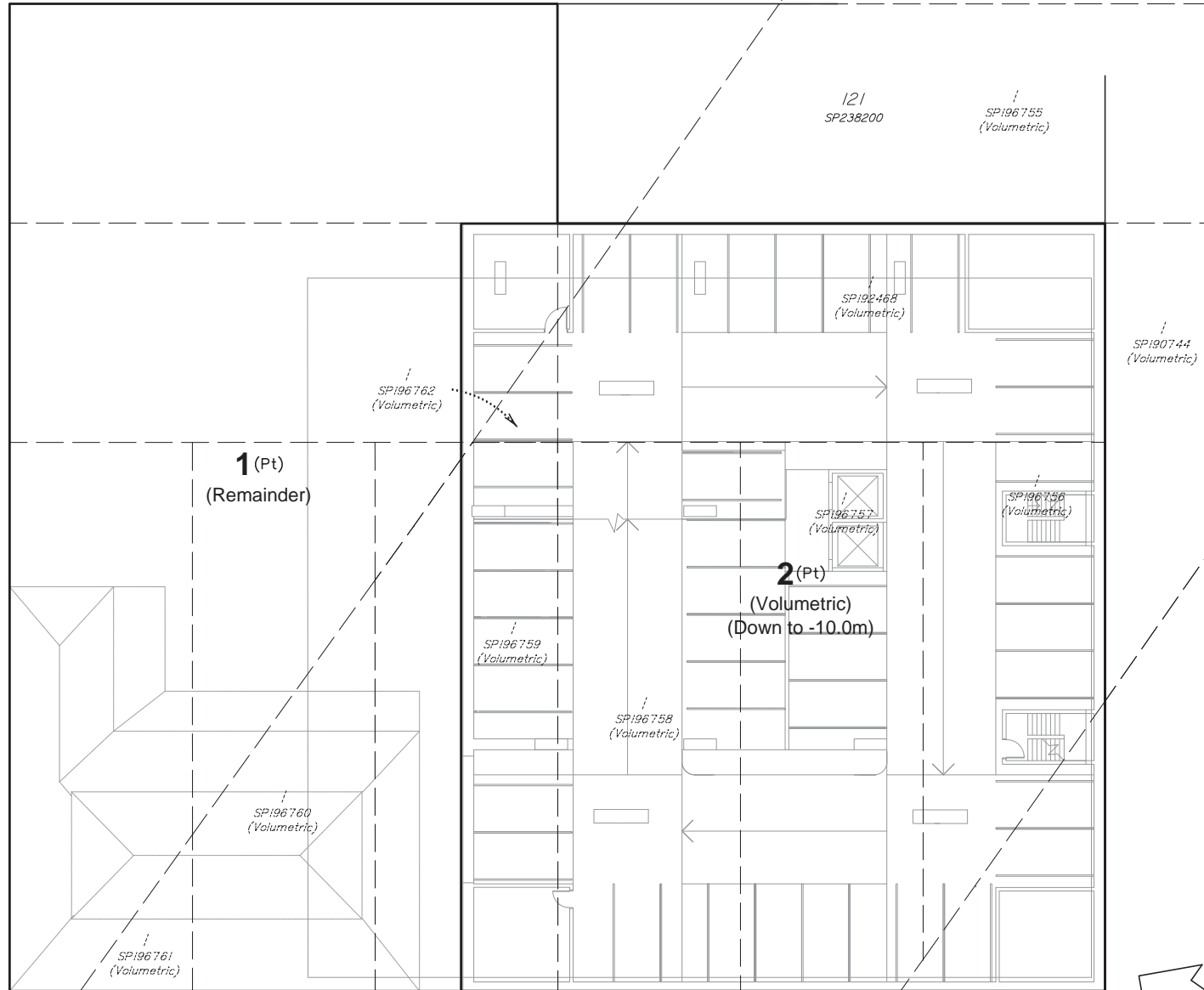

100
SP213171
(Volumetric)

ST PAULS TERRACE

121
SP238200

SP196755
(Volumetric)

SP192488
(Volumetric)

SP190744
(Volumetric)

SP196762
(Volumetric)

1 (Pt)
(Remainder)

SP196757
(Volumetric)

SP196756
(Volumetric)

2 (Pt)
(Volumetric)
(Down to -10.0m)

SP196759
(Volumetric)

SP196758
(Volumetric)

SP196760
(Volumetric)

SP196761
(Volumetric)

DIRECTION OF
3D VIEW

Scale 1:250



NOTES:

1. Drawn to scale on an A3 sheet.
2. All dimensions and areas are subject to final survey and approval by E.D.Q.
3. Architectural Information provided by Blight Rayner and is proposed only.
4. The Volumetric Lot Boundaries are to the centreline of floors/ceilings unless noted otherwise.

Issue	Revision	Int	Date
A	Original Issue	DJL	19/09/2017

**Plan of Proposed Volumetric
Subdivision of Lots 1 (Remainder)
& 2 (Volumetric)**

Cancelling Lot 30 on RP9713, Lot 31 on SP196762, Lot 32 on SP196761, Lot 33 on SP196760, Lot 34 on SP196759, Lot 35 on SP196758, Lot 36 on SP196757, Lot 37 on SP196756 & Lot 38 on SP192468
(SP299546)

Client: **BENNETT & ASSOCIATES**

Locality: FORTITUDE VALLEY
Local Gov: BCC/EDQ Prepared By: DJL
Surveyed By: Approved: GWS
Date Created: 19/09/2017 Scale: 1:250

Comp File:

Plan No: **170577_101_003_PRO_A**

Basement Level 01

Sheet 2 of 10

PLANS AND DOCUMENTS referred to in the PDA DEVELOPMENT APPROVAL



Approval no: DEV2017/891

Date: 22 November 2018

BREWERS STREET

121
SP238200

CONSTANCE STREET

1 (Pt)
(Remainder)

2 (Pt)
(Volumetric)

SYMES STREET

ST PAULS TERRACE

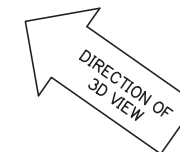

NOTES:

1. Drawn to scale on an A3 sheet.
2. All dimensions and areas are subject to final survey and approval by E.D.Q.
3. Architectural Information provided by Blight Rayner and is proposed only.
4. The Volumetric Lot Boundaries are to the centreline of floors/ceilings unless noted otherwise.

A	Original Issue	DJL	19/09/2017
Issue	Revision	Int	Date

Title:
Plan of Proposed Volumetric Subdivision of Lots 1 (Remainder) & 2 (Volumetric)
Cancelling Lot 30 on RP9713, Lot 31 on SP196762, Lot 32 on SP196761, Lot 33 on SP196760, Lot 34 on SP196759, Lot 35 on SP196758, Lot 36 on SP196757, Lot 37 on SP196756 & Lot 38 on SP192468
(SP299546)

Client: **BENNETT & ASSOCIATES**

Locality: FORTITUDE VALLEY

Local Gov: BCC/EDQ Prepared By: DJL

Surveyed By: Approved: GWS

Date Created: 19/09/2017 Scale: 1:250

Comp File:

Plan No: **170577_101_003_PRO_A**

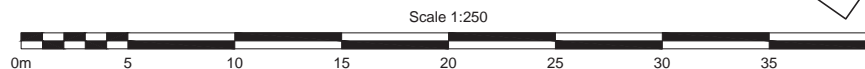

Lower Ground Level

Sheet 3 of 10

PLANS AND DOCUMENTS referred to in the PDA DEVELOPMENT APPROVAL



Approval no: DEV2017/891
Date: 22 November 2018

NOTES:

1. Drawn to scale on an A3 sheet.
2. All dimensions and areas are subject to final survey and approval by E.D.Q.
3. Architectural Information provided by Blight Rayner and is proposed only.
4. The Volumetric Lot Boundaries are to the centreline of floors/ceilings unless noted otherwise.

A	Original Issue	DJL	19/09/2017
Issue	Revision	Int	Date

Title:
Plan of Proposed Volumetric Subdivision of Lots 1 (Remainder) & 2 (Volumetric)
Cancelling Lot 30 on RP9713, Lot 31 on SP196762, Lot 32 on SP196761, Lot 33 on SP196760, Lot 34 on SP196759, Lot 35 on SP196758, Lot 36 on SP196757, Lot 37 on SP196756 & Lot 38 on SP192468
(SP299546)

Client: **BENNETT & ASSOCIATES**

Locality: FORTITUDE VALLEY
Local Gov: BCC/EDQ Prepared By: DJL
Surveyed By: Approved: GWS
Date Created: 19/09/2017 Scale: 1:250

Comp File:

Plan No: **170577_101_003_PRO_A**

BREWERS STREET

CONSTANCE STREET

SYMES STREET

ST PAULS TERRACE

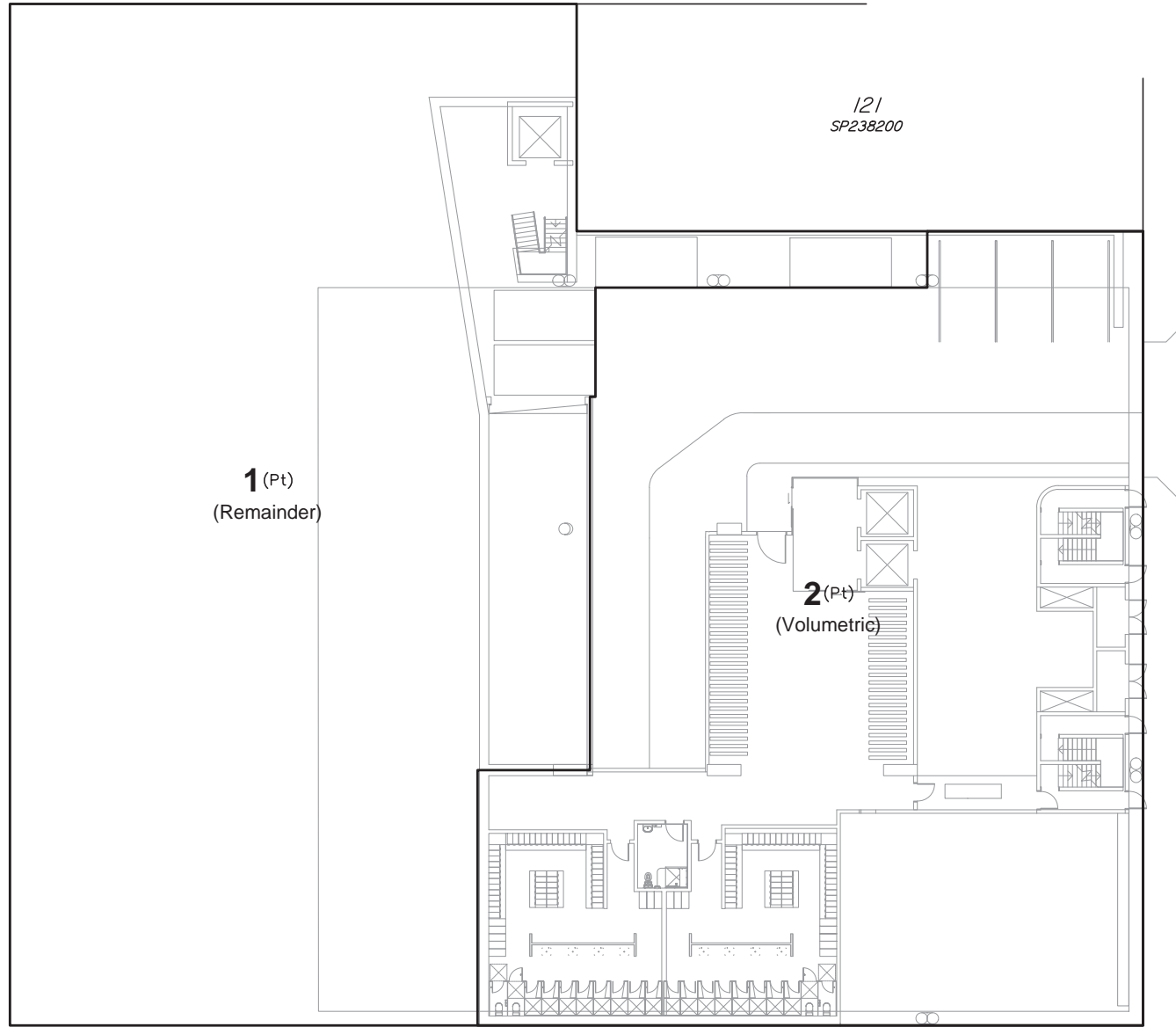

121
SP238200

1 (Pt)
(Remainder)

2 (Pt)
(Volumetric)

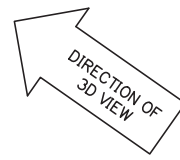

Scale 1:250



Upper Ground Level

Sheet 4 of 10

PO Box 5021, GCMC QLD 9726
Ph: (07) 5631 8000
mail@bennettandbennett.com.au

Surveying, Town Planning & Spatial Services
GOLD COAST | BRISBANE | SUNSHINE COAST | IPSWICH
www.bennettandbennett.com.au

PLANS AND DOCUMENTS referred to in the PDA DEVELOPMENT APPROVAL



Approval no: DEV2017/891
Date: 22 November 2018

NOTES:

1. Drawn to scale on an A3 sheet.
2. All dimensions and areas are subject to final survey and approval by E.D.Q.
3. Architectural Information provided by Blight Rayner and is proposed only.
4. The Volumetric Lot Boundaries are to the centreline of floors/ceilings unless noted otherwise.

A	Original Issue	DJL	19/09/2017
Issue	Revision	Int	Date

Title:
Plan of Proposed Volumetric Subdivision of Lots 1 (Remainder) & 2 (Volumetric)
Cancelling Lot 30 on RP9713, Lot 31 on SP196762, Lot 32 on SP196761, Lot 33 on SP196760, Lot 34 on SP196759, Lot 35 on SP196758, Lot 36 on SP196757, Lot 37 on SP196756 & Lot 38 on SP192468
(SP299546)

Client: **BENNETT & ASSOCIATES**

Locality: FORTITUDE VALLEY
Local Gov: BCC/EDQ Prepared By: DJL
Surveyed By: Approved: GWS
Date Created: 19/09/2017 Scale: 1:250

Comp File:

Plan No: **170577_101_003_PRO_A**

CONSTANCE STREET

BREWERS STREET

SYMES STREET

ST PAULS TERRACE

121
SP238200

1 (Pt)
(Remainder)

2 (Pt)
(Volumetric)

DIRECTION OF 3D VIEW

Scale 1:250



Plant Mezzanine

Sheet 5 of 10

PO Box 5021, GCMC QLD 9726
Ph: (07) 5631 8000
mail@bennettandbennett.com.au

Surveying, Town Planning & Spatial Services
GOLD COAST | BRISBANE | SUNSHINE COAST | IPSWICH
www.bennettandbennett.com.au

PLANS AND DOCUMENTS referred to in the PDA DEVELOPMENT APPROVAL



Approval no: DEV2017/891
Date: 22 November 2018

CONSTANCE STREET

BREWERS STREET

SYMES STREET

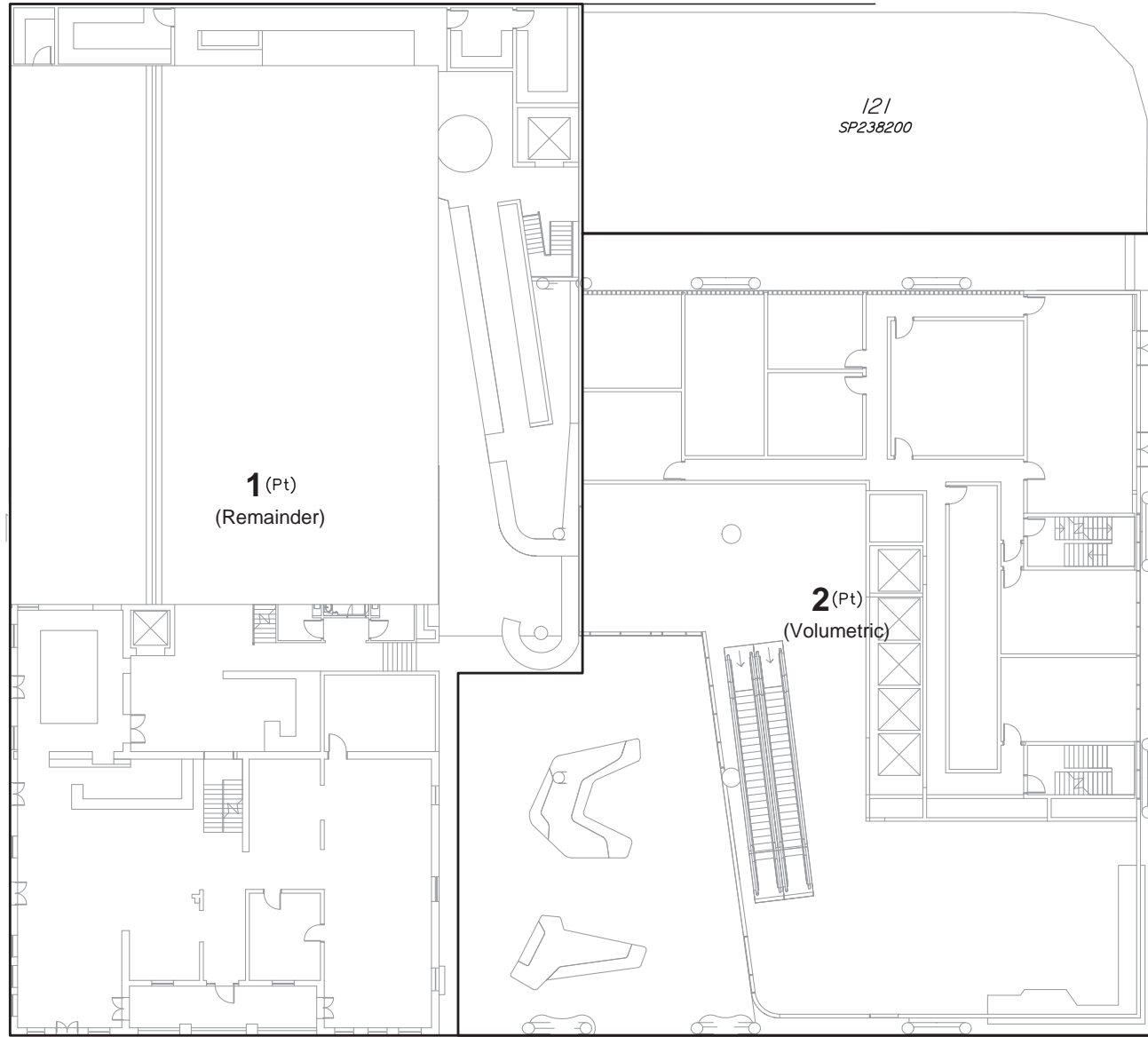

121
SP238200

1 (Pt)
(Remainder)

2 (Pt)
(Volumetric)

NOTES:

1. Drawn to scale on an A3 sheet.
2. All dimensions and areas are subject to final survey and approval by E.D.Q.
3. Architectural Information provided by Blight Rayner and is proposed only.
4. The Volumetric Lot Boundaries are to the centreline of floors/ceilings unless noted otherwise.

A	Original Issue	DJL	19/09/2017
Issue	Revision	Int	Date

Title:
Plan of Proposed Volumetric Subdivision of Lots 1 (Remainder) & 2 (Volumetric)
Cancelling Lot 30 on RP9713, Lot 31 on SP196762, Lot 32 on SP196761, Lot 33 on SP196760, Lot 34 on SP196759, Lot 35 on SP196758, Lot 36 on SP196757, Lot 37 on SP196756 & Lot 38 on SP192468
(SP299546)

Client: **BENNETT & ASSOCIATES**

Locality: FORTITUDE VALLEY
Local Gov: BCC/EDQ Prepared By: DJL
Surveyed By: Approved: GWS
Date Created: 19/09/2017 Scale: 1:250

Comp File:

Plan No: **170577_101_003_PRO_A**

ST PAULS TERRACE

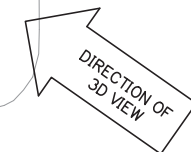

Scale 1:250



Level 01

Sheet 6 of 10

PO Box 5021, GCMC QLD 9726
Ph: (07) 5631 8000
mail@bennettandbennett.com.au

Surveying, Town Planning & Spatial Services
GOLD COAST | BRISBANE | SUNSHINE COAST | IPSWICH

www.bennettandbennett.com.au

PLANS AND DOCUMENTS
referred to in the PDA
DEVELOPMENT APPROVAL



Approval no: DEV2017/891

Date: 22 November 2018

NOTES:

1. Drawn to scale on an A3 sheet.
2. All dimensions and areas are subject to final survey and approval by E.D.Q.
3. Architectural Information provided by Blight Rayner and is proposed only.
4. The Volumetric Lot Boundaries are to the centreline of floors/ceilings unless noted otherwise.

A	Original Issue	DJL	19/09/2017
Issue	Revision	Int	Date

Title:
**Plan of Proposed Volumetric
Subdivision of Lots 1 (Remainder)
& 2 (Volumetric)**
Cancelling Lot 30 on RP9713, Lot 31 on SP196762, Lot 32 on SP196761, Lot 33 on SP196760, Lot 34 on SP196759, Lot 35 on SP196758, Lot 36 on SP196757, Lot 37 on SP196756 & Lot 38 on SP192468
(SP299546)

Client: **BENNETT & ASSOCIATES**

Locality: FORTITUDE VALLEY

Local Gov: BCC/EDQ Prepared By: DJL

Surveyed By: Approved: GWS

Date Created: 19/09/2017 Scale: 1:250

Comp File:

Plan No: **170577_101_003_PRO_A**

BREWERS STREET

CONSTANCE STREET

SYMES STREET

ST PAULS TERRACE

121
SP238200

1 (Pt)
(Remainder)

2 (Pt)
(Volumetric)

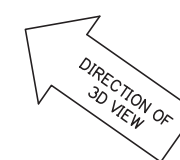

Scale 1:250



Level 02

Sheet 7 of 10

PO Box 5021, GCMC QLD 9726
Ph: (07) 5631 8000
mail@bennettandbennett.com.au

Surveying, Town Planning & Spatial Services
GOLD COAST | BRISBANE | SUNSHINE COAST | IPSWICH

www.bennettandbennett.com.au

**PLANS AND DOCUMENTS
referred to in the PDA
DEVELOPMENT APPROVAL**



Approval no: DEV2017/891
Date: 22 November 2018

BREWERS STREET

121
SP238200

CONSTANCE STREET

Courtyard
Below

1 (Pt)
(Remainder)

2 (Pt)
(Volumetric)

SYMES STREET

ST PAULS TERRACE

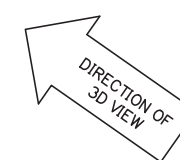

NOTES:

1. Drawn to scale on an A3 sheet.
2. All dimensions and areas are subject to final survey and approval by E.D.Q.
3. Architectural Information provided by Blight Rayner and is proposed only.
4. The Volumetric Lot Boundaries are to the centreline of floors/ceilings unless noted otherwise.

A	Original Issue	DJL	19/09/2017
Issue	Revision	Int	Date

Title:
**Plan of Proposed Volumetric
Subdivision of Lots 1 (Remainder)
& 2 (Volumetric)**
Cancelling Lot 30 on RP9713, Lot 31 on SP196762, Lot 32 on SP196761, Lot 33 on SP196760, Lot 34 on SP196759, Lot 35 on SP196758, Lot 36 on SP196757, Lot 37 on SP196756 & Lot 38 on SP192468
(SP299546)

Client: **BENNETT & ASSOCIATES**

Locality: FORTITUDE VALLEY

Local Gov: BCC/EDQ Prepared By: DJL

Surveyed By: Approved: GWS

Date Created: 19/09/2017 Scale: 1:250

Comp File:

Plan No: **170577_101_003_PRO_A**

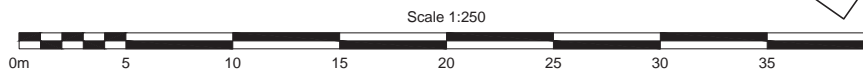

Level 03

Sheet 8 of 10

PLANS AND DOCUMENTS referred to in the PDA DEVELOPMENT APPROVAL



Approval no: DEV2017/891

Date: 22 November 2018

NOTES:

1. Drawn to scale on an A3 sheet.
2. All dimensions and areas are subject to final survey and approval by E.D.O.
3. Architectural Information provided by Blight Rayner and is proposed only.
4. The Volumetric Lot Boundaries are to the centreline of floors/ceilings unless noted otherwise.

A	Original Issue	DJL	19/09/2017
Issue	Revision	Int	Date

Title:
Plan of Proposed Volumetric Subdivision of Lots 1 (Remainder) & 2 (Volumetric)
Cancelling Lot 30 on RP9713, Lot 31 on SP196762, Lot 32 on SP196761, Lot 33 on SP196760, Lot 34 on SP196759, Lot 35 on SP196758, Lot 36 on SP196757, Lot 37 on SP196756 & Lot 38 on SP192468
(SP299546)

Client: **BENNETT & ASSOCIATES**

Locality: FORTITUDE VALLEY

Local Gov: BCC/EDQ Prepared By: DJL

Surveyed By: Approved: GWS

Date Created: 19/09/2017 Scale: 1:250

Comp File:

Plan No: **170577_101_003_PRO_A**

BREWERS STREET

CONSTANCE STREET

SYMES STREET

ST PAULS TERRACE

121
SP238200

1 (Pt)
(Remainder)

2 (Pt)
(Volumetric)

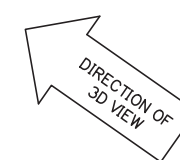

Scale 1:250



Level 04 and above

Sheet 9 of 10

PLANS AND DOCUMENTS
referred to in the PDA
DEVELOPMENT APPROVAL



Approval no: DEV2017/891
Date: 22 November 2018

CONSTANCE STREET

BREWERS STREET

SYMES STREET

SYMES STREET

ST PAULS TERRACE

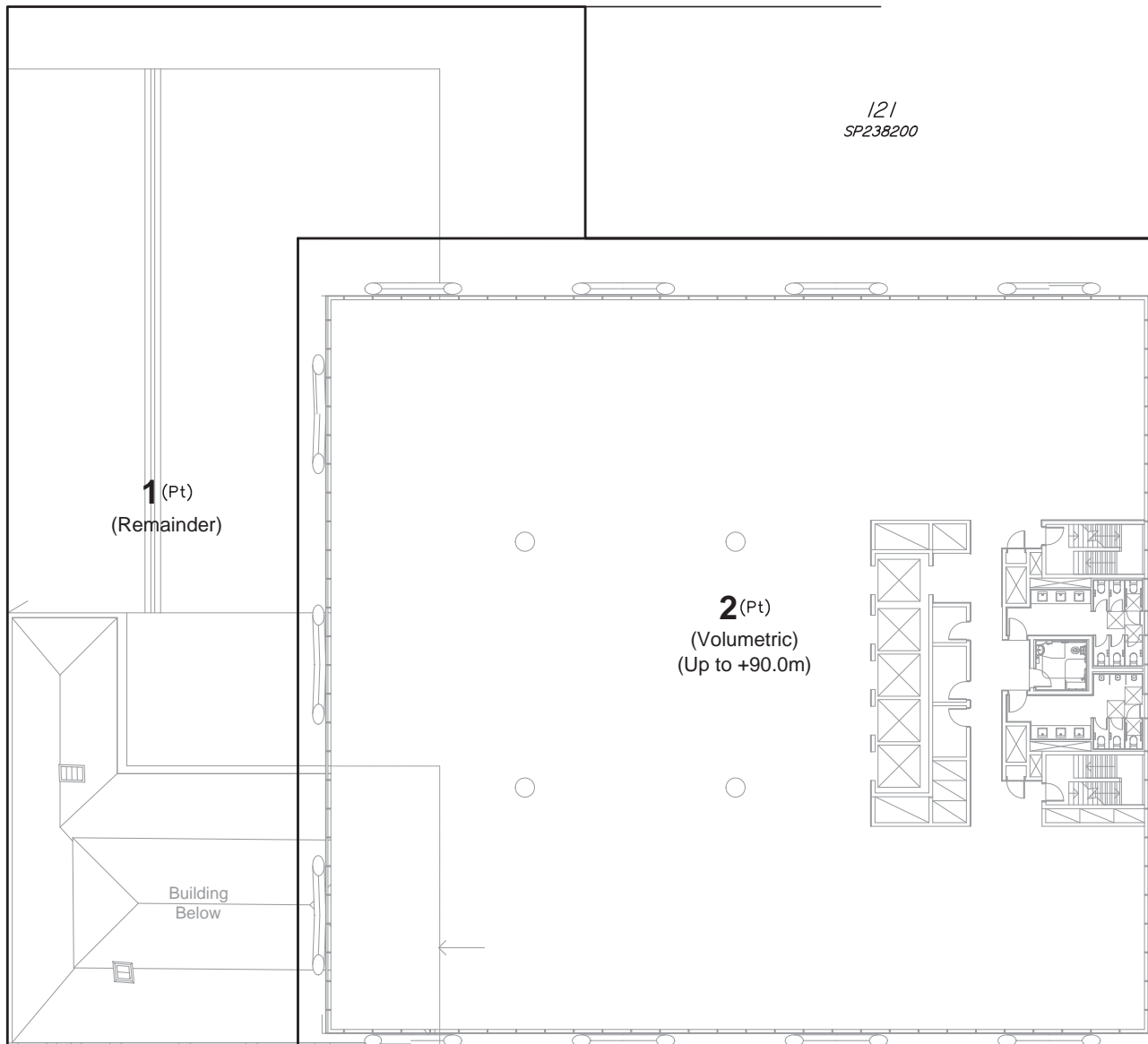

121
SP238200

1 (Pt)
(Remainder)

2 (Pt)
(Volumetric)
(Up to +90.0m)

Building
Below

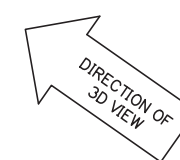

NOTES:

1. Drawn to scale on an A3 sheet.
2. All dimensions and areas are subject to final survey and approval by E.D.Q.
3. Architectural Information provided by Blight Rayner and is proposed only.
4. The Volumetric Lot Boundaries are to the centreline of floors/ceilings unless noted otherwise.

A	Original Issue	DJL	19/09/2017
Issue	Revision	Int	Date

Title:
Plan of Proposed Volumetric Subdivision of Lots 1 (Remainder) & 2 (Volumetric)
Cancelling Lot 30 on RP9713, Lot 31 on SP196762, Lot 32 on SP196761, Lot 33 on SP196760, Lot 34 on SP196759, Lot 35 on SP196758, Lot 36 on SP196757, Lot 37 on SP196756 & Lot 38 on SP192468
(SP299546)

Client: **BENNETT & ASSOCIATES**

Locality: FORTITUDE VALLEY

Local Gov: BCC/EDQ Prepared By: DJL

Surveyed By: Approved: GWS

Date Created: 19/09/2017 Scale: 1:250

Comp File:

Plan No: **170577_101_003_PRO_A**

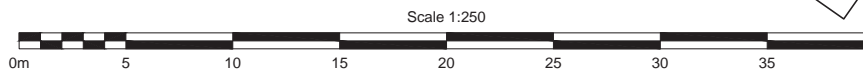

3D VIEW

Not to scale

Sheet 10 of 10

PO Box 5021, GCMC QLD 9726
Ph: (07) 5631 8000
mail@bennettandbennett.com.au

Surveying, Town Planning & Spatial Services
GOLD COAST | BRISBANE | SUNSHINE COAST | IPSWICH

www.bennettandbennett.com.au

PLANS AND DOCUMENTS
referred to in the PDA
DEVELOPMENT APPROVAL



Approval no: DEV2017/891
Date: 22 November 2018

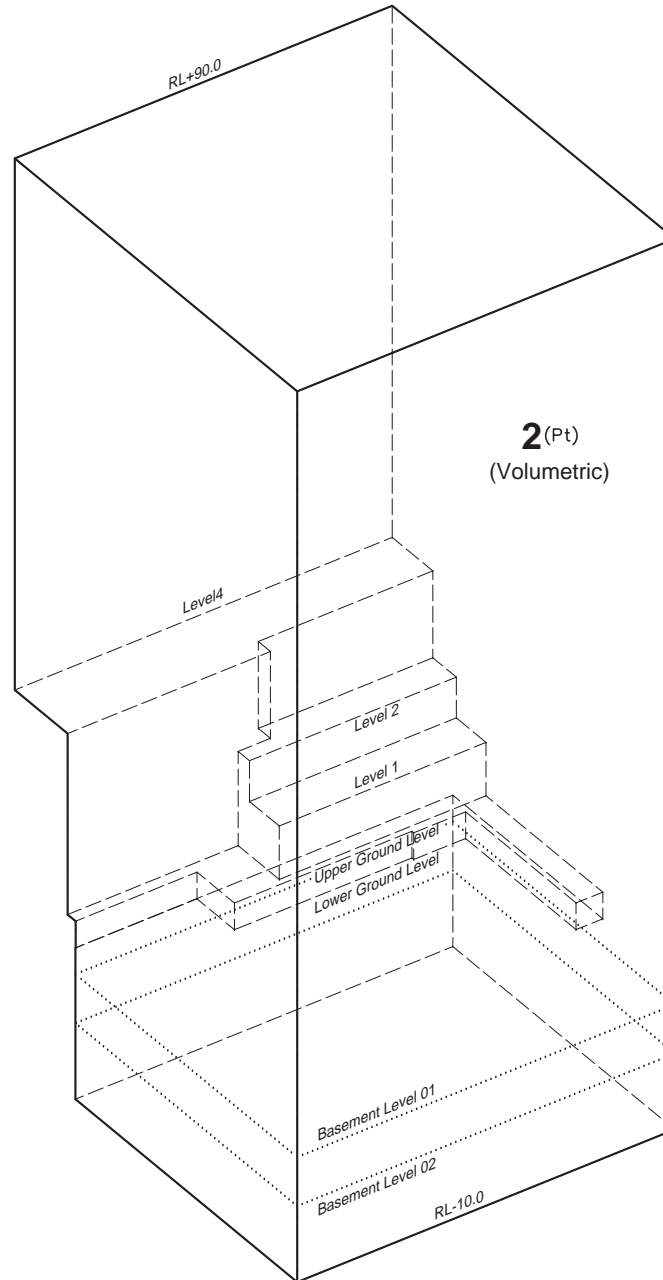

NOTES:

1. Drawn to scale on an A3 sheet.
2. All dimensions and areas are subject to final survey and approval by E.D.Q.
3. Architectural Information provided by Blight Rayner and is proposed only.
4. The Volumetric Lot Boundaries are to the centreline of floors/ceilings unless noted otherwise.

A	Original Issue	DJL	19/09/2017
Issue	Revision	Int	Date

Title:

Plan of Proposed Volumetric Subdivision of Lots 1 (Remainder) & 2 (Volumetric)

Cancelling Lot 30 on RP9713, Lot 31 on SP196762, Lot 32 on SP196761, Lot 33 on SP196760, Lot 34 on SP196759, Lot 35 on SP196758, Lot 36 on SP196757, Lot 37 on SP196756 & Lot 38 on SP192468

(SP299546)

Client: **BENNETT & ASSOCIATES**

Locality: FORTITUDE VALLEY

Local Gov: BCC/EDQ Prepared By: DJL

Surveyed By: Approved: GWS

Date Created: 19/09/2017 Scale: NTS

Comp File:

Plan No: **170577_101_003_PRO_A**

Lower Ground Level

Sheet 1 of 2



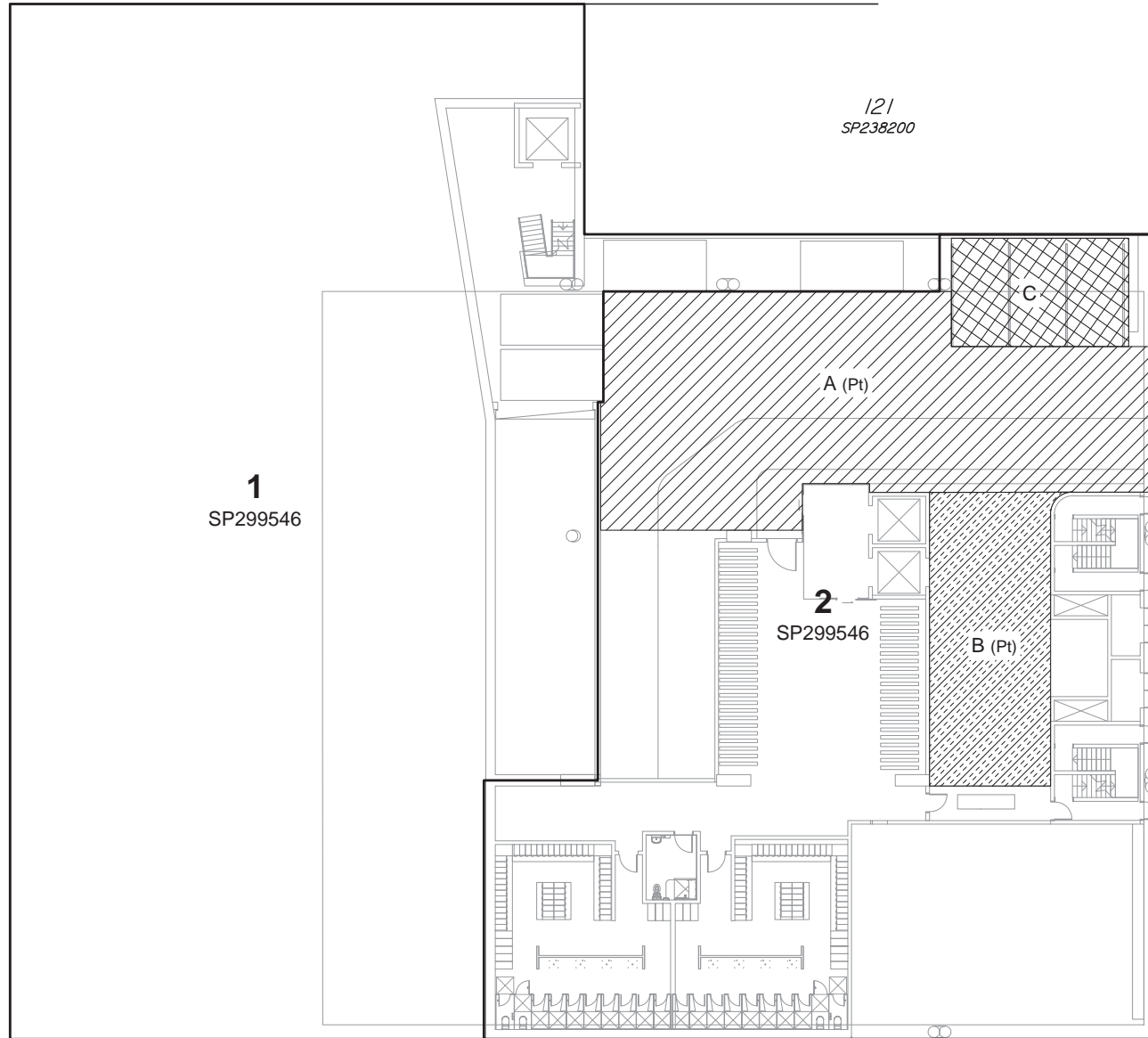

BREWERS STREET

CONSTANCE STREET

SYMES STREET



BMS Schedule

-  (A) Major access.
-  (B) Loading Dock.
-  (C) Delivery Parking.
-  (D) Shared Plaza Area.

- NOTES:**
1. Drawn to scale on an A3 sheet.
 2. All dimensions and areas are subject to final survey and approval by E.D.Q.
 3. Architectural Information provided by Blight Rayner and is proposed only.

A	Original Issue	DJL	19/09/2017
Issue	Revision	Int	Date

Title:
Plan of Proposed BMS Areas A-D
In Lot 2 on SP299546

Client: **BENNETT & ASSOCIATES**

Locality: FORTITUDE VALLEY
Local Gov: BCC/EDQ Prepared By: DJL
Surveyed By: Approved: GWS
Date Created: 19/09/2017 Scale: 1:250
Comp File:

Plan No: **170577_101_004_MIS_A**

ST PAULS TERRACE

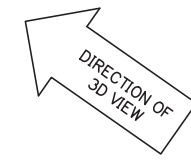

Scale 1:250

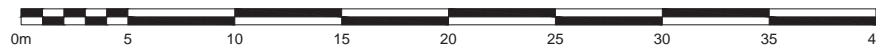

Upper Ground Level

Sheet 2 of 2

PO Box 5021, GCMC QLD 9726
Ph: (07) 5631 8000
mail@bennettandbennett.com.au

Surveying, Town Planning & Spatial Services
GOLD COAST | BRISBANE | SUNSHINE COAST | IPSWICH



www.bennettandbennett.com.au

**PLANS AND DOCUMENTS
referred to in the PDA
DEVELOPMENT APPROVAL**



Approval no: DEV2017/891
Date: 22 November 2018

BMS Schedule

-  (A) Major access.
-  (B) Loading Dock.
-  (C) Delivery Parking.
-  (D) Shared Plaza Area.

NOTES:

1. Drawn to scale on an A3 sheet.
2. All dimensions and areas are subject to final survey and approval by E.D.Q.
3. Architectural Information provided by Blight Rayner and is proposed only.
4. The Volumetric Lot Boundaries are to the centreline of floors/ceilings unless noted otherwise.

A	Original Issue	DJL	19/09/2017
Issue	Revision	Int	Date

Title:
Plan of Proposed BMS Areas A-D
In Lot 2 on SP299546

Client: **BENNETT & ASSOCIATES**

Locality: FORTITUDE VALLEY
Local Gov: BCC/EDQ Prepared By: DJL
Surveyed By: Approved: GWS
Date Created: 19/09/2017 Scale: 1:250

Comp File:

Plan No: **170577_101_004_MIS_A**

BREWERS STREET

CONSTANCE STREET

SYMES STREET

ST PAULS TERRACE

121
SP238200

1
SP299546

2
SP299546

A (Pt)
Void

B (Pt)
Void

D

Scale 1:250

