



Date: 12 February, 2018

Ref: 8342R05V02

To: Hannah Williams

Company: Stockland Development Pty Ltd

Email: hannah.williams@stockland.com.au

Author: Bill Elder/SP

Subject: Aura Development, Caloundra South, Precinct 10 - Noise Assessment Technical Memo

Pages: 1 of 5 (including **Appendix A**)

Dear Hannah,

ASK Consulting Engineers Pty Ltd (ASK) was commissioned by Stockland Development Pty Ltd to provide acoustic consultancy services for Precinct 10 of the Aura Development, which is located within the Caloundra South Priority Development Area (PDA).

ASK has previously undertaken noise modelling of nearby precincts of the Aura development which included Bells Creek Arterial. This assessment is an extension of the noise assessment undertaken in ASK report *Aura Development - Precincts 7, 8, 9 & 10 - Transport Noise Impact Assessment* (ref: 8342R01V01, dated 26 May 2016).

The previous noise assessment (8342R01V01) made recommendations for several noise barriers to be constructed adjacent the property boundaries of multiple lots adjoining the sub-arterial roads. The recommended barriers were presented in Figures E.1 to E.5 within Appendix E of that assessment report.

Since preparation of the original noise assessment, the final bulk earthworks and road level design within Precinct 10 have been completed. Revised noise modelling and a revised traffic noise assessment has been undertaken to confirm the barrier heights and alignments required to achieve the relevant noise criteria. The revised modelling considers the final bulk earthworks and road level design, and the most recent lot layout.

The results of this revised assessment indicate that the heights of the barriers remain the same as the original assessment but the alignment of barriers has changed to suit the new lot layout. The new barriers are shown in **Figure A.1** and **Figure A.2** of this memo and effectively replace Figure E.3 and Figure E.4 of the original assessment (8342R01V01).

The height of the barrier shown in Figure E.5 of 8342R01V01 has not been reviewed as final bulk earthwork design has not been completed adjacent to that barrier.

Predicted road traffic noise levels at each lot are presented in **Table B.1**. The predicted noise levels with the noise barriers (see **Appendix A**) comply with the 63 dBA $L_{10(18 \text{ hour})}$ (facade corrected) noise limit for the ground floor of all lots, with the exception of lots which require active frontages. The predicted noise levels for the upper floor exceed the 63 dBA $L_{10(18 \text{ hour})}$ (facade corrected) noise limit for numerous lots (see **Table B.1**).

ASK Consulting Engineers Pty Ltd

ABN: 55 622 586 522 ACN: 128 491 967

PO Box 3901 South Brisbane QLD 4101

P: 07 3255 3355 F: 07 3844 7180

www.askconsulting.com.au mail@askconsulting.com.au

For lots/floors where the predicted noise level exceeds the 63 dBA $L_{10(18 \text{ hour})}$ (facade corrected) noise limit, these lots have been identified in **Table B.1** as a “Noise Affected Lot”. For lots affected by traffic noise from sub-arterial roads, the design and construction of dwellings on these lots is required to achieve the internal noise limits prescribed by Sunshine Coast Regional Council, as summarised in Section 4.7 of the previous assessment.

Lots 1599 – 2015 have not been included in this assessment as the final bulk earthworks design has not been completed for this entire section. Refer to previous report (8342R01V01) for indicative predicted noise levels.

Specific building designs are not available at this stage of the development process, and therefore specific upgrades to facade treatments cannot be evaluated. For the nominated noise affected lots, a design certificate for the specific building design is required to be prepared by an acoustic consultant, and must be prepared in accordance with Australian Standards AS 3671 and AS 2107.

If you have any queries regarding this document please do not hesitate to contact the undersigned on (07) 3255 3355.

Yours faithfully,

ASK Consulting Engineers

A handwritten signature in black ink that reads "W. Elder". The signature is written in a cursive style with a long horizontal stroke at the end.

Bill Elder

Project Engineer

Appendix A Updated Figures

Job No: 8342R05V01
Aura - Precinct 10

Figure A.1

Proposed Noise Barriers
North West and North
Central Sections

Date: 22/01/2016
Drawn By: BE
Prepared For:
Stockland Development
Pty Ltd

Legend

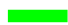
-  1.8m High Noise Barrier
-  2.0m High Noise Barrier
-  2.2m High Noise Barrier
-  2.3m High Noise Barrier
-  Road Axis
-  Emission Line



Length Scale 1:2435

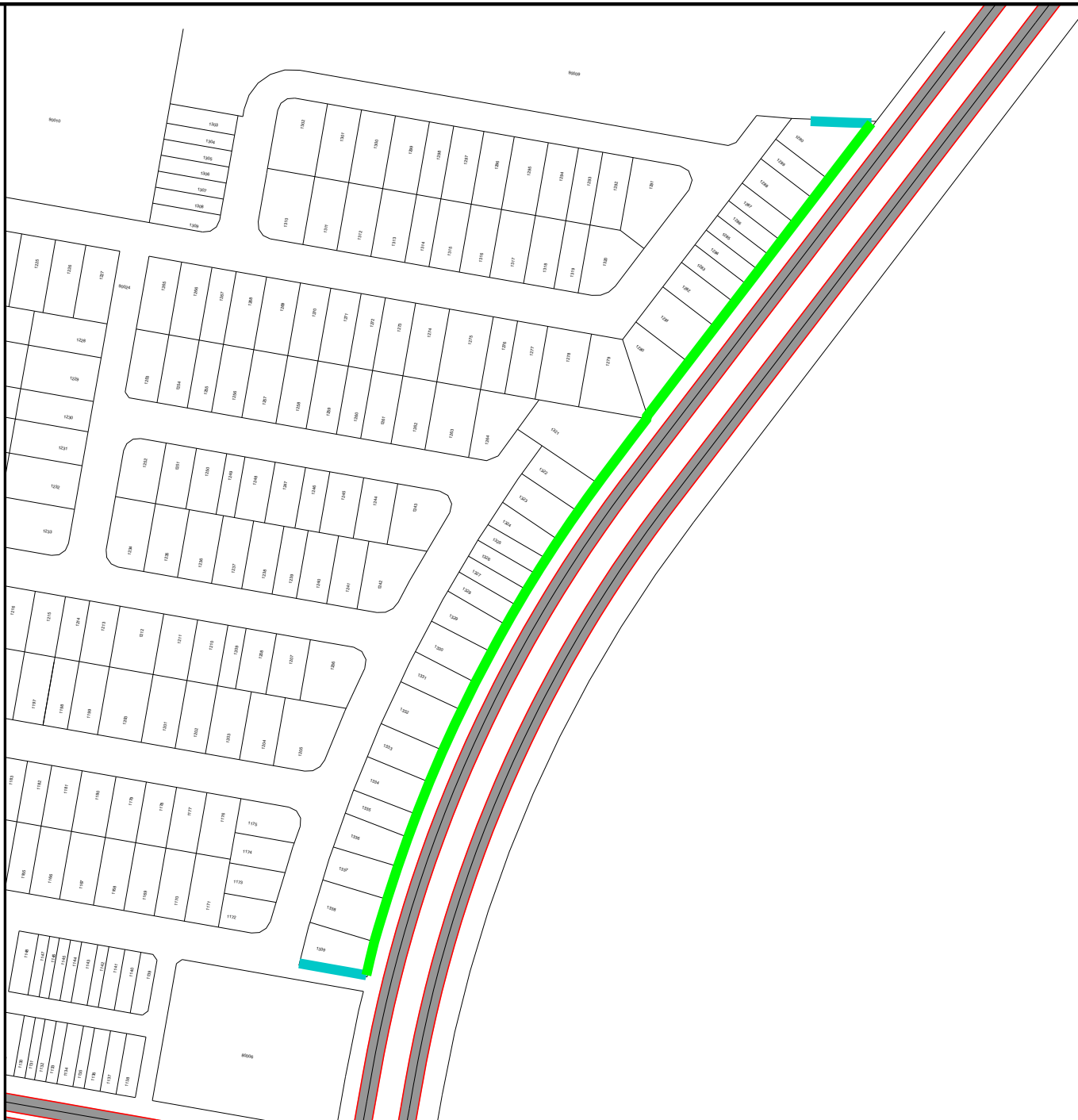
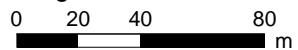

Job No: 8342R05V01
Aura - Precinct 10

Figure A.2

Proposed Noise Barriers
Central West Section

Date: 22/01/2018

Drawn By: BE

Prepared For:

Stockland Development
Pty Ltd

Legend

-  1.8m High Noise Barrier
-  2.0m High Noise Barrier
-  2.2m High Noise Barrier
-  2.3m High Noise Barrier
-  Road Axis
-  Emission Line



Length Scale 1:2135

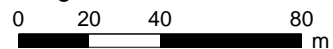

Appendix B Predicted Road Traffic Noise Levels

Table B.1 Predicted Road Traffic Noise Levels

Lot	Floor	Predicted L10(18 hour) Noise Level (Facade Corrected)	Noise Affected?	Applicable Criteria
1001	GF	52	No	N/A
	F 1	53	No	N/A
1002	GF	52	No	N/A
	F 1	53	No	N/A
1003	GF	52	No	N/A
	F 1	53	No	N/A
1004	GF	52	No	N/A
	F 1	53	No	N/A
1005	GF	52	No	N/A
	F 1	53	No	N/A
1006	GF	52	No	N/A
	F 1	53	No	N/A
1007	GF	52	No	N/A
	F 1	53	No	N/A
1008	GF	53	No	N/A
	F 1	54	No	N/A
1009	GF	53	No	N/A
	F 1	54	No	N/A
1010	GF	53	No	N/A
	F 1	54	No	N/A
1011	GF	53	No	N/A
	F 1	54	No	N/A
1012	GF	53	No	N/A
	F 1	54	No	N/A
1013	GF	53	No	N/A
	F 1	54	No	N/A
1014	GF	53	No	N/A
	F 1	55	No	N/A
1015	GF	53	No	N/A
	F 1	55	No	N/A
1016	GF	54	No	N/A
	F 1	55	No	N/A
1017	GF	54	No	N/A
	F 1	55	No	N/A
1018	GF	54	No	N/A

Lot	Floor	Predicted L10(18 hour) Noise Level (Facade Corrected)	Noise Affected?	Applicable Criteria
1019	F 1	55	No	N/A
	GF	54	No	N/A
1020	F 1	55	No	N/A
	GF	54	No	N/A
1021	F 1	55	No	N/A
	GF	54	No	N/A
1022	F 1	55	No	N/A
	GF	54	No	N/A
1023	F 1	55	No	N/A
	GF	54	No	N/A
1024	F 1	55	No	N/A
	GF	54	No	N/A
1025	F 1	55	No	N/A
	GF	53	No	N/A
1026	F 1	54	No	N/A
	GF	53	No	N/A
1027	F 1	54	No	N/A
	GF	53	No	N/A
1028	F 1	54	No	N/A
	GF	53	No	N/A
1029	F 1	54	No	N/A
	GF	52	No	N/A
1030	F 1	54	No	N/A
	GF	52	No	N/A
1031	F 1	54	No	N/A
	GF	52	No	N/A
1032	F 1	53	No	N/A
	GF	52	No	N/A
1033	F 1	53	No	N/A
	GF	52	No	N/A
1034	F 1	53	No	N/A
	GF	52	No	N/A
1035	F 1	53	No	N/A
	GF	52	No	N/A
1036	F 1	53	No	N/A
	GF	52	No	N/A
1037	F 1	54	No	N/A
	GF	52	No	N/A

Lot	Floor	Predicted L10(18 hour) Noise Level (Facade Corrected)	Noise Affected?	Applicable Criteria
1038	GF	52	No	N/A
	F 1	54	No	N/A
1039	GF	52	No	N/A
	F 1	54	No	N/A
1040	GF	52	No	N/A
	F 1	54	No	N/A
1041	GF	53	No	N/A
	F 1	54	No	N/A
1042	GF	53	No	N/A
	F 1	54	No	N/A
1043	GF	53	No	N/A
	F 1	54	No	N/A
1044	GF	53	No	N/A
	F 1	54	No	N/A
1045	GF	53	No	N/A
	F 1	54	No	N/A
1046	GF	53	No	N/A
	F 1	55	No	N/A
1047	GF	53	No	N/A
	F 1	55	No	N/A
1048	GF	54	No	N/A
	F 1	55	No	N/A
1049	GF	54	No	N/A
	F 1	55	No	N/A
1050	GF	54	No	N/A
	F 1	55	No	N/A
1051	GF	54	No	N/A
	F 1	56	No	N/A
1052	GF	54	No	N/A
	F 1	56	No	N/A
1053	GF	54	No	N/A
	F 1	56	No	N/A
1054	GF	54	No	N/A
	F 1	56	No	N/A
1055	GF	55	No	N/A
	F 1	56	No	N/A
1056	GF	55	No	N/A
	F 1	57	No	N/A
1057	GF	55	No	N/A

Lot	Floor	Predicted L10(18 hour) Noise Level (Facade Corrected)	Noise Affected?	Applicable Criteria
1058	F 1	57	No	N/A
	GF	56	No	N/A
1059	F 1	57	No	N/A
	GF	56	No	N/A
1060	F 1	58	No	N/A
	GF	57	No	N/A
1061	F 1	59	No	N/A
	GF	57	No	N/A
1062	F 1	61	No	N/A
	GF	60	No	N/A
1063	F 1	61	No	N/A
	GF	59	No	N/A
1064	F 1	61	No	N/A
	GF	59	No	N/A
1065	F 1	60	No	N/A
	GF	58	No	N/A
1066	F 1	59	No	N/A
	GF	58	No	N/A
1067	F 1	58	No	N/A
	GF	57	No	N/A
1068	F 1	58	No	N/A
	GF	56	No	N/A
1069	F 1	57	No	N/A
	GF	56	No	N/A
1070	F 1	57	No	N/A
	GF	55	No	N/A
1071	F 1	57	No	N/A
	GF	55	No	N/A
1072	F 1	56	No	N/A
	GF	55	No	N/A
1073	F 1	56	No	N/A
	GF	55	No	N/A
1074	F 1	56	No	N/A
	GF	54	No	N/A
1075	F 1	56	No	N/A
	GF	55	No	N/A
1076	F 1	56	No	N/A
	GF	55	No	N/A

Lot	Floor	Predicted L10(18 hour) Noise Level (Facade Corrected)	Noise Affected?	Applicable Criteria
1077	GF	55	No	N/A
	F 1	56	No	N/A
1078	GF	55	No	N/A
	F 1	56	No	N/A
1079	GF	55	No	N/A
	F 1	56	No	N/A
1080	GF	55	No	N/A
	F 1	57	No	N/A
1081	GF	55	No	N/A
	F 1	57	No	N/A
1082	GF	56	No	N/A
	F 1	57	No	N/A
1083	GF	56	No	N/A
	F 1	57	No	N/A
1084	GF	56	No	N/A
	F 1	57	No	N/A
1085	GF	56	No	N/A
	F 1	57	No	N/A
1086	GF	56	No	N/A
	F 1	57	No	N/A
1087	GF	56	No	N/A
	F 1	58	No	N/A
1088	GF	56	No	N/A
	F 1	58	No	N/A
1089	GF	57	No	N/A
	F 1	58	No	N/A
1090	GF	57	No	N/A
	F 1	58	No	N/A
1091	GF	57	No	N/A
	F 1	59	No	N/A
1092	GF	58	No	N/A
	F 1	59	No	N/A
1093	GF	58	No	N/A
	F 1	59	No	N/A
1094	GF	58	No	N/A
	F 1	59	No	N/A
1095	GF	58	No	N/A
	F 1	60	No	N/A
1096	GF	58	No	N/A

Lot	Floor	Predicted L10(18 hour) Noise Level (Facade Corrected)	Noise Affected?	Applicable Criteria
1097	F 1	60	No	N/A
	GF	59	No	N/A
1098	F 1	60	No	N/A
	GF	59	No	N/A
1099	F 1	61	No	N/A
	GF	59	No	N/A
1100	F 1	62	No	N/A
	GF	60	No	N/A
1101	F 1	71	Yes	SCRC-AS2107
	GF	63	No	N/A
1102	F 1	72	Yes	SCRC-AS2107
	GF	63	No	N/A
1103	F 1	72	Yes	SCRC-AS2107
	GF	63	No	N/A
1104	F 1	72	Yes	SCRC-AS2107
	GF	63	No	N/A
1105	F 1	72	Yes	SCRC-AS2107
	GF	63	No	N/A
1106	F 1	72	Yes	SCRC-AS2107
	GF	62	No	N/A
1107	F 1	72	Yes	SCRC-AS2107
	GF	62	No	N/A
1108	F 1	72	Yes	SCRC-AS2107
	GF	63	No	N/A
1109	F 1	71	Yes	SCRC-AS2107
	GF	63	No	N/A
1110	F 1	68	Yes	SCRC-AS2107
	GF	63	No	N/A
1111	F 1	67	Yes	SCRC-AS2107
	GF	63	No	N/A
1112	F 1	65	Yes	SCRC-AS2107
	GF	63	No	N/A
1113	F 1	64	Yes	SCRC-AS2107
	GF	62	No	N/A
1114	F 1	63	No	N/A
	GF	61	No	N/A
1115	F 1	63	No	N/A
	GF	61	No	N/A

Lot	Floor	Predicted L10(18 hour) Noise Level (Facade Corrected)	Noise Affected?	Applicable Criteria
1116	GF	60	No	N/A
	F 1	62	No	N/A
1117	GF	60	No	N/A
	F 1	62	No	N/A
1118	GF	59	No	N/A
	F 1	61	No	N/A
1119	GF	69	Yes	SCRC-AS2107
	F 1	70	Yes	SCRC-AS2107
1120	GF	69	Yes	SCRC-AS2107
	F 1	70	Yes	SCRC-AS2107
1121	GF	69	Yes	SCRC-AS2107
	F 1	70	Yes	SCRC-AS2107
1122	GF	69	Yes	SCRC-AS2107
	F 1	70	Yes	SCRC-AS2107
1123	GF	69	Yes	SCRC-AS2107
	F 1	70	Yes	SCRC-AS2107
1124	GF	69	Yes	SCRC-AS2107
	F 1	70	Yes	SCRC-AS2107
1125	GF	69	Yes	SCRC-AS2107
	F 1	70	Yes	SCRC-AS2107
1126	GF	69	Yes	SCRC-AS2107
	F 1	70	Yes	SCRC-AS2107
1127	GF	69	Yes	SCRC-AS2107
	F 1	70	Yes	SCRC-AS2107
1128	GF	69	Yes	SCRC-AS2107
	F 1	70	Yes	SCRC-AS2107
1129	GF	69	Yes	SCRC-AS2107
	F 1	70	Yes	SCRC-AS2107
1130	GF	69	Yes	SCRC-AS2107
	F 1	70	Yes	SCRC-AS2107
1131	GF	69	Yes	SCRC-AS2107
	F 1	70	Yes	SCRC-AS2107
1132	GF	69	Yes	SCRC-AS2107
	F 1	70	Yes	SCRC-AS2107
1133	GF	69	Yes	SCRC-AS2107
	F 1	70	Yes	SCRC-AS2107
1134	GF	69	Yes	SCRC-AS2107
	F 1	70	Yes	SCRC-AS2107
1135	GF	69	Yes	SCRC-AS2107

Lot	Floor	Predicted L10(18 hour) Noise Level (Facade Corrected)	Noise Affected?	Applicable Criteria
1136	F 1	70	Yes	SCRC-AS2107
	GF	69	Yes	SCRC-AS2107
	F 1	70	Yes	SCRC-AS2107
1137	GF	69	Yes	SCRC-AS2107
	F 1	70	Yes	SCRC-AS2107
1138	GF	69	Yes	SCRC-AS2107
	F 1	70	Yes	SCRC-AS2107
1139	GF	61	No	N/A
	F 1	63	No	N/A
1140	GF	61	No	N/A
	F 1	63	No	N/A
1141	GF	61	No	N/A
	F 1	63	No	N/A
1142	GF	61	No	N/A
	F 1	63	No	N/A
1143	GF	61	No	N/A
	F 1	63	No	N/A
1144	GF	61	No	N/A
	F 1	62	No	N/A
1145	GF	61	No	N/A
	F 1	62	No	N/A
1146	GF	61	No	N/A
	F 1	62	No	N/A
1147	GF	61	No	N/A
	F 1	62	No	N/A
1148	GF	61	No	N/A
	F 1	62	No	N/A
1149	GF	61	No	N/A
	F 1	62	No	N/A
1150	GF	61	No	N/A
	F 1	62	No	N/A
1151	GF	61	No	N/A
	F 1	62	No	N/A
1152	GF	61	No	N/A
	F 1	62	No	N/A
1153	GF	61	No	N/A
	F 1	62	No	N/A
1154	GF	61	No	N/A
	F 1	62	No	N/A

Lot	Floor	Predicted L10(18 hour) Noise Level (Facade Corrected)	Noise Affected?	Applicable Criteria
1155	GF	60	No	N/A
	F 1	62	No	N/A
1156	GF	60	No	N/A
	F 1	62	No	N/A
1157	GF	60	No	N/A
	F 1	62	No	N/A
1158	GF	60	No	N/A
	F 1	62	No	N/A
1159	GF	58	No	N/A
	F 1	60	No	N/A
1160	GF	58	No	N/A
	F 1	60	No	N/A
1161	GF	58	No	N/A
	F 1	60	No	N/A
1162	GF	59	No	N/A
	F 1	60	No	N/A
1163	GF	59	No	N/A
	F 1	60	No	N/A
1164	GF	59	No	N/A
	F 1	60	No	N/A
1165	GF	59	No	N/A
	F 1	61	No	N/A
1166	GF	59	No	N/A
	F 1	61	No	N/A
1167	GF	59	No	N/A
	F 1	61	No	N/A
1168	GF	59	No	N/A
	F 1	61	No	N/A
1169	GF	60	No	N/A
	F 1	61	No	N/A
1170	GF	60	No	N/A
	F 1	61	No	N/A
1171	GF	60	No	N/A
	F 1	62	No	N/A
1172	GF	60	No	N/A
	F 1	62	No	N/A
1173	GF	59	No	N/A
	F 1	61	No	N/A
1174	GF	59	No	N/A

Lot	Floor	Predicted L10(18 hour) Noise Level (Facade Corrected)	Noise Affected?	Applicable Criteria
1175	F 1	61	No	N/A
	GF	58	No	N/A
1176	F 1	60	No	N/A
	GF	58	No	N/A
1177	F 1	60	No	N/A
	GF	58	No	N/A
1178	F 1	59	No	N/A
	GF	58	No	N/A
1179	F 1	59	No	N/A
	GF	57	No	N/A
1180	F 1	59	No	N/A
	GF	57	No	N/A
1181	F 1	59	No	N/A
	GF	57	No	N/A
1182	F 1	59	No	N/A
	GF	57	No	N/A
1183	F 1	59	No	N/A
	GF	57	No	N/A
1184	F 1	58	No	N/A
	GF	57	No	N/A
1185	F 1	58	No	N/A
	GF	57	No	N/A
1186	F 1	58	No	N/A
	GF	56	No	N/A
1187	F 1	58	No	N/A
	GF	56	No	N/A
1188	F 1	57	No	N/A
	GF	55	No	N/A
1189	F 1	57	No	N/A
	GF	56	No	N/A
1190	F 1	57	No	N/A
	GF	55	No	N/A
1191	F 1	57	No	N/A
	GF	55	No	N/A
1192	F 1	56	No	N/A
	GF	55	No	N/A
1193	F 1	56	No	N/A
	GF	55	No	N/A

Lot	Floor	Predicted L10(18 hour) Noise Level (Facade Corrected)	Noise Affected?	Applicable Criteria
1194	GF	54	No	N/A
	F 1	56	No	N/A
1195	GF	56	No	N/A
	F 1	57	No	N/A
1196	GF	56	No	N/A
	F 1	57	No	N/A
1197	GF	56	No	N/A
	F 1	58	No	N/A
1198	GF	56	No	N/A
	F 1	58	No	N/A
1199	GF	56	No	N/A
	F 1	58	No	N/A
1200	GF	56	No	N/A
	F 1	58	No	N/A
1201	GF	57	No	N/A
	F 1	58	No	N/A
1202	GF	57	No	N/A
	F 1	59	No	N/A
1203	GF	57	No	N/A
	F 1	59	No	N/A
1204	GF	57	No	N/A
	F 1	59	No	N/A
1205	GF	58	No	N/A
	F 1	60	No	N/A
1206	GF	57	No	N/A
	F 1	60	No	N/A
1207	GF	57	No	N/A
	F 1	59	No	N/A
1208	GF	57	No	N/A
	F 1	58	No	N/A
1209	GF	56	No	N/A
	F 1	58	No	N/A
1210	GF	56	No	N/A
	F 1	58	No	N/A
1211	GF	56	No	N/A
	F 1	58	No	N/A
1212	GF	56	No	N/A
	F 1	57	No	N/A
1213	GF	56	No	N/A

Lot	Floor	Predicted L10(18 hour) Noise Level (Facade Corrected)	Noise Affected?	Applicable Criteria
1214	F 1	57	No	N/A
	GF	55	No	N/A
1215	F 1	57	No	N/A
	GF	55	No	N/A
1216	F 1	57	No	N/A
	GF	55	No	N/A
1217	F 1	56	No	N/A
	GF	55	No	N/A
1218	F 1	55	No	N/A
	GF	54	No	N/A
1219	F 1	55	No	N/A
	GF	54	No	N/A
1220	F 1	55	No	N/A
	GF	53	No	N/A
1221	F 1	55	No	N/A
	GF	53	No	N/A
1222	F 1	55	No	N/A
	GF	53	No	N/A
1223	F 1	54	No	N/A
	GF	53	No	N/A
1224	F 1	54	No	N/A
	GF	53	No	N/A
1225	F 1	54	No	N/A
	GF	53	No	N/A
1226	F 1	54	No	N/A
	GF	53	No	N/A
1227	F 1	54	No	N/A
	GF	53	No	N/A
1228	F 1	55	No	N/A
	GF	53	No	N/A
1229	F 1	55	No	N/A
	GF	53	No	N/A
1230	F 1	55	No	N/A
	GF	54	No	N/A
1231	F 1	55	No	N/A
	GF	54	No	N/A
1232	F 1	56	No	N/A
	GF	54	No	N/A

Lot	Floor	Predicted L10(18 hour) Noise Level (Facade Corrected)	Noise Affected?	Applicable Criteria
1233	GF	54	No	N/A
	F 1	56	No	N/A
1234	GF	55	No	N/A
	F 1	57	No	N/A
1235	GF	55	No	N/A
	F 1	57	No	N/A
1236	GF	56	No	N/A
	F 1	57	No	N/A
1237	GF	56	No	N/A
	F 1	58	No	N/A
1238	GF	56	No	N/A
	F 1	58	No	N/A
1239	GF	56	No	N/A
	F 1	58	No	N/A
1240	GF	57	No	N/A
	F 1	58	No	N/A
1241	GF	57	No	N/A
	F 1	59	No	N/A
1242	GF	57	No	N/A
	F 1	60	No	N/A
1243	GF	57	No	N/A
	F 1	60	No	N/A
1244	GF	57	No	N/A
	F 1	59	No	N/A
1245	GF	56	No	N/A
	F 1	58	No	N/A
1246	GF	56	No	N/A
	F 1	58	No	N/A
1247	GF	56	No	N/A
	F 1	57	No	N/A
1248	GF	55	No	N/A
	F 1	57	No	N/A
1249	GF	55	No	N/A
	F 1	57	No	N/A
1250	GF	55	No	N/A
	F 1	56	No	N/A
1251	GF	55	No	N/A
	F 1	56	No	N/A
1252	GF	54	No	N/A

Lot	Floor	Predicted L10(18 hour) Noise Level (Facade Corrected)	Noise Affected?	Applicable Criteria
1253	F 1	56	No	N/A
	GF	54	No	N/A
1254	F 1	55	No	N/A
	GF	54	No	N/A
1255	F 1	56	No	N/A
	GF	54	No	N/A
1256	F 1	56	No	N/A
	GF	55	No	N/A
1257	F 1	56	No	N/A
	GF	55	No	N/A
1258	F 1	57	No	N/A
	GF	55	No	N/A
1259	F 1	57	No	N/A
	GF	55	No	N/A
1260	F 1	57	No	N/A
	GF	56	No	N/A
1261	F 1	58	No	N/A
	GF	56	No	N/A
1262	F 1	58	No	N/A
	GF	56	No	N/A
1263	F 1	59	No	N/A
	GF	57	No	N/A
1264	F 1	60	No	N/A
	GF	57	No	N/A
1265	F 1	55	No	N/A
	GF	53	No	N/A
1266	F 1	55	No	N/A
	GF	54	No	N/A
1267	F 1	55	No	N/A
	GF	54	No	N/A
1268	F 1	55	No	N/A
	GF	54	No	N/A
1269	F 1	55	No	N/A
	GF	54	No	N/A
1270	F 1	56	No	N/A
	GF	54	No	N/A
1271	F 1	56	No	N/A
	GF	55	No	N/A

Lot	Floor	Predicted L10(18 hour) Noise Level (Facade Corrected)	Noise Affected?	Applicable Criteria
1272	GF	55	No	N/A
	F 1	56	No	N/A
1273	GF	55	No	N/A
	F 1	57	No	N/A
1274	GF	55	No	N/A
	F 1	57	No	N/A
1275	GF	56	No	N/A
	F 1	58	No	N/A
1276	GF	56	No	N/A
	F 1	59	No	N/A
1277	GF	57	No	N/A
	F 1	59	No	N/A
1278	GF	58	No	N/A
	F 1	61	No	N/A
1279	GF	60	No	N/A
	F 1	68	Yes	SCRC-AS2107
1280	GF	61	No	N/A
	F 1	70	Yes	SCRC-AS2107
1281	GF	61	No	N/A
	F 1	70	Yes	SCRC-AS2107
1282	GF	61	No	N/A
	F 1	70	Yes	SCRC-AS2107
1283	GF	61	No	N/A
	F 1	70	Yes	SCRC-AS2107
1284	GF	61	No	N/A
	F 1	70	Yes	SCRC-AS2107
1285	GF	61	No	N/A
	F 1	70	Yes	SCRC-AS2107
1286	GF	61	No	N/A
	F 1	70	Yes	SCRC-AS2107
1287	GF	61	No	N/A
	F 1	69	Yes	SCRC-AS2107
1288	GF	61	No	N/A
	F 1	69	Yes	SCRC-AS2107
1289	GF	61	No	N/A
	F 1	69	Yes	SCRC-AS2107
1290	GF	61	No	N/A
	F 1	70	Yes	SCRC-AS2107
1291	GF	57	No	N/A

Lot	Floor	Predicted L10(18 hour) Noise Level (Facade Corrected)	Noise Affected?	Applicable Criteria
	F 1	59	No	N/A
1292	GF	57	No	N/A
	F 1	59	No	N/A
1293	GF	56	No	N/A
	F 1	58	No	N/A
1294	GF	56	No	N/A
	F 1	58	No	N/A
1295	GF	55	No	N/A
	F 1	57	No	N/A
1296	GF	55	No	N/A
	F 1	57	No	N/A
1297	GF	55	No	N/A
	F 1	56	No	N/A
1298	GF	55	No	N/A
	F 1	56	No	N/A
1299	GF	54	No	N/A
	F 1	56	No	N/A
1300	GF	54	No	N/A
	F 1	55	No	N/A
1301	GF	54	No	N/A
	F 1	55	No	N/A
1302	GF	53	No	N/A
	F 1	55	No	N/A
1303	GF	53	No	N/A
	F 1	54	No	N/A
1304	GF	53	No	N/A
	F 1	54	No	N/A
1305	GF	53	No	N/A
	F 1	54	No	N/A
1306	GF	53	No	N/A
	F 1	54	No	N/A
1307	GF	53	No	N/A
	F 1	54	No	N/A
1308	GF	53	No	N/A
	F 1	54	No	N/A
1309	GF	53	No	N/A
	F 1	54	No	N/A
1310	GF	54	No	N/A
	F 1	55	No	N/A

Lot	Floor	Predicted L10(18 hour) Noise Level (Facade Corrected)	Noise Affected?	Applicable Criteria
1311	GF	54	No	N/A
	F 1	55	No	N/A
1312	GF	54	No	N/A
	F 1	56	No	N/A
1313	GF	55	No	N/A
	F 1	56	No	N/A
1314	GF	55	No	N/A
	F 1	56	No	N/A
1315	GF	55	No	N/A
	F 1	57	No	N/A
1316	GF	56	No	N/A
	F 1	57	No	N/A
1317	GF	56	No	N/A
	F 1	58	No	N/A
1318	GF	56	No	N/A
	F 1	58	No	N/A
1319	GF	57	No	N/A
	F 1	59	No	N/A
1320	GF	57	No	N/A
	F 1	60	No	N/A
1321	GF	60	No	N/A
	F 1	66	Yes	SCRC-AS2107
1322	GF	61	No	N/A
	F 1	69	Yes	SCRC-AS2107
1323	GF	61	No	N/A
	F 1	69	Yes	SCRC-AS2107
1324	GF	61	No	N/A
	F 1	69	Yes	SCRC-AS2107
1325	GF	61	No	N/A
	F 1	69	Yes	SCRC-AS2107
1326	GF	61	No	N/A
	F 1	69	Yes	SCRC-AS2107
1327	GF	61	No	N/A
	F 1	69	Yes	SCRC-AS2107
1328	GF	61	No	N/A
	F 1	70	Yes	SCRC-AS2107
1329	GF	62	No	N/A
	F 1	70	Yes	SCRC-AS2107
1330	GF	62	No	N/A

Lot	Floor	Predicted L10(18 hour) Noise Level (Facade Corrected)	Noise Affected?	Applicable Criteria
1331	F 1	70	Yes	SCRC-AS2107
	GF	62	No	N/A
1332	F 1	70	Yes	SCRC-AS2107
	GF	61	No	N/A
1333	F 1	69	Yes	SCRC-AS2107
	GF	61	No	N/A
1334	F 1	69	Yes	SCRC-AS2107
	GF	61	No	N/A
1335	F 1	70	Yes	SCRC-AS2107
	GF	62	No	N/A
1336	F 1	70	Yes	SCRC-AS2107
	GF	62	No	N/A
1337	F 1	69	Yes	SCRC-AS2107
	GF	62	No	N/A
1338	F 1	69	Yes	SCRC-AS2107
	GF	62	No	N/A
1339	F 1	70	Yes	SCRC-AS2107
	GF	62	No	N/A
1340	F 1	69	Yes	SCRC-AS2107
	GF	63	No	N/A
1341	F 1	70	Yes	SCRC-AS2107
	GF	62	No	N/A
1342	F 1	61	No	N/A
	GF	59	No	N/A
1343	F 1	60	No	N/A
	GF	58	No	N/A
1344	F 1	59	No	N/A
	GF	57	No	N/A
1345	F 1	58	No	N/A
	GF	57	No	N/A
1346	F 1	58	No	N/A
	GF	56	No	N/A
1347	F 1	57	No	N/A
	GF	55	No	N/A
1348	F 1	57	No	N/A
	GF	55	No	N/A
1349	F 1	57	No	N/A
	GF	55	No	N/A

Lot	Floor	Predicted L10(18 hour) Noise Level (Facade Corrected)	Noise Affected?	Applicable Criteria
1350	GF	55	No	N/A
	F 1	57	No	N/A
1351	GF	55	No	N/A
	F 1	57	No	N/A
1352	GF	55	No	N/A
	F 1	57	No	N/A
1353	GF	55	No	N/A
	F 1	57	No	N/A
1354	GF	55	No	N/A
	F 1	57	No	N/A
1355	GF	55	No	N/A
	F 1	57	No	N/A
1356	GF	55	No	N/A
	F 1	57	No	N/A
1357	GF	55	No	N/A
	F 1	57	No	N/A
1358	GF	55	No	N/A
	F 1	57	No	N/A
1359	GF	56	No	N/A
	F 1	57	No	N/A
1360	GF	56	No	N/A
	F 1	57	No	N/A
1361	GF	56	No	N/A
	F 1	58	No	N/A
1362	GF	56	No	N/A
	F 1	58	No	N/A
1363	GF	57	No	N/A
	F 1	59	No	N/A
1364	GF	58	No	N/A
	F 1	60	No	N/A
1365	GF	59	No	N/A
	F 1	60	No	N/A
1366	GF	59	No	N/A
	F 1	61	No	N/A
1367	GF	60	No	N/A
	F 1	62	No	N/A
1368	GF	61	No	N/A
	F 1	64	Yes	SCRC-AS2107
1369	GF	63	No	N/A

Lot	Floor	Predicted L10(18 hour) Noise Level (Facade Corrected)	Noise Affected?	Applicable Criteria
1370	F 1	71	Yes	SCRC-AS2107
	GF	62	No	N/A
1371	F 1	71	Yes	SCRC-AS2107
	GF	61	No	N/A
1372	F 1	64	Yes	SCRC-AS2107
	GF	60	No	N/A
1373	F 1	62	No	N/A
	GF	59	No	N/A
1374	F 1	61	No	N/A
	GF	58	No	N/A
1375	F 1	60	No	N/A
	GF	57	No	N/A
1376	F 1	59	No	N/A
	GF	57	No	N/A
1377	F 1	58	No	N/A
	GF	56	No	N/A
1378	F 1	58	No	N/A
	GF	62	No	N/A
1379	F 1	70	Yes	SCRC-AS2107
	GF	61	No	N/A
1380	F 1	63	No	N/A
	GF	60	No	N/A
1381	F 1	62	No	N/A
	GF	59	No	N/A
1382	F 1	61	No	N/A
	GF	63	No	N/A
1383	F 1	70	Yes	SCRC-AS2107
	GF	61	No	N/A
1384	F 1	64	Yes	SCRC-AS2107
	GF	60	No	N/A
1385	F 1	62	No	N/A
	GF	59	No	N/A
1386	F 1	61	No	N/A
	GF	57	No	N/A
1387	F 1	59	No	N/A
	GF	57	No	N/A
1388	F 1	58	No	N/A
	GF	57	No	N/A

Lot	Floor	Predicted L10(18 hour) Noise Level (Facade Corrected)	Noise Affected?	Applicable Criteria
1389	GF	56	No	N/A
	F 1	58	No	N/A
1390	GF	56	No	N/A
	F 1	58	No	N/A
1391	GF	56	No	N/A
	F 1	57	No	N/A
1392	GF	55	No	N/A
	F 1	57	No	N/A
1393	GF	55	No	N/A
	F 1	57	No	N/A
1394	GF	55	No	N/A
	F 1	57	No	N/A
1395	GF	55	No	N/A
	F 1	57	No	N/A
1396	GF	55	No	N/A
	F 1	57	No	N/A
1397	GF	56	No	N/A
	F 1	57	No	N/A
1398	GF	56	No	N/A
	F 1	58	No	N/A
1399	GF	57	No	N/A
	F 1	58	No	N/A
1400	GF	57	No	N/A
	F 1	59	No	N/A
1401	GF	57	No	N/A
	F 1	59	No	N/A
1402	GF	65	Yes	SCRC-AS2107
	F 1	67	Yes	SCRC-AS2107
1403	GF	65	Yes	SCRC-AS2107
	F 1	67	Yes	SCRC-AS2107
1404	GF	65	Yes	SCRC-AS2107
	F 1	67	Yes	SCRC-AS2107
1405	GF	65	Yes	SCRC-AS2107
	F 1	67	Yes	SCRC-AS2107
1406	GF	65	Yes	SCRC-AS2107
	F 1	67	Yes	SCRC-AS2107
1407	GF	65	Yes	SCRC-AS2107
	F 1	67	Yes	SCRC-AS2107
1408	GF	65	Yes	SCRC-AS2107

Lot	Floor	Predicted L10(18 hour) Noise Level (Facade Corrected)	Noise Affected?	Applicable Criteria
1409	F 1	67	Yes	SCRC-AS2107
	GF	65	Yes	SCRC-AS2107
	F 1	67	Yes	SCRC-AS2107
1410	GF	65	Yes	SCRC-AS2107
	F 1	67	Yes	SCRC-AS2107
1411	GF	66	Yes	SCRC-AS2107
	F 1	67	Yes	SCRC-AS2107
1412	GF	66	Yes	SCRC-AS2107
	F 1	67	Yes	SCRC-AS2107
1413	GF	66	Yes	SCRC-AS2107
	F 1	67	Yes	SCRC-AS2107
1414	GF	66	Yes	SCRC-AS2107
	F 1	67	Yes	SCRC-AS2107
1415	GF	66	Yes	SCRC-AS2107
	F 1	67	Yes	SCRC-AS2107
1416	GF	60	No	N/A
	F 1	62	No	N/A
1417	GF	60	No	N/A
	F 1	62	No	N/A
1418	GF	60	No	N/A
	F 1	62	No	N/A
1419	GF	60	No	N/A
	F 1	62	No	N/A
1420	GF	60	No	N/A
	F 1	62	No	N/A
1421	GF	60	No	N/A
	F 1	62	No	N/A
1422	GF	60	No	N/A
	F 1	62	No	N/A
1423	GF	60	No	N/A
	F 1	62	No	N/A
1424	GF	60	No	N/A
	F 1	61	No	N/A
1425	GF	59	No	N/A
	F 1	61	No	N/A
1426	GF	59	No	N/A
	F 1	61	No	N/A
1427	GF	59	No	N/A
	F 1	61	No	N/A

Lot	Floor	Predicted L10(18 hour) Noise Level (Facade Corrected)	Noise Affected?	Applicable Criteria
1428	GF	59	No	N/A
	F 1	61	No	N/A
1429	GF	60	No	N/A
	F 1	62	No	N/A
1430	GF	58	No	N/A
	F 1	59	No	N/A
1431	GF	58	No	N/A
	F 1	60	No	N/A
1432	GF	58	No	N/A
	F 1	60	No	N/A
1433	GF	58	No	N/A
	F 1	60	No	N/A
1434	GF	57	No	N/A
	F 1	59	No	N/A
1435	GF	57	No	N/A
	F 1	58	No	N/A
1436	GF	56	No	N/A
	F 1	58	No	N/A
1437	GF	56	No	N/A
	F 1	58	No	N/A
1438	GF	56	No	N/A
	F 1	58	No	N/A
1439	GF	55	No	N/A
	F 1	57	No	N/A
1440	GF	55	No	N/A
	F 1	57	No	N/A
1441	GF	55	No	N/A
	F 1	57	No	N/A
1442	GF	55	No	N/A
	F 1	57	No	N/A
1443	GF	55	No	N/A
	F 1	57	No	N/A
1444	GF	54	No	N/A
	F 1	56	No	N/A
1445	GF	55	No	N/A
	F 1	56	No	N/A
1446	GF	55	No	N/A
	F 1	57	No	N/A
1447	GF	55	No	N/A

Lot	Floor	Predicted L10(18 hour) Noise Level (Facade Corrected)	Noise Affected?	Applicable Criteria
1448	F 1	57	No	N/A
	GF	55	No	N/A
1449	F 1	57	No	N/A
	GF	55	No	N/A
1450	F 1	57	No	N/A
	GF	55	No	N/A
1451	F 1	57	No	N/A
	GF	55	No	N/A
1452	F 1	57	No	N/A
	GF	55	No	N/A
1453	F 1	57	No	N/A
	GF	55	No	N/A
1454	F 1	57	No	N/A
	GF	55	No	N/A
1455	F 1	58	No	N/A
	GF	56	No	N/A
1456	F 1	58	No	N/A
	GF	56	No	N/A
1457	F 1	58	No	N/A
	GF	56	No	N/A
1458	F 1	59	No	N/A
	GF	57	No	N/A
1459	F 1	59	No	N/A
	GF	57	No	N/A
1460	F 1	60	No	N/A
	GF	58	No	N/A
1461	F 1	60	No	N/A
	GF	59	No	N/A
1462	F 1	61	No	N/A
	GF	59	No	N/A
1463	F 1	61	No	N/A
	GF	59	No	N/A
1464	F 1	60	No	N/A
	GF	58	No	N/A
1465	F 1	59	No	N/A
	GF	57	No	N/A
1466	F 1	59	No	N/A
	GF	57	No	N/A

Lot	Floor	Predicted L10(18 hour) Noise Level (Facade Corrected)	Noise Affected?	Applicable Criteria
1467	GF	57	No	N/A
	F 1	59	No	N/A
1468	GF	56	No	N/A
	F 1	58	No	N/A
1469	GF	56	No	N/A
	F 1	58	No	N/A
1470	GF	56	No	N/A
	F 1	58	No	N/A
1471	GF	56	No	N/A
	F 1	58	No	N/A
1472	GF	56	No	N/A
	F 1	58	No	N/A
1473	GF	56	No	N/A
	F 1	58	No	N/A
1474	GF	56	No	N/A
	F 1	58	No	N/A
1475	GF	56	No	N/A
	F 1	58	No	N/A
1476	GF	56	No	N/A
	F 1	58	No	N/A
1477	GF	56	No	N/A
	F 1	58	No	N/A
1478	GF	56	No	N/A
	F 1	59	No	N/A
1479	GF	56	No	N/A
	F 1	59	No	N/A
1480	GF	56	No	N/A
	F 1	59	No	N/A
1481	GF	56	No	N/A
	F 1	59	No	N/A
1482	GF	57	No	N/A
	F 1	59	No	N/A
1483	GF	57	No	N/A
	F 1	59	No	N/A
1484	GF	57	No	N/A
	F 1	59	No	N/A
1485	GF	57	No	N/A
	F 1	60	No	N/A
1486	GF	58	No	N/A

Lot	Floor	Predicted L10(18 hour) Noise Level (Facade Corrected)	Noise Affected?	Applicable Criteria
1487	F 1	60	No	N/A
	GF	58	No	N/A
1488	F 1	60	No	N/A
	GF	58	No	N/A
1489	F 1	61	No	N/A
	GF	59	No	N/A
1490	F 1	66	Yes	SCRC-AS2107
	GF	62	No	N/A
1491	F 1	66	Yes	SCRC-AS2107
	GF	61	No	N/A
1492	F 1	66	Yes	SCRC-AS2107
	GF	61	No	N/A
1493	F 1	66	Yes	SCRC-AS2107
	GF	61	No	N/A
1494	F 1	66	Yes	SCRC-AS2107
	GF	61	No	N/A
1495	F 1	66	Yes	SCRC-AS2107
	GF	61	No	N/A
1496	F 1	66	Yes	SCRC-AS2107
	GF	61	No	N/A
1497	F 1	66	Yes	SCRC-AS2107
	GF	61	No	N/A
1498	F 1	66	Yes	SCRC-AS2107
	GF	60	No	N/A
1499	F 1	66	Yes	SCRC-AS2107
	GF	60	No	N/A
1500	F 1	65	Yes	SCRC-AS2107
	GF	60	No	N/A
1501	F 1	66	Yes	SCRC-AS2107
	GF	60	No	N/A
1502	F 1	65	Yes	SCRC-AS2107
	GF	60	No	N/A
1503	F 1	65	Yes	SCRC-AS2107
	GF	60	No	N/A
1504	F 1	65	Yes	SCRC-AS2107
	GF	60	No	N/A
1505	F 1	65	Yes	SCRC-AS2107
	GF	60	No	N/A

Lot	Floor	Predicted L10(18 hour) Noise Level (Facade Corrected)	Noise Affected?	Applicable Criteria
1506	GF	60	No	N/A
	F 1	65	Yes	SCRC-AS2107
1507	GF	60	No	N/A
	F 1	66	Yes	SCRC-AS2107
1508	GF	56	No	N/A
	F 1	58	No	N/A
1509	GF	56	No	N/A
	F 1	58	No	N/A
1510	GF	56	No	N/A
	F 1	58	No	N/A
1511	GF	56	No	N/A
	F 1	57	No	N/A
1512	GF	56	No	N/A
	F 1	57	No	N/A
1513	GF	56	No	N/A
	F 1	57	No	N/A
1514	GF	55	No	N/A
	F 1	57	No	N/A
1515	GF	55	No	N/A
	F 1	57	No	N/A
1516	GF	55	No	N/A
	F 1	57	No	N/A
1517	GF	55	No	N/A
	F 1	57	No	N/A
1518	GF	55	No	N/A
	F 1	57	No	N/A
1519	GF	55	No	N/A
	F 1	56	No	N/A
1520	GF	55	No	N/A
	F 1	56	No	N/A
1521	GF	55	No	N/A
	F 1	56	No	N/A
1522	GF	54	No	N/A
	F 1	56	No	N/A
1523	GF	54	No	N/A
	F 1	56	No	N/A
1524	GF	54	No	N/A
	F 1	56	No	N/A
1525	GF	54	No	N/A

Lot	Floor	Predicted L10(18 hour) Noise Level (Facade Corrected)	Noise Affected?	Applicable Criteria
1526	F 1	56	No	N/A
	GF	54	No	N/A
1527	F 1	56	No	N/A
	GF	54	No	N/A
1528	F 1	56	No	N/A
	GF	54	No	N/A
1529	F 1	56	No	N/A
	GF	54	No	N/A
1530	F 1	56	No	N/A
	GF	55	No	N/A
1531	F 1	56	No	N/A
	GF	55	No	N/A
1532	F 1	56	No	N/A
	GF	55	No	N/A
1533	F 1	56	No	N/A
	GF	55	No	N/A
1534	F 1	57	No	N/A
	GF	55	No	N/A
1535	F 1	57	No	N/A
	GF	55	No	N/A
1536	F 1	57	No	N/A
	GF	55	No	N/A
1537	F 1	57	No	N/A
	GF	55	No	N/A
1538	F 1	57	No	N/A
	GF	55	No	N/A
1539	F 1	57	No	N/A
	GF	56	No	N/A
1540	F 1	57	No	N/A
	GF	56	No	N/A
1541	F 1	57	No	N/A
	GF	56	No	N/A
1542	F 1	58	No	N/A
	GF	56	No	N/A
1543	F 1	58	No	N/A
	GF	56	No	N/A
1544	F 1	58	No	N/A
	GF	56	No	N/A

Lot	Floor	Predicted L10(18 hour) Noise Level (Facade Corrected)	Noise Affected?	Applicable Criteria
1545	GF	54	No	N/A
	F 1	55	No	N/A
1546	GF	54	No	N/A
	F 1	55	No	N/A
1547	GF	54	No	N/A
	F 1	55	No	N/A
1548	GF	54	No	N/A
	F 1	55	No	N/A
1549	GF	54	No	N/A
	F 1	55	No	N/A
1550	GF	54	No	N/A
	F 1	56	No	N/A
1551	GF	54	No	N/A
	F 1	56	No	N/A
1552	GF	54	No	N/A
	F 1	56	No	N/A
1553	GF	54	No	N/A
	F 1	56	No	N/A
1554	GF	54	No	N/A
	F 1	56	No	N/A
1555	GF	55	No	N/A
	F 1	57	No	N/A
1556	GF	54	No	N/A
	F 1	56	No	N/A
1557	GF	54	No	N/A
	F 1	56	No	N/A
1558	GF	54	No	N/A
	F 1	56	No	N/A
1559	GF	54	No	N/A
	F 1	55	No	N/A
1560	GF	53	No	N/A
	F 1	55	No	N/A
1561	GF	53	No	N/A
	F 1	55	No	N/A
1562	GF	53	No	N/A
	F 1	55	No	N/A
1563	GF	53	No	N/A
	F 1	55	No	N/A
1564	GF	53	No	N/A

Lot	Floor	Predicted L10(18 hour) Noise Level (Facade Corrected)	Noise Affected?	Applicable Criteria
1565	F 1	55	No	N/A
	GF	53	No	N/A
1566	F 1	55	No	N/A
	GF	53	No	N/A
1567	F 1	55	No	N/A
	GF	53	No	N/A
1568	F 1	55	No	N/A
	GF	54	No	N/A
1569	F 1	54	No	N/A
	GF	53	No	N/A
1570	F 1	55	No	N/A
	GF	53	No	N/A
1571	F 1	55	No	N/A
	GF	53	No	N/A
1572	F 1	55	No	N/A
	GF	53	No	N/A
1573	F 1	55	No	N/A
	GF	53	No	N/A
1574	F 1	55	No	N/A
	GF	53	No	N/A
1575	F 1	55	No	N/A
	GF	53	No	N/A
1576	F 1	55	No	N/A
	GF	53	No	N/A
1577	F 1	55	No	N/A
	GF	53	No	N/A
1578	F 1	55	No	N/A
	GF	53	No	N/A
1579	F 1	55	No	N/A
	GF	53	No	N/A
1580	F 1	55	No	N/A
	GF	53	No	N/A
1581	F 1	55	No	N/A
	GF	53	No	N/A
1582	F 1	55	No	N/A
	GF	53	No	N/A
1583	F 1	55	No	N/A
	GF	53	No	N/A

Lot	Floor	Predicted L10(18 hour) Noise Level (Facade Corrected)	Noise Affected?	Applicable Criteria
1584	GF	53	No	N/A
	F 1	55	No	N/A
1585	GF	53	No	N/A
	F 1	55	No	N/A
1586	GF	53	No	N/A
	F 1	54	No	N/A
1587	GF	53	No	N/A
	F 1	54	No	N/A
1588	GF	53	No	N/A
	F 1	54	No	N/A
1589	GF	53	No	N/A
	F 1	54	No	N/A
1590	GF	52	No	N/A
	F 1	54	No	N/A
1591	GF	52	No	N/A
	F 1	54	No	N/A
1592	GF	52	No	N/A
	F 1	54	No	N/A
1593	GF	53	No	N/A
	F 1	54	No	N/A
1594	GF	53	No	N/A
	F 1	54	No	N/A
1595	GF	53	No	N/A
	F 1	54	No	N/A
1596	GF	53	No	N/A
	F 1	54	No	N/A
1597	GF	53	No	N/A
	F 1	55	No	N/A
1598	GF	53	No	N/A
	F 1	55	No	N/A